

Jukes & Co

Estate Agents



Denmark Road

, London, SE25 5QU

£350,000



A fantastic opportunity to acquire this two-bedroom Victorian home, ideally situated in the highly sought-after area of South Norwood. Offering two spacious reception rooms and plenty of character, the property is in need of modernisation, making it an excellent prospect for buyers looking to add value and create their ideal home.

The location is a real highlight, with excellent local amenities on the doorstep, including the popular yoga studio nearby, the beautiful South Norwood Lake and Grounds just a short walk away, and the expansive South Norwood Country Park only minutes from the property. The local leisure centre provides excellent fitness and recreational facilities, while superb transport links offer journeys to London Bridge station in approximately 12 minutes, making this an ideal choice for commuters.

Combining location, potential and connectivity, this property represents an excellent purchase in one of South Norwood's most convenient and desirable settings.



Area Map

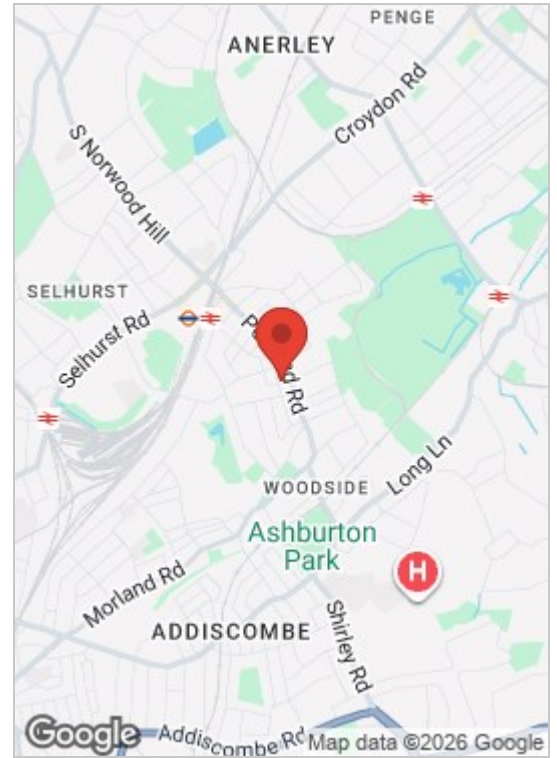

Floor Plan

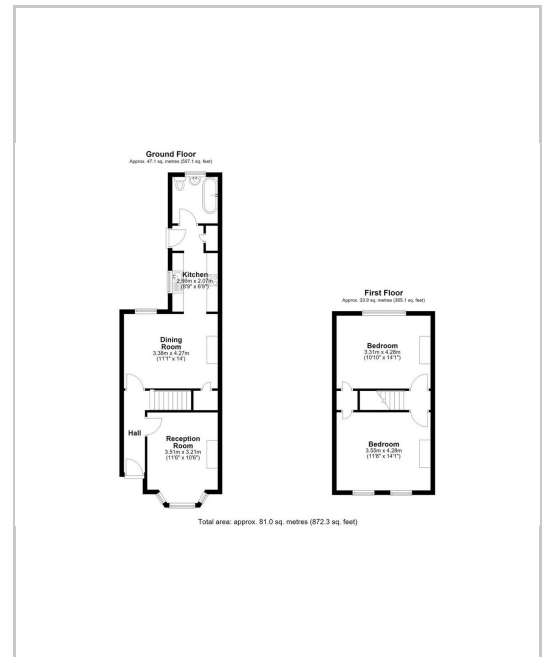

Energy Efficiency Graph

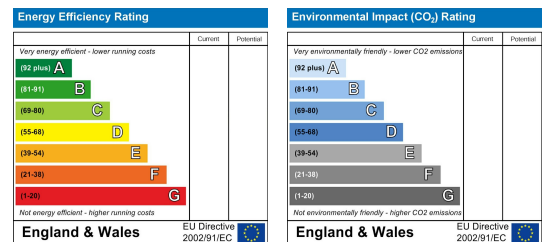

These particulars, whilst believed to be accurate are set out as a general outline only for guidance and do not constitute any part of an offer or contract. Intending purchasers should not rely on them as statements of representation of fact, but must satisfy themselves by inspection or otherwise as to their accuracy. No person in this firm's employment has the authority to make or give any representation or warranty in respect of the property.

Sales and Lettings

76 High Street, South Norwood, London SE25 6EB

T: 020 8653 9393 · F: 020 8771 5551 · E: sales@jukesestateagents.com · E: lettings@jukesestateagents.com

W: jukesestateagents.com