



**HEARNES**

WHERE SERVICE COUNTS

**Bearwood  
Bournemouth, Dorset, BH11 9TY**

# Bearwood, Bournemouth, BH11 9TY

## FREEHOLD PRICE GUIDE: £425,000

An immaculately presented three double bedroom detached bungalow offering 1,225 sq ft of accommodation including an Orangery style conservatory, garage and off-road parking for two cars and a camper van set in a cul de sac location within easy reach of local amenities. NO FORWARD CHAIN.

- Generous entrance hall with loft access and storage cupboard
- Recently refurbished kitchen with a range of navy units and complementary quartz worktops, integrated full length fridge, twin Siemen ovens, integrated Siemen dishwasher, pan drawers, corner carousel unit and Amtico flooring
- Generous size sitting room/diner with triple aspect and further two windows offering plenty of light, feature fireplace and service hatch to kitchen
- Orangery style conservatory with double glazed French doors opening onto the patio and a pitched glazed rooflight window and electric under floor heating
- Refurbished bathroom with shower cubicle, bath, wash hand basin set in a navy vanity unit and WC set into a range of navy fitted furniture with storage cupboard and Karndeian flooring
- Refurbished cloakroom with wash hand basin and WC set into a range of furniture with a quartz worktop, inset sink and plumbing for washing machine and tumble dryer
- Three double bedrooms all with fitted wardrobes
- Landscaped rear garden with a large range of mature trees and shrubs, two patio areas ideal for al fresco dining

Crusader Road is a cul de sac location situated in Bearwood with local amenities including community centre, Co-op stores and pharmacy and wonderful retail park close by on Ringwood Road. The town of Bournemouth with its award-winning sandy beaches and Bournemouth International Airport are both approximately six miles away.

COUNCIL TAX BAND: E EPC RATING: D

AGENTS NOTES: The heating system, mains and appliances have not been tested by Hearn's Estate Agents. Any areas, measurements or distances are approximate. The text, photographs and plans are for guidance only and are not necessarily comprehensive. Whilst reasonable endeavours have been made to ensure that the information in our sales particulars are as accurate as possible, this information has been provided for us by the seller and is not guaranteed. Any intending buyer should not rely on the information we have supplied and should satisfy themselves by inspection, searches, enquiries and survey as to the correctness of each statement before making a financial or legal commitment. We have not checked the legal documentation to verify the legal status, including the leased term and ground rent and escalation of ground rent of the property (where applicable). A buyer must not rely upon the information provided until it has been verified by their own solicitors.





# Ground Floor

Approx. 113.8 sq. metres (1225.4 sq. feet)

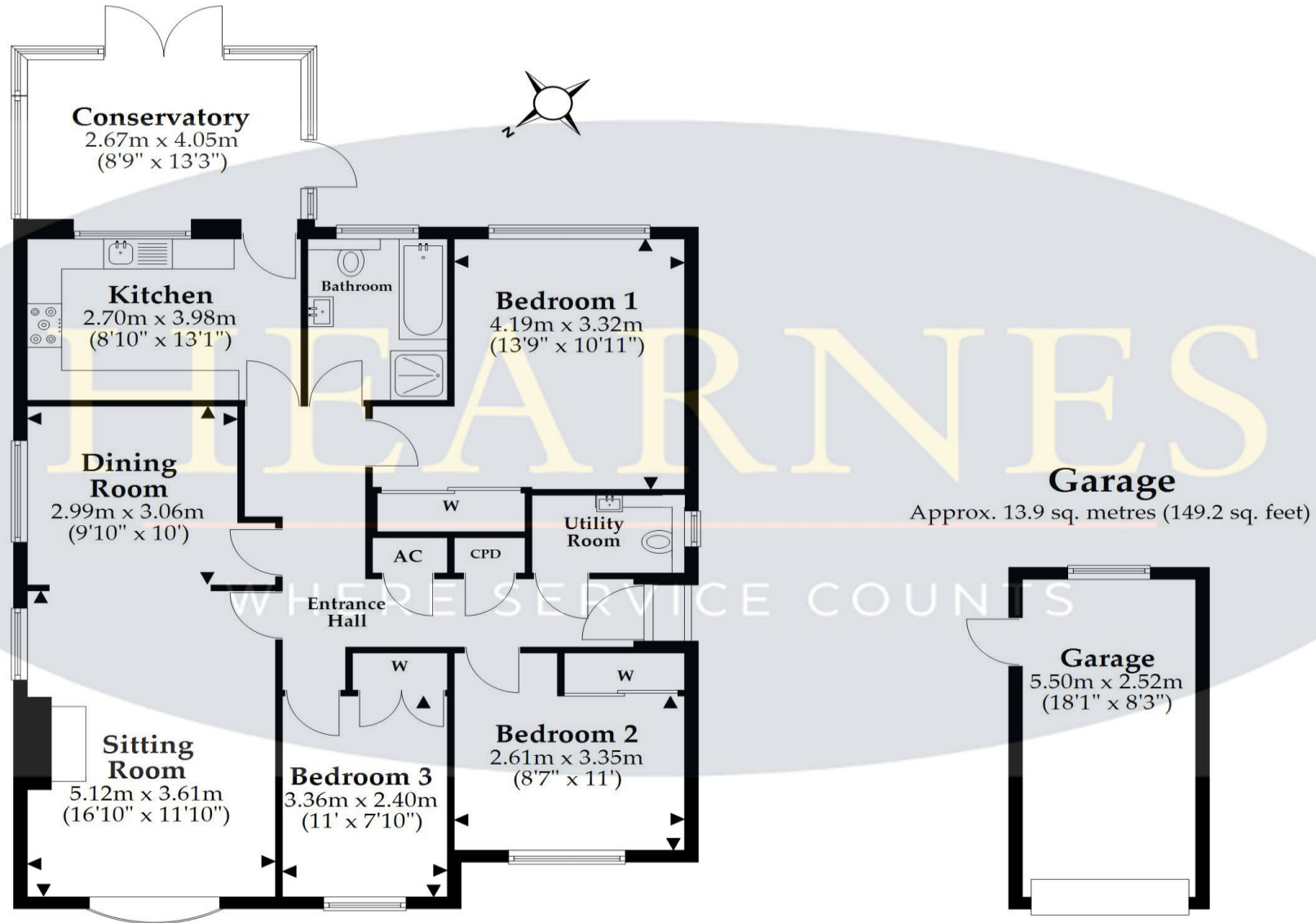

Total area: approx. 127.7 sq. metres (1374.5 sq. feet)

This plan is not to scale and is for general guidance only. LJT Surveying Ltd Ringwood







**HEARNES**

WHERE SERVICE COUNTS

[www.hearnes.com](http://www.hearnes.com)

6 Cook Row, Wimborne, Dorset BH21 1LB

Tel: 01202 842922 Email: [Wimborne@hearnes.com](mailto:Wimborne@hearnes.com)

OFFICES ALSO AT: BOURNEMOUTH, FERNDOWN, POOLE & RINGWOOD