



jordanfishwick

Tiverton Drive

£1,250 PCM



Tiverton Drive, Wilmslow, SK9 2TJ

£1,250 PCM

Well maintained two bedroom mews located on this popular estate close to local shops and within easy reach of A34 Wilmslow Town Centre, train station, Manchester International Airport and the motorway networks.

AVAILABLE EARLY AUGUST UNFURNISHED

Entrance porch, lounge through diner with patio doors to good sized enclosed rear garden, fitted kitchen with gas hob and electric oven, space for washing machine and fridge. To the first floor two good sized double bedrooms one with fitted storage and bathroom with shower over bath.

Off road parking for 2 cars - VIEWING RECOMMENDED

Contact Wilmslow 01625 536300 £1250.00pcm

COUNCIL TAX C

EPC C

LOCATION

Set behind Summerfields shops this small estate offers a range of modern and attractive accommodation for families and couples.

Jordan Fishwick Estate and Letting Agents Wilmslow office is located in a prime position central to the bustling and stylish town centre. With our impressive frontage it's impossible to miss our attractive office. Managed by Guy Grainger, Partner, who has been an Estate Agent since 1980, and has a wealth of local knowledge and experience

With busy sales and lettings departments all under the same roof along with our independent mortgage advisor on hand the Wilmslow branch has everything you need to help with your sales or lettings transactions.

Knowledgeable and friendly staff also compliment the range of services we offer and we are known throughout the Wilmslow area for our proactive approach in helping people find their dream home

DIRECTIONS

On the Summerfield's shops roundabout turn to go to the shops and continue past the entrance to the shopping centre car park. Take the next left turn onto Tiverton Drive and the property can be found on your right hand side.

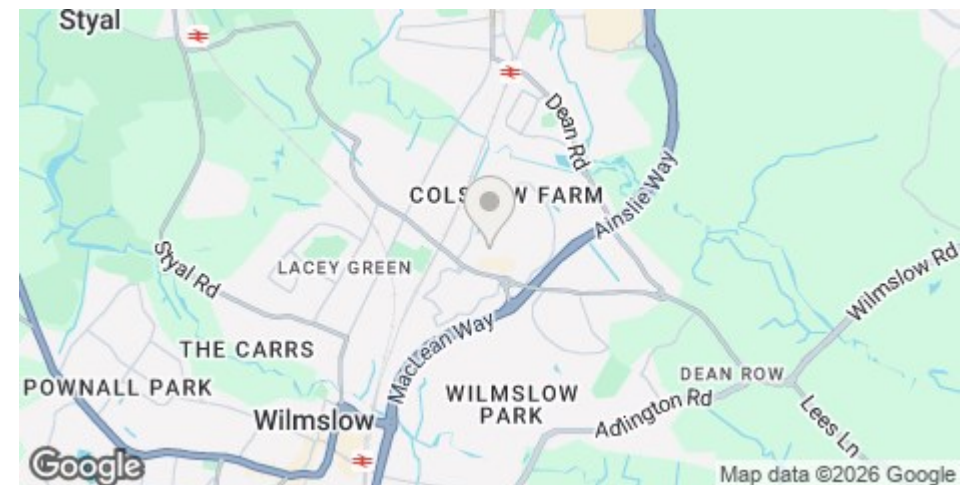

- MID MEWS
- POPULAR LOCATION
- TWO GOOD SIZED DOUBLE BEDROOMS
- ENCLOSED REAR GARDEN
- WALKING DISTANCE OF LOCAL SHOPS
- COUNCIL TAX C
- EPC C

Postcode - SK9 2TJ

EPC Rating - C

Floor Area - sq ft

Local Authority - Cheshire East Council

Council Tax - C



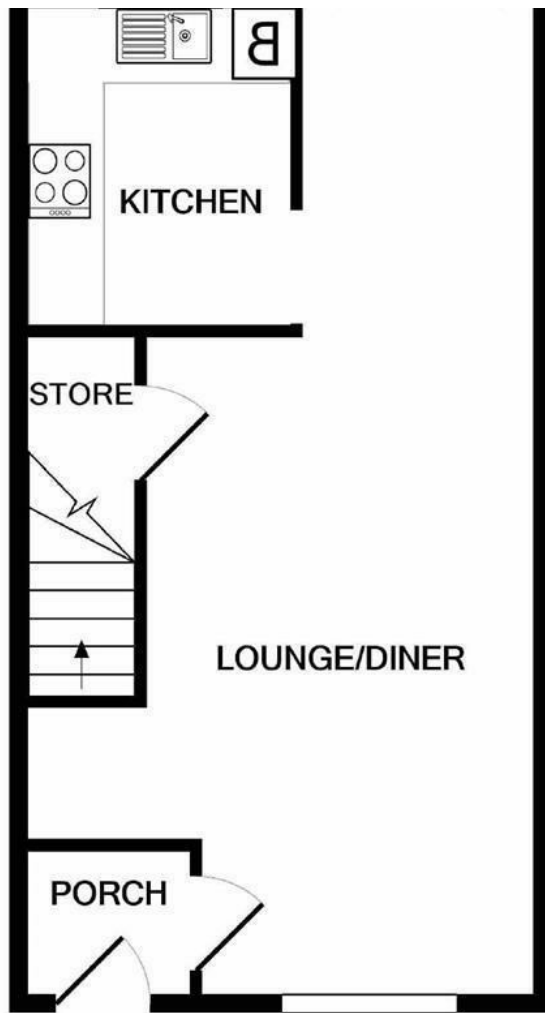

GROUND FLOOR

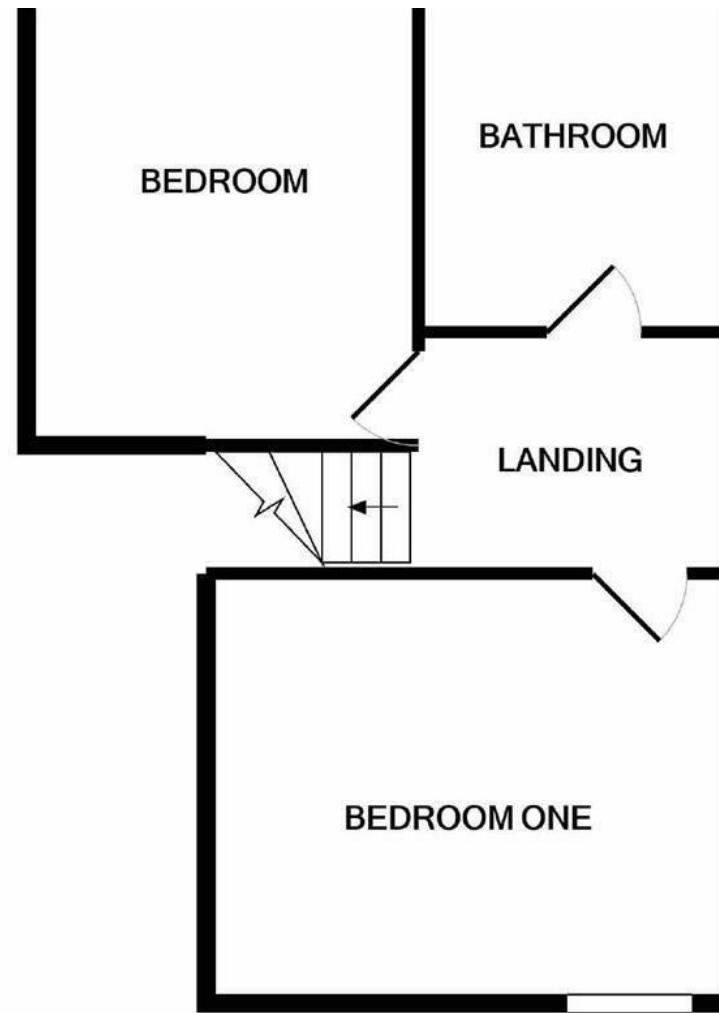

1ST FLOOR



These particulars are believed to be accurate but they are not guaranteed and do not form a contract. Neither Jordan Fishwick nor the vendor or lessor accept any responsibility in respect of these particulars, which are not intended to be statements or representations of fact and any intending purchaser or lessee must satisfy himself by inspection or otherwise as to the correctness of each of the statements contained in these particulars. Any floorplans on this brochure are for illustrative purposes only and are not necessarily to scale.

Offices at: Offices at Chorlton, Didsbury, Disley, Hale, Glossop, Macclesfield, Manchester Deansgate, Manchester Whitworth Street, New Mills, Sale, Wilmslow and Withington

01625 536300