

Uckfield 01825 703000
Crowborough 01892 489000
Heathfield 01435 511800

Peter Oliver



Duddleswell, Uckfield, TN22 3JN

- ▼ Character Semi-Detached Cottage
- ▼ 2 Double Bedrooms In Main House
- ▼ Stunning Central Fireplace
- ▼ Separate 1 Bedroom Annexe
- ▼ Double Garage, Workshop, Studio
- ▼ Gated Drive, Low-Maintenance Garden



EPC RATING

Current:

68 | D

Potential:

79 | C

Offers In Excess Of:
£850,000



Duddleswell, Uckfield, TN22 3JN

Nestled within the breathtaking surroundings of Ashdown Forest, this enchanting character cottage offers a rare opportunity to enjoy idyllic rural living with exceptional versatility. Surrounded by picturesque woodland and scenic walking routes, the setting is as captivating as the home itself. The property is complemented by an impressive range of substantial outbuildings, including a double garage with adjoining workshop or large store, a generous studio, and a beautifully appointed annexe with its own private, low-maintenance garden. The annexe is particularly striking, featuring vaulted ceilings and well-proportioned accommodation comprising a central reception room with a wood-burning stove, a double bedroom, a flexible kitchen/study area, and a contemporary shower room—perfect for multi-generational living or as an income-generating opportunity. The main residence exudes charm and character throughout, with exposed beams, stone walls, and original floorboards enhancing its warm and inviting atmosphere. An entrance hall with a convenient cloakroom leads into a spacious, modern kitchen/diner, thoughtfully designed with an extensive range of wall and base units, integrated appliances, and a large central island with solid wood worktops and breakfast seating. This stunning space flows seamlessly into the lounge, where both areas are centred around an impressive feature fireplace with a wood-burning stove, visible from three aspects, creating a truly remarkable focal point. Upstairs, two generously sized double bedrooms each benefit from their own ensuite bathrooms, offering comfort and privacy. Externally, the property is approached via a gated driveway providing ample off-road parking, bordered by attractive, well-stocked flower beds. The rear garden has been beautifully landscaped for ease of maintenance, featuring a patio area, a charming garden pond, established planting, and a large expanse of artificial lawn. This exceptional home perfectly balances character, modern living, and flexible accommodation, making it ideal for extended families or those seeking a lifestyle property with additional income potential—all set within one of the South East's most sought-after natural landscapes.

Uckfield 01825 703000
Crowborough 01892 489000
Heathfield 01435 511800

Peter Oliver

The Property
Ombudsman

The Property
Ombudsman
LETTINGS



GROUND FLOOR 72.8 sq.m. (784 sq.ft.) approx.

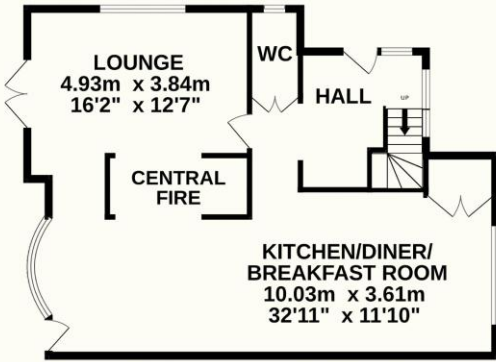

1ST FLOOR 55.3 sq.m. (596 sq.ft.) approx.

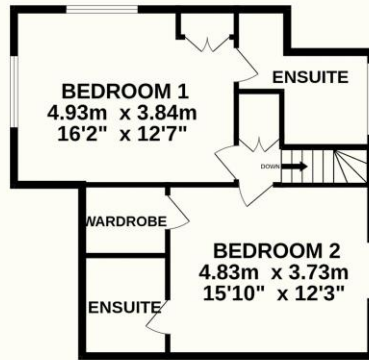

OUTBUILDINGS 48.2 sq.m. (519 sq.ft.) approx.

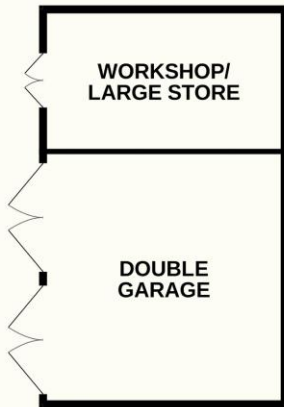

DETACHED ANNEXE 89.7 sq.m. (966 sq.ft.) approx.



TOTAL FLOOR AREA : 266.1 sq.m. (2864 sq.ft.) approx.

Whilst every attempt has been made to ensure the accuracy of the floorplan contained here, measurements of doors, windows, rooms and any other items are approximate and no responsibility is taken for any error, omission or mis-statement. This plan is for illustrative purposes only and should be used as such by any prospective purchaser. The services, systems and appliances shown have not been tested and no guarantee as to their operability or efficiency can be given.

Made with Metropix ©2026



TENURE: FREEHOLD

COUNCIL TAX BAND: E

MAINTENANCE/SERVICE CHARGE: N/A

Uckfield 01825 703000
Crowborough 01892 489000
Heathfield 01435 511800
info@peteroliverhomes.co.uk

Peter Oliver