



CHRISTCHURCH AVENUE, NW6

£800,000

This rarely available ground floor flat forms part of an attractive property, ideally located in one of the area's most sought-after neighbourhoods, within easy reach of both Kilburn and Queen's Park. The property

Two bedrooms
Two bathrooms
Share of freehold

South facing
Garden studio
Private garden

STEP INSIDE CHRISTCHURCH AVENUE

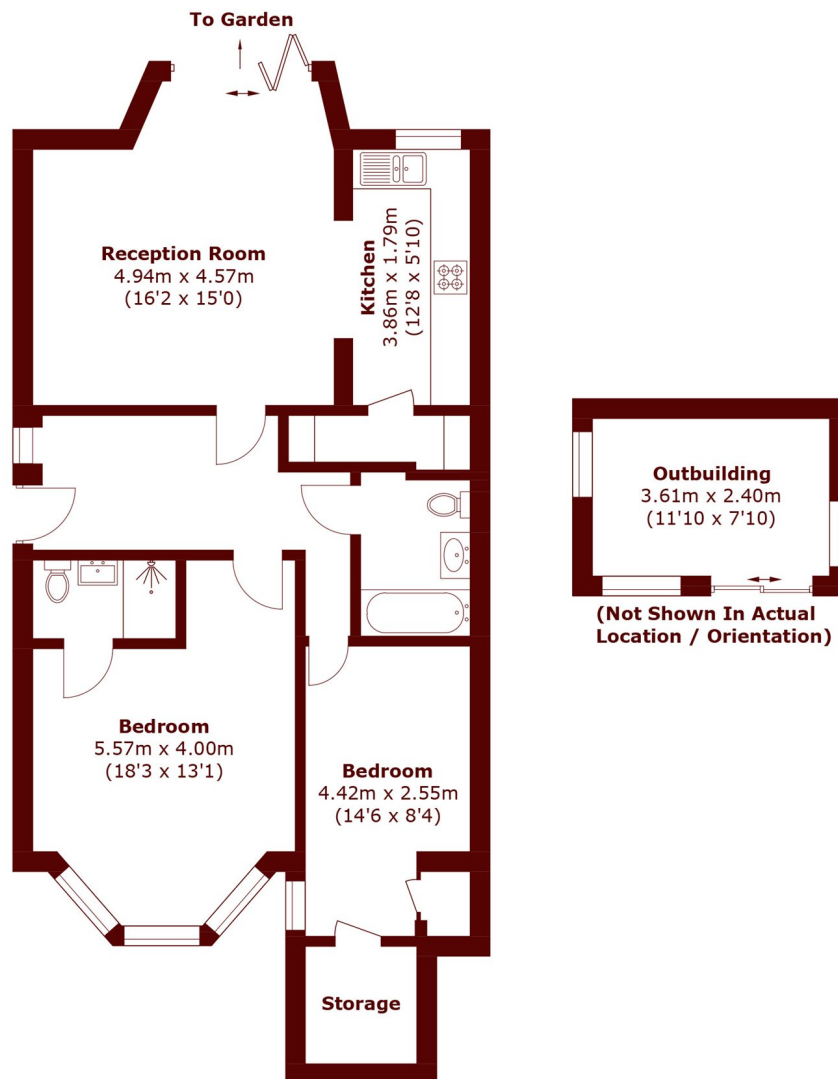

Total area (approx.): 83.3 sq. m (896.6 sq. ft)
Outbuilding: 8.9 sq. m (95.8 sq. ft)

Willesden Green
020 8451 0420

Energy Rating: C We aim to make our particulars both accurate and reliable. However, they are not guaranteed; nor do they form part of an offer or contract. If you require clarification on any points then please contact us, especially if you're traveling some distance to view. Please note that appliances and heating systems have not been tested and therefore no warranties can be given as to their good working order

**MARSH &
PARSONS**