



6 Ashford Close

Elwick Park, Hartlepool, TS26 0GJ

Offers In The Region Of £325,000



Igomove are pleased to present this stunning four bedroomed detached house situated in desirable location, catchment area for good schools including West Park and High Tunstall, constructed by renowned builders Dutchy homes to its Oakwood design, this fantastic property offers a host of desirable attributes which include; four large double bedrooms (master benefitting from spacious en suite and dressing room), superb family bathroom, delightful lounge, inviting entrance hall, open concept kitchen/diner/family room, utility room, guest cloakroom, garage, four car driveway, electric car charger, gardens, Upvc double glazing, gas central heating, stylish decor throughout, owned outright solar panels to rear aspect, freehold.



Attractive brick facade, newly extended four vehicle block paved driveway, integral garage.

Front door into;

Inviting entrance hall, porcelain tiled floor, immaculate decor, turned stairs to the first floor accommodation, contemporary column radiator.

Stylish lounge with media wall with wall mounted contemporary living flame fire, impeccable decor, column radiator.

Open concept upgraded kitchen diner fitted with a selection of high gloss larder, wall, base and drawer cabinets, complimentary solid surfaces and co ordinating backsplash, integrated double oven, integrated hob, integrated extractor, composite inset one and a half bowl sink with mixer tap, integrated hot point dishwasher, porcelain tiled floor, recessed spotlights, column radiator, immaculate decor, French doors opening to rear garden, ample space to dine and relax.

Utility room with plumbing for washing machine, space for American fridge freezer, porcelain tiled floor, fitted cabinets, spot lights, half glazed rear aspect door.

Guest cloakroom comprising concealed cistern WC and vanity wash basin, porcelain tiled floor, spot lights, stylish decor.

To the first floor there is a fitted storage cupboard and access to;

Master double bedroom suite with bay window to the front elevation Hammond ,high gloss push fit wardrobes, impeccable decor, with access to;

Walk in dressing room with spotlights and fitted Hammond wardrobe storage which in turn leads into;

En suite shower and flipper board added comprising over sized shower enclosure, concealed cistern WC and vanity wash basin, chrome heated towel radiator, spot lights, complimentary white shower boards and chrome trims.

Bedroom two is a large rear aspect double, immaculately presented, Hammond high gloss push fit wardrobes.

Bedroom three is a front aspect generous double, Hammond high gloss push fit wardrobes.

Bedroom four is a further double situated to the rear, pristine decor.

The family bathroom comprises bath, chrome mixer and shower head, concealed cistern WC and vanity wash basin, spot lights, stylish tiling, chrome towel rail, white shower boards and chrome trims, superb decor.

To the rear is an enclosed South facing landscaped artificial turf to rear garden with Indian stone patio areas and established shrubbery. The property benefits from an outside tap, lights to the back and front.

This absolutely beautiful residence is available to view by contacting Igomove at your earliest opportunity.

These particulars, whilst believed to be accurate are set out as a general outline only for guidance and do not constitute any part of an offer or contract. Intending purchasers should not rely on them as statements of representation of fact, but must satisfy themselves by inspection or otherwise as to their accuracy. No person in this firms employment has the authority to make or give any representation or warranty in respect of the property.

Area Map

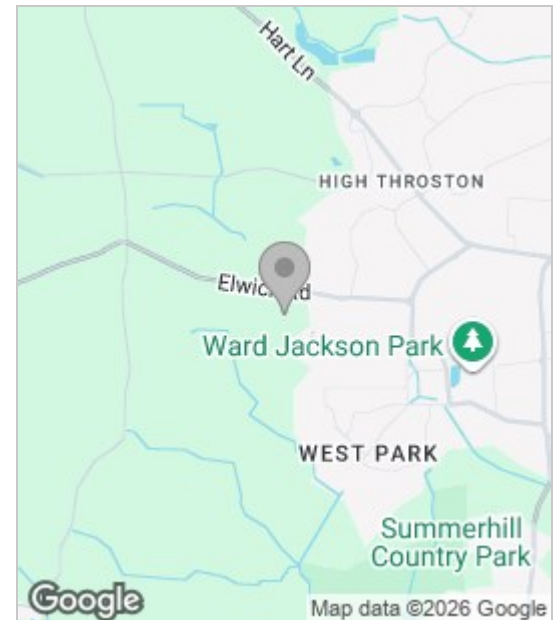

Floor Plan

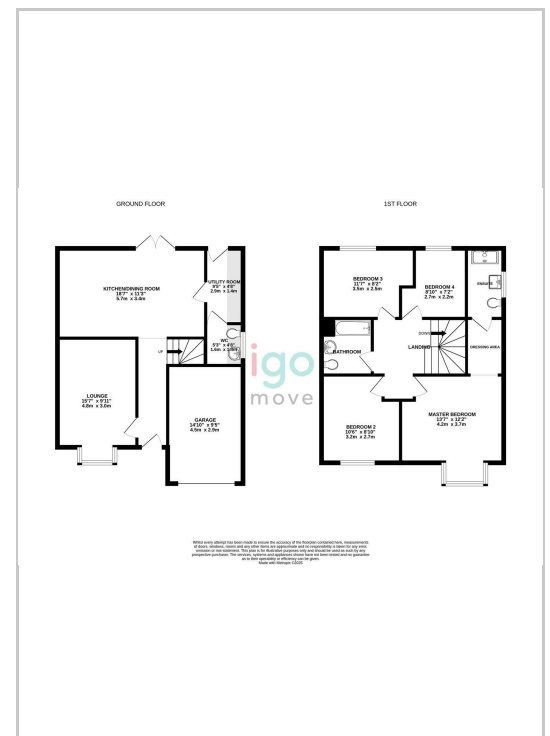

Energy Efficiency Graph

