

SIGNATURE

NORTH EAST

OFFICIALLY RATED THE NO.1 ESTATE AGENT IN THE NORTH EAST





📍 Front Street, Newbiggin-By-The-Sea NE64 6AD

Front Street, Newbiggin-By-The-Sea NE64 6AD

Offers Over £335,000

Signature North East is delighted to present this exceptional property on Front Street in the charming village of Newbiggin-By-The-Sea. Ideally positioned in the heart of the village, this property offers a unique opportunity for those seeking a blend of commercial and residential living.

The commercial space on the ground floor is ideal for setting up a shop, office, or any business venture you desire, boasting the potential for a lucrative income stream. Imagine the convenience of having your business just downstairs while enjoying the comfort of a residential space on top. This setup not only offers practicality but also a sense of exclusivity.

Above the commercial area, there is a residential maisonette which can be accessed directly through the shop. There is also the possibility of creating a private entrance to the residential space by reinstating the original corridor to separate the residential and commercial entrances. In the residential area, you will find a spacious living room, an open-plan kitchen and dining room, a utility room with outdoor access to a patio/veranda with sea views, and on the 2nd floor, three well-appointed double bedrooms and a three-piece family bathroom.

Whether you are looking to invest in a rental property or establish your own business, this property presents a versatile and exciting opportunity.



PLEASE NOTE THAT THE VENDOR HAS CERTIFIED THE PROPERTY INFORMATION AND IMAGES.

PROPERTY FLOORPLAN

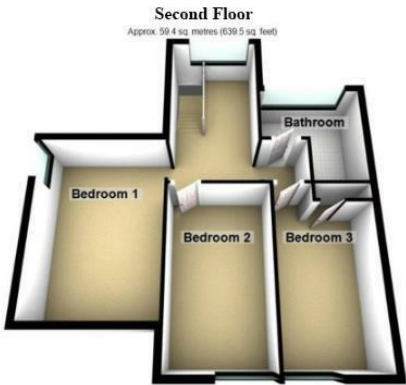
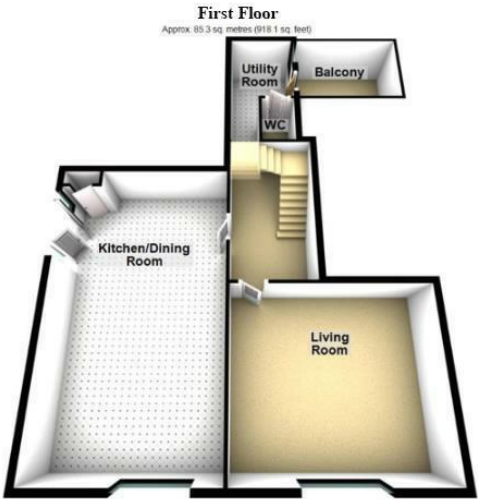

Total area: approx. 144.7 sq. metres (1557.6 sq. feet)
Please be advised the floorplans are not drawn to scale and are to be used to give an idea of the layout of the property.
Plan produced using PlanUp.

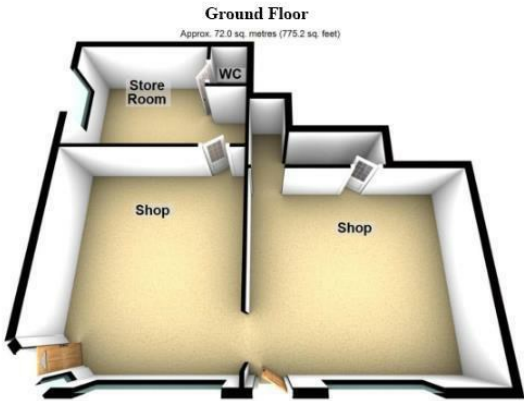

Total area: approx. 72.0 sq. metres (775.2 sq. feet)
Please be advised the floorplans are not drawn to scale and are to be used to give an idea of the layout of the property.
Plan produced using PlanUp.

Measurements:

- Living Room
17'10" x 15'10"
- Kitchen / Dining Room
27'1" x 15'7"
- Utility Room
12'9" x 6'6"
- WC
5'0" x 3'4"
- Bedroom One
15'6" x 11'0"
- Bedroom Two
15'1" x 8'7"
- Bedroom Three
15'1" x 8'2"
- Bathroom
9'0" x 8'11"
- Shop
15'5" x 14'10"
- Shop
17'7" x 16'0"
- Store Room
15'5" x 10'4"
- WC
4'1" x 3'4"

Energy Efficiency Rating		
	Current	Potential
Very energy efficient - lower running costs		
(92 plus) A		
(81-91) B		
(69-80) C		
(55-68) D	59	68
(39-54) E		
(21-38) F		
(1-20) G		
Not energy efficient - higher running costs		
England & Wales		
EU Directive 2002/91/EC		





More 5 Star Customer Reviews than any other Agent based in the North East on allAgents.co.uk



SALES

LETTINGS

FINANCE

LAW

WE COVER THE WHOLE OF THE NORTH EAST

Whitley Bay
0191 251 3344

Cramlington
01670 897 213

Tynemouth
0191 296 6689

Morpeth
01670 513 966

Ponteland
01661 820 082

Wallsend
0191 432 4151

Alnwick
01665 511 800

Heaton
0191 432 4275

Forest Hall
0191 266 9966

Other locations
0191 640 3523

Newcastle
0191 640 2284

Durham
0191 303 8252

Gosforth
0191 640 3523

Sunderland
0191 543 6390

Whickham
0191 432 5102

Gateshead
0191 432 4294

Jesmond
0191 281 1037

Killingworth
0191 640 3602

Ryton
0191 413 9845

Head Office &
Lettings
0191 253 4815

*Highest recommended 5-star reviews than any other Estate Agent based in the North East on allAgents.co.uk - The UK's Largest Customer Review Website for the Property Industry & Awarded Best Estate Agency 2018 & 2019 - North East England by SME News