



## Petersfield Rise, SW15

£2,450 Per calendar month

In a purpose-built development, this three bedroom split-level maisonette has a spacious reception room and has a large garden. Perfect for students or professional sharers.

Petersfield Rise allows easy access to Roehampton University and also has excellent local amenities including a 24 hour supermarket close by.

### Features

- Three Bedrooms
- Split-Level
- Spacious Reception
- Large Garden
- Own Entrance
- Close To Transport

# Petersfield Rise, London, SW15

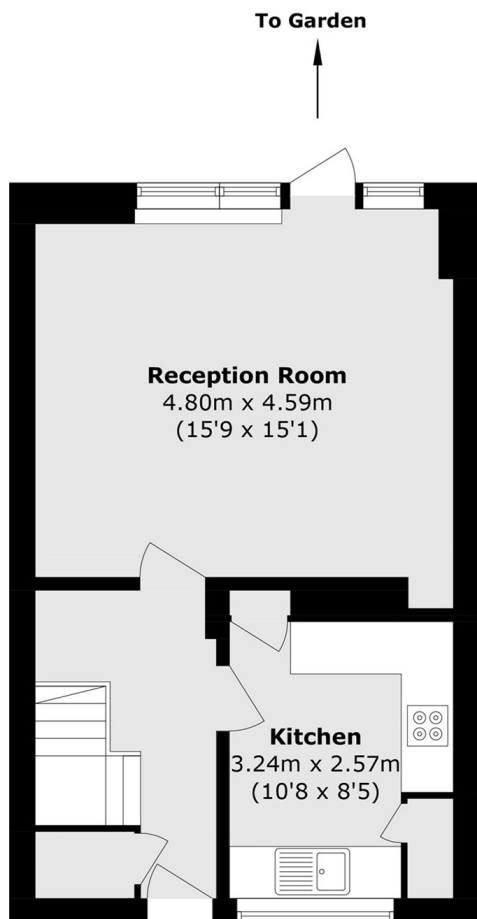

**Ground Floor**

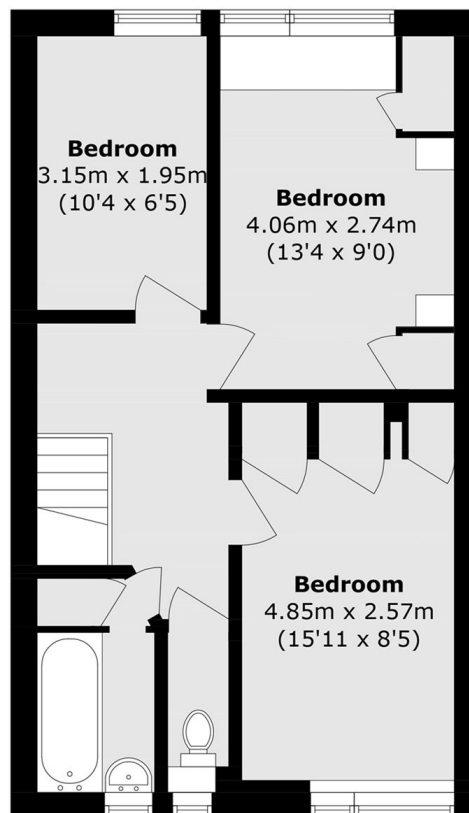

**First Floor**

Total Area (approx.): 79.6 sq. m (856.8 sq. ft)