



MILE



Buckingham Road, London NW10

£410,000 Share of Freehold

Welcome to Buckingham Road, a well-presented one-bedroom garden apartment offered to the market chain free with a share of freehold, combining period charm, practical living space and exciting future potential. The property features a generous double bedroom, a modern eat-in kitchen, a bright reception room and a private rear garden – a real extension of the living space and perfect for entertaining, relaxing or gardening. Subject to the usual planning permissions and consents, there is also scope to extend, making this an excellent long-term purchase. Buckingham Road is a popular residential street, ideally positioned between Kensal Rise, Harlesden and Willesden Junction, giving residents easy access to a wide choice of independent cafés, restaurants, local amenities and green spaces. Excellent transport links are close by, with Willesden Junction (London Overground and Bakerloo Line) and Harlesden (Bakerloo Line) stations both within easy reach, providing straightforward access into Central London and beyond.

- **Period conversion**
- **Ground floor apartment**
- **Double bedroom**
- **Chain Free**
- **Share of freehold**
- **Private garden**
- **Potential to extend (STPP)**
- **Well proportioned**
- **Eat-in kitchen**
- **Close to shops and transports**

BUCKINGHAM ROAD, NW10

560 sq ft

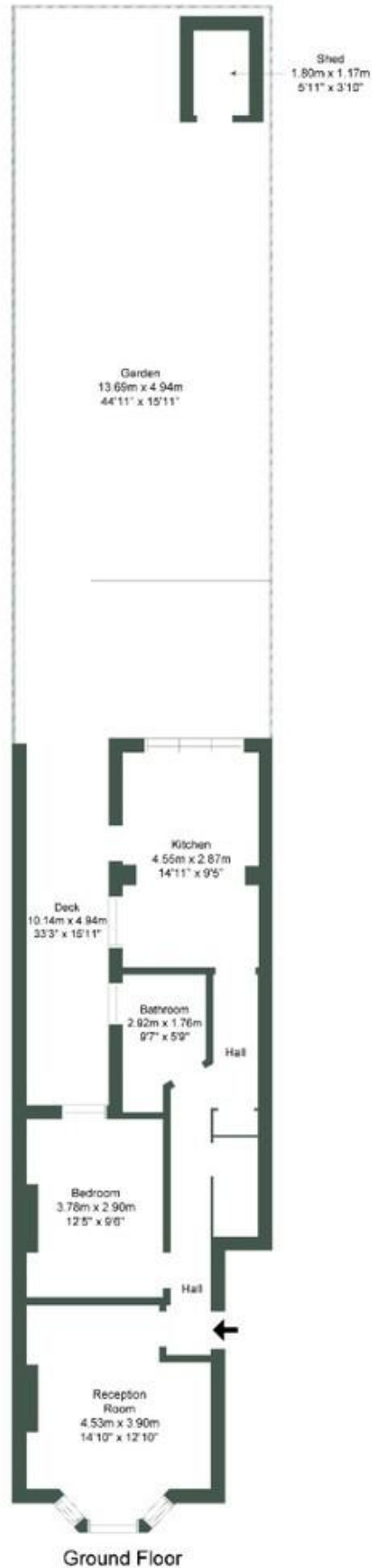

This floor plan is not to scale and measurements and areas are approximate and therefore should be used for illustrative purposes only. maximum widths and

MONEY LAUNDERING REGULATIONS 2003: Intending purchasers will be asked to produce identification documentation at a later stage and we would ask for your co-operation in order that there will be no delay in agreeing the sale.

General: While we endeavour to make our sales particulars fair, accurate and reliable, they are only a general guide to the property and, accordingly, if there is any point which is of particular importance to you, please contact the office and we will be pleased to check the position for you, especially if you are contemplating travelling some distance to view the property.

Measurements: These approximate room sizes are only intended as general guidance. You must verify the dimensions carefully before ordering carpets or any built-in furniture.

Services: Please note we have not tested the services or any of the equipment or appliances in this property, accordingly we strongly advise prospective buyers to commission their own survey or service reports before finalising their offer to purchase.