



Peregrine Road, Brockworth, Gloucester, GL3
£250,000

**ADAM
HALLIWELL**
property

powered by **exp** UK

Bedrooms: 2

Bathrooms: 1

Receptions: 1

A modern 2-bedroom end-terrace house in Brockworth, Gloucester (built 2019) offering a separate kitchen, open-plan living room with French doors to a landscaped southly-facing garden and garden office, two double bedrooms, parking for two cars, and convenient access to local amenities, transport links and nearby countryside.

For sale – a 2-bedroom end of terrace house in Brockworth, on the edge of Gloucester, built by David Wilson Homes in 2019 and maintained in good condition. The property is set in an urban area on the edge of the countryside, with convenient access to local amenities, green spaces and established walking and cycling routes.

The ground floor opens into a separate hallway, providing access to a front-facing separate kitchen, fitted with appliances. There is a downstairs WC for added convenience. To the rear, the open-plan living room features large windows and French doors leading directly to the landscaped, southly-facing rear garden. This room also benefits from a useful store cupboard, as well as pleasant garden views and direct access to the outdoor space.

Upstairs, the master bedroom is a double, and the second bedroom is also a double, with built-in wardrobe providing practical storage. The bathroom includes a shower over the bath. The house is in Council Tax Band B.

Externally, the landscaped rear garden provides a south-facing aspect and includes a garden office with power and internet access, perfect for those working from home, a place to read a book or as a garden bar! There is side-by-side parking to the front of the property.





Property Type: End of Terrace House

For sale – a 2-bedroom end of terrace house in Brockworth, on the edge of Gloucester, built by David Wilson Homes in 2019 and maintained in good condition. The property is set in an urban area on the edge of the countryside, with convenient access to local amenities, green spaces and established walking and cycling routes.

The ground floor opens into a separate hallway, providing access to a front-facing separate kitchen, fitted with appliances. There is a downstairs WC for added convenience. To the rear, the open-plan living room features large windows and French doors leading directly to the landscaped, southly-facing rear garden. This room also benefits from a useful store cupboard, as well as pleasant garden views and direct access to the outdoor space.

Upstairs, the master bedroom is a double, and the second bedroom is also a double, with built-in wardrobe providing practical storage. The bathroom includes a shower over the bath. The house is in Council Tax Band B.

Externally, the landscaped rear garden provides a southly-facing aspect and includes a garden office with power and internet access, perfect for those working from home, a place to read a book or as a garden bar! There is side-by-side parking to the front of the property.

Brockworth offers good local amenities including supermarkets, local shops and everyday services, with further facilities available in nearby Gloucester. The area benefits from public transport links towards Gloucester and Cheltenham. Gloucester railway station, reachable in around 15–20 minutes by car or local bus, offers regular services to Bristol (from approximately 50–60 minutes), Birmingham (around 55–70 minutes) and London Paddington (from about 1 hour 50 minutes, with changes). Road connections are strong, with access to the A417 and M5 for regional and national travel.

Nearby green spaces and walking routes around Brockworth and towards the Cotswold escarpment provide opportunities for outdoor recreation, while local cycling routes support active travel. The combination of setting, modern construction and practical layout makes this end of terrace house suitable for first-time buyers, investors and downsizers.

- Modern 2019 David Wilson build
- End of terrace with side by side parking
- Two double bedrooms
- Landscaped 30' x 17' southly-facing rear garden
- Garden office for home working
- Open-plan living with French doors
- Separate fitted kitchen with appliances
- Downstairs WC and family bathroom
- Edge-of-countryside urban location
- Good road and rail connections



Peregrine Road, Brockworth, Gloucester, GL3

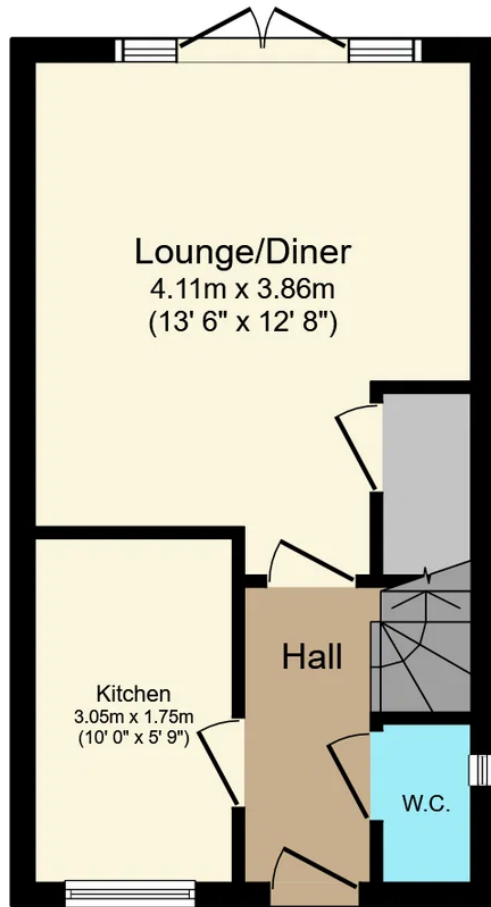

Ground Floor

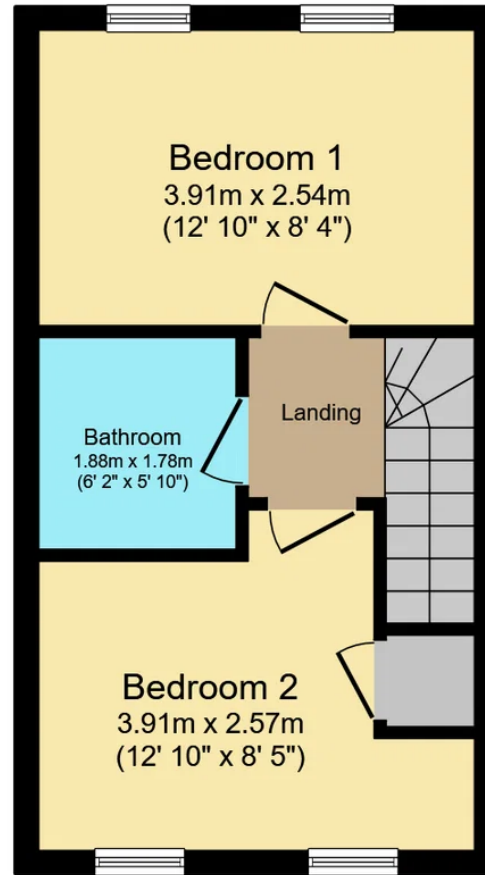

First Floor

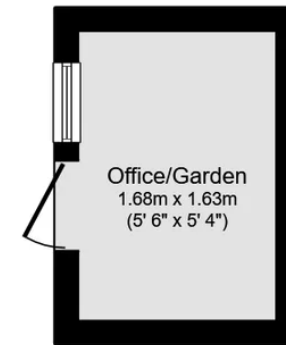

Outbuilding

Total floor area: 60.6 sq.m. (652 sq.ft.)

This floor plan is for illustrative purposes only. It is not drawn to scale. Any measurements, floor areas (including any total floor area), openings and orientations are approximate. No details are guaranteed, they cannot be relied upon for any purpose and do not form any part of any agreement. No liability is taken for any error, omission or misstatement. A party must rely upon its own inspection(s). Powered by www.Propertybox.io



Peregrine Road, Brockworth, Gloucester, GL3

£250,000

