

Head Office:
Dixon Kelley Estate Agents
1 Penn Court
Station Road, West Moors
Dorset. BH22 0JJ

DORSET PARK HOMES

DRAFT

www.dorsetparkhomes.com

Telephone: 01202 877511

52 St Leonards Farm Park, Ringwood Road, West Moors, BH22 0AG

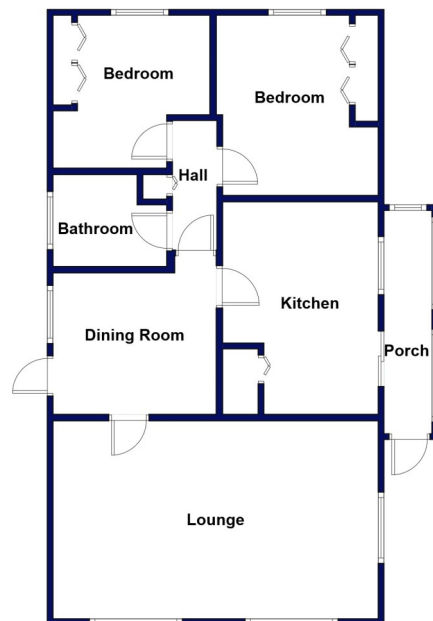

This drawing has been prepared for diagrammatic purpose only. Not to scale

2 Bedroom Park Home approx 36' x 20'

Accommodation & approximate room dimensions:

- Omar 'Southdown' circa 1982
- Large Side Porch
- Kitchen: approx 12'9" x 9'3". Range of floor and wall units. Cooker space. Space for washing machine & tall fridge/freezer. Cupboard housing combination gas boiler.
- Lounge: approx 19' x 11'9". Feature fireplace & 2 bay windows.
- Dining Room: approx 9'7" x 8'5". Door to garden.
- Inner Hall: Cloaks cupboard.
- Bedroom 1: approx 10'8" x 9'3". Fitted wardrobe.
- Bedroom 2: approx 9'5" x 9'8". Fitted wardrobe.
- Bathroom: Panelled bath with mixer tap and shower attachment. Pedestal wash basin & WC.
- PVCu Double-Glazing.
- Gas Central Heating (system untested).
- Allocated Parking for 1car
- Sunny Garden with Metal Shed
- Age Restriction 55+ No Pets Allowed
- Well maintained Residential Park near to major supermarkets & local amenities

Near to Amenities



Pitch Fee: approx £575 per quarter
Subject to Annual Review
Council Tax Band: 'A'

Tenure: 1983 Mobile Homes Act Agreement

Price £85,000

VIEWING STRICTLY BY APPOINTMENT WITH THE VENDOR'S AGENT Dorset Park Homes 01202 877511

IMPORTANT NOTE: These particulars are believed to be correct but their accuracy is not guaranteed. They do not form part of any contract. Nothing in these particulars shall be deemed to be a statement that the property is in good structural condition or otherwise, nor that any of the services, appliances, equipment or facilities are in good working order or have been tested. Purchasers should satisfy themselves on such matters prior to purchase Ref.W05265

The recommended specialist in Park Home sales
Proprietor: Simon Dixon

