



## 1 Whitefield Avenue, Luton, LU3 3AQ

A well-presented three bedroom semi-detached home situated in the popular Sundown Park area of Luton, ideal for first time buyers.

The property offers a bright and welcoming living room with open-plan access to the dining area, creating a spacious and sociable layout. The fitted kitchen provides a practical cooking space with a range of modern units and appliances.

Upstairs are three bedrooms, suitable for family living, home working or guest accommodation, along with a contemporary family bathroom.

To the rear is a low maintenance courtyard style garden, while the generous corner plot provides a sizeable front garden with potential for landscaping, off-street parking or future extension (subject to the relevant planning permissions).

- Nova Estate Agents
- Press Play Button For 360° Walkaround Tour
- 3 Bedroom Semi-Detached Home
- Large Corner Plot
- Open Plan Lounge/Diner
- Modern Kitchen
- Chain Free!
- Popular Sundon Park Location

£300,000

Approx Gross Internal Area  
68 sq m / 731 sq ft

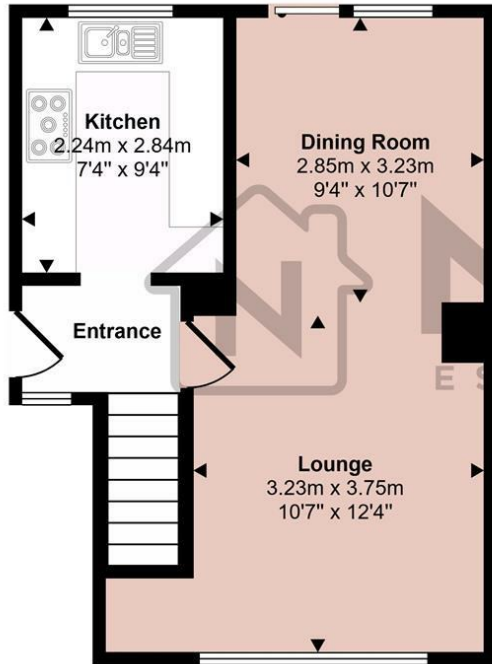

Ground Floor  
Approx 34 sq m / 365 sq ft

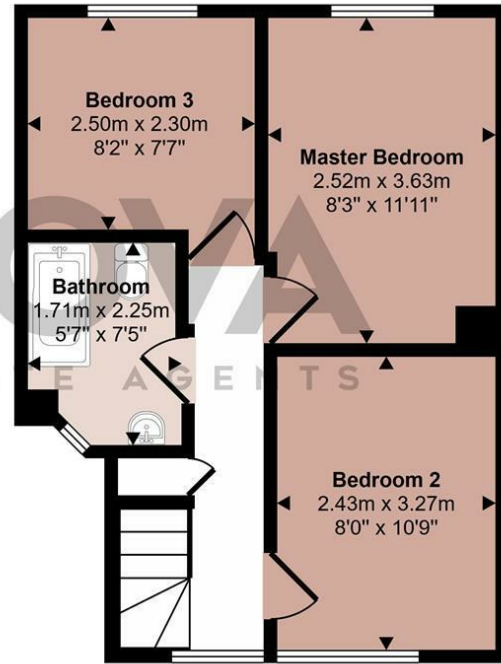

First Floor  
Approx 34 sq m / 366 sq ft

This floorplan is only for illustrative purposes and is not to scale. Measurements of rooms, doors, windows, and any items are approximate and no responsibility is taken for any error, omission or mis-statement. Icons of items such as bathroom suites are representations only and may not look like the real items. Made with Made Snappy 360.

