



Seren Park Gardens, SE3

£485,000

A beautifully presented two double bedroom apartment situated on the sixth floor of a modern development, offering far-reaching views across the London skyline from a stunning private balcony. The property comprises a spacious open-plan living and kitchen area with direct access to the balcony. Both bedrooms are generous doubles, with the main bedroom benefiting from an en suite bathroom. A modern family bathroom serves the second bedroom. Further benefits include excellent storage throughout, lift access and an abundance of natural light.

Nestled in a peaceful cul-de-sac, this property is ideally located just 0.2 miles from Maze Hill Station and the

Features

- Two Bedroom Flat
- Private Balcony
- Stunning Views Of London Skyline
- Minutes From Greenwich Park
- Minutes From Maze Hill Station
- En Suite Bathroom



Seren Park Gardens, SE3



Seren Park Gardens, London, SE3

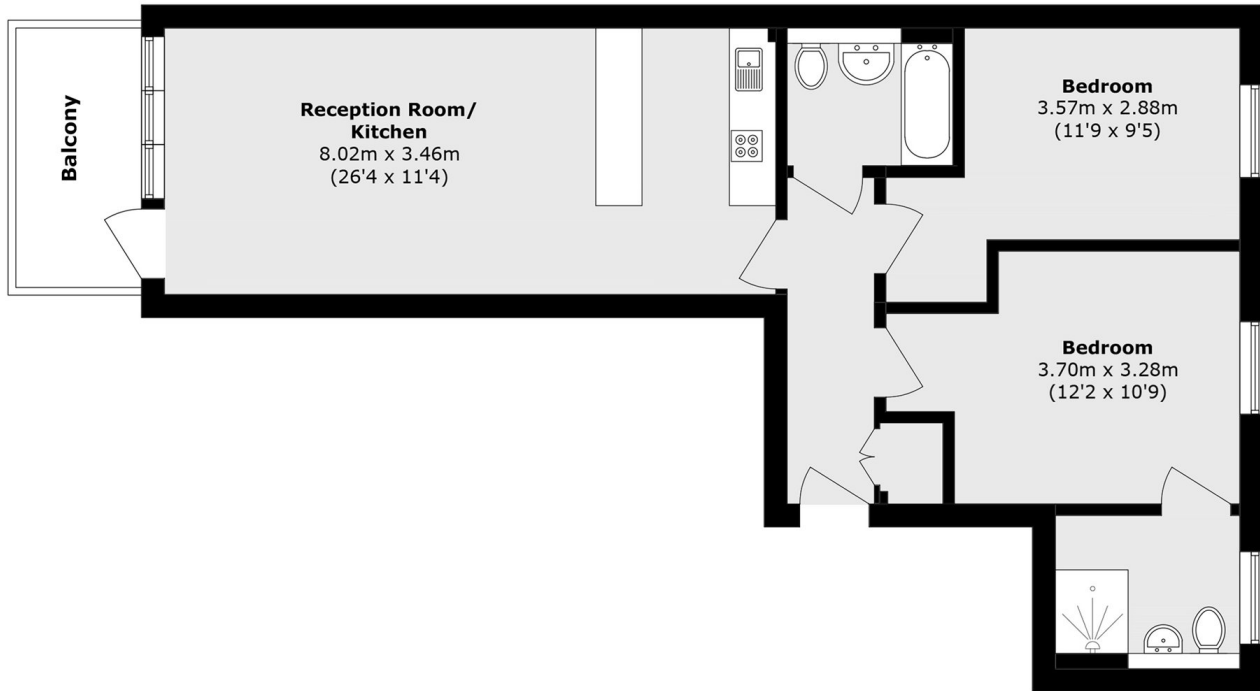

Total area (approx.): 69.3 sq. m (745.9 sq. ft)

Balcony area (approx.): 5.4 sq. m (58.1 sq. ft)