

DIRECT



MOVES



Goldcroft Avenue

, Weymouth DT4 0ET

- Double garage with large forecourt / yard
 - Large forecourt for 3/4 vehicles
 - Flexible use
- Suitable for boats, vans and larger vehicles
 - Popular convenient location
- Workshop to the rear
 - Excellent small business opportunity
 - Power and light
- Easy access from Goldcroft Avenue
 - No Chain

£80,000 Freehold





Entrance

Located just off Goldcroft Avenue approximately 3/4 of the way down, wooden gate and wooden door leading to:

Yard/Forecourt

23 x 50 max

Wall enclosed with space for multiple vehicles, the forecourt has lots potential and options. Currently the forecourt consists of:

Double garage/ Workshop

15 x 29

Double wooden doors leading to the path located off Goldcroft Avenue, power and lighting, side aspect single glazed windows

Storage unit

21 x 9 approx

Rear aspect single glazed windows, power and lighting.





Local Authority
Council Tax Band **Exempt**
EPC Rating

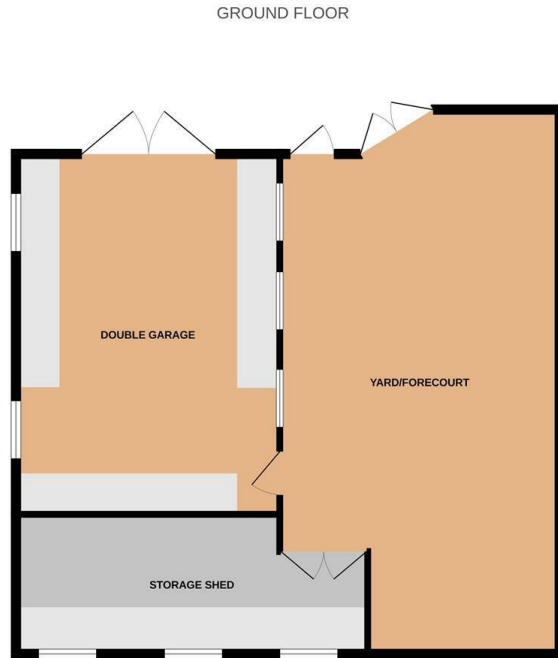

Whilst every attempt has been made to ensure the accuracy of the floorplan contained here, measurements of plots, windows, doors and any other items are approximate and no responsibility is taken for any error, omission or mis-statement. This plan is for illustrative purposes only and should be used as such by any prospective purchaser. The services, fixtures and fittings shown here are not intended to be guaranteed as to their operability or efficiency on all items.
Made with Metaphor ©2025



Direct Moves Estate Agents Office

9 Westham Road
Dorset
Weymouth
DT4 8NP

Contact

01305 778500
sales@directmoves.com
<https://directmoves.com/>

Agents Note: Whilst every care has been taken to prepare these particulars, they are for guidance purposes only. All measurements are approximate and for general guidance purposes only and whilst every care has been taken to ensure accuracy, they should not be relied upon and potential buyers/tenants are advised to recheck the measurements.