

Approximate total area*
448 sq ft
41.4 m²

(*) Excluding balconies and terraces

Calculations reference the BCS 3PM5
3C standard. Measurements are
approximate and not to scale. This
floor plan is intended for illustration
only.

DIRAFPE360

Ground Floor



SERVICES
Understood to all be connected to mains.
Mains gas, water and electric.

TENURE
The property is Freehold and offered with the
benefit of vacant possession upon completion.

COUNCIL TAX
Council Tax is payable to the East Riding of
Yorkshire Council. The property is currently
shown as listed in Council Tax Band 'A'.

VIEWING
Strictly by appointment with the sole agents
on 01377 241919.

FREE VALUATION
If you are looking to sell your own property,
we will be very happy to provide you with a
free, no obligation market appraisal and
valuation. We offer very competitive fees and
an outstanding personal service that is rated
5 star by our fully verified past clients.



Asking Price
£155,000

34 Northfield Road,
Driffield, YO25 5EU

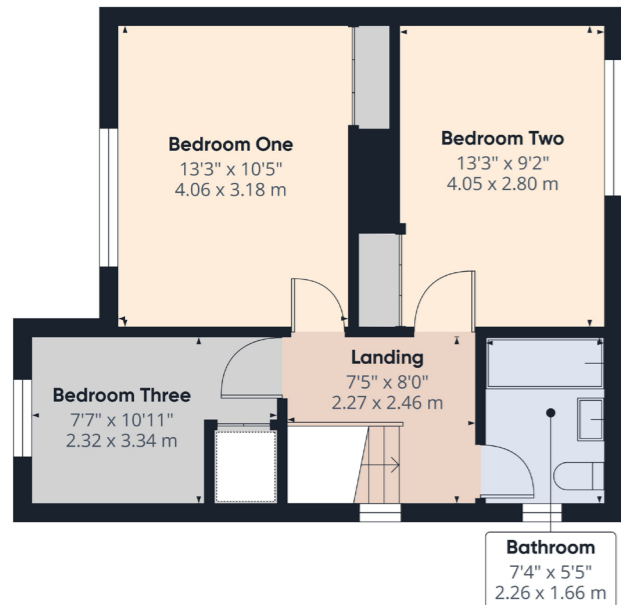

Approximate total area*
420 sq ft
39.0 m²

(*) Excluding balconies and terraces

Calculations reference the BCS 3PM5
3C standard. Measurements are
approximate and not to scale. This
floor plan is intended for illustration
only.

DIRAFPE360

Floor 1

Score	Energy rating	Current	Potential
92+	A		
81-91	B		
69-80	C		76 C
55-68	D	57 D	
39-54	E		
21-38	F		
1-20	G		



56 Market Place, Driffield | 01377 241919 | www.dee-atkinson-harrison.co.uk

Disclaimer: Dee Atkinson & Harrison for themselves and for the vendors or lessors of this property, whose Agents they are, give notice that these particulars are produced in good faith, are set out as a general guide only and do not constitute any part of a Contract. No person in the employment of Dee Atkinson & Harrison has any authority to make any representation or warranty whatever in relation to this property.

Dee Atkinson & Harrison



34 Northfield Road, Driffield, YO25 5EU

Brought to the market with no onward chain, 34 Northfield Road is a three bedroom property located in a sought after established area. Having been loved by the current owners, it has been well maintained throughout but allows any potential buyer to make it their own. The property boasts spacious accommodation both internally and externally- viewings are highly recommended!

The property briefly comprises:- entrance hall, lounge, kitchen/dining area, first floor landing, three bedrooms, family bathroom, rear garden and off street parking.

LOCATION
Driffield offers an outstanding array of amenities, including shops, restaurants, public houses, quality sports facilities dedicated to Rugby, Golf, Football, Bowls, Cricket and many others, as well as a very highly regarded Secondary School. It also provides excellent road and public transport connections to Hull, Beverley, Bridlington and Scarborough.

THE ACCOMMODATION COMPRISES:

ENTRANCE HALL- 6'7 (2.01m) x 11'0 (3.36m)

Door to the side aspect, window to the front aspect, stairs leading to the first floor landing, understairs cupboard, fitted carpets, radiator and power points.

LOUNGE- 14'0 (4.27m) x 10'5 (3.18m)

Window to the front aspect, gas fireplace with surround and hearth, fitted carpets, radiator, TV point and power points.

KITCHEN/DINING AREA- 2'10 (6.40m) x 9'2 (2.80m)

Door and windows to the rear aspect leading out to the garden, built in storage cupboard, tiled splash back, a range of wall and base units, sink with drainer unit, space for fridge/freezer, plumbing for washing machine, electric oven, electric hob, extractor hood, vinyl flooring and fitted carpets, radiator and power points.

FIRST FLOOR LANDING- 7'5 (2.27m) x 8'0 (2.46m)

Window to the side aspect, fitted carpets and radiator. There is also access to the loft.

BEDROOM ONE- 13'3 (4.06m) x 10'5 (3.18m)

Window to the front aspect, built in

wardrobe, fitted carpets, radiator, TV point and power points.

BEDROOM TWO- 13'3 (4.05m) x 9'2 (2.80m)

Window to the rear aspect, built in wardrobe and fitted wardrobes, fitted carpets, radiator, TV point and power points.

BEDROOM THREE- 7'7 (2.32m) x 10'11 (3.34m)

Window to the front aspect, built in cupboard, fitted carpets, radiator and power points.

BATHROOM- 7'4 (2.26m) x 5'5 (1.66m)

Opaque window to the side aspect, partially tiled walls, three piece bathroom suite comprising:- low flush WC, sink with pedestal, panelled bath, vinyl flooring and extractor fan.

GARDEN

Very well presented South facing garden which is mainly laid with lawn, slate area to the rear, patio area to the immediate rear of the property, brick outbuilding ideal for storage and hedging round the boundary.

PARKING

Off street parking.

