



RESIDENTIAL



2 New Road, Halifax, HX1 2LH

£94,450

- Expected Completion Q1 2027
- NET Yields of 7%
- White Goods Included
- High Spec Finish
- Prominent Location Being a Stones Throw from the Train Station
- Furniture Packs available

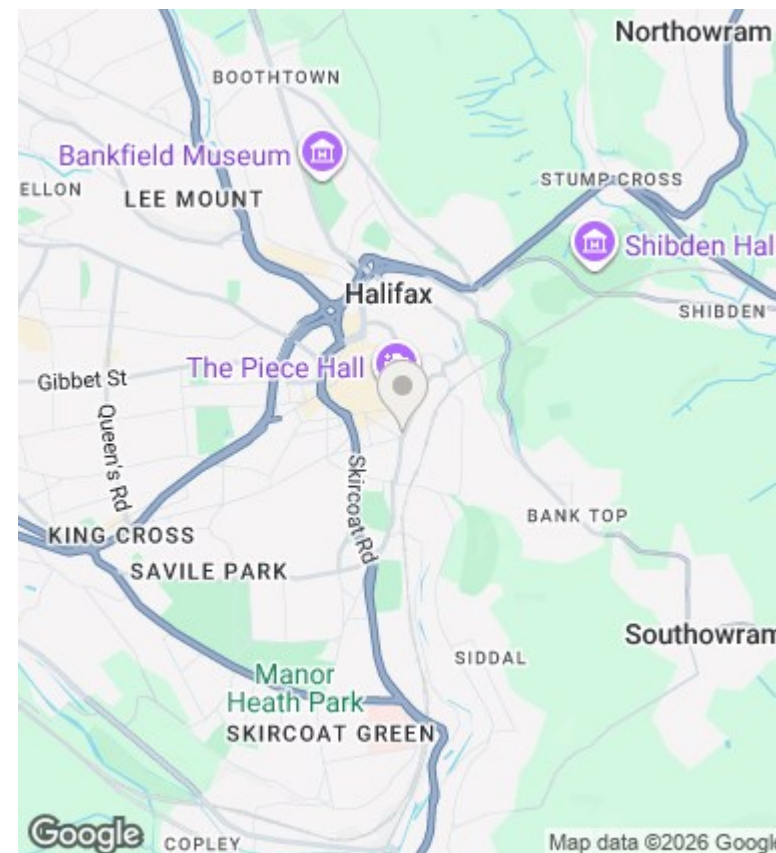
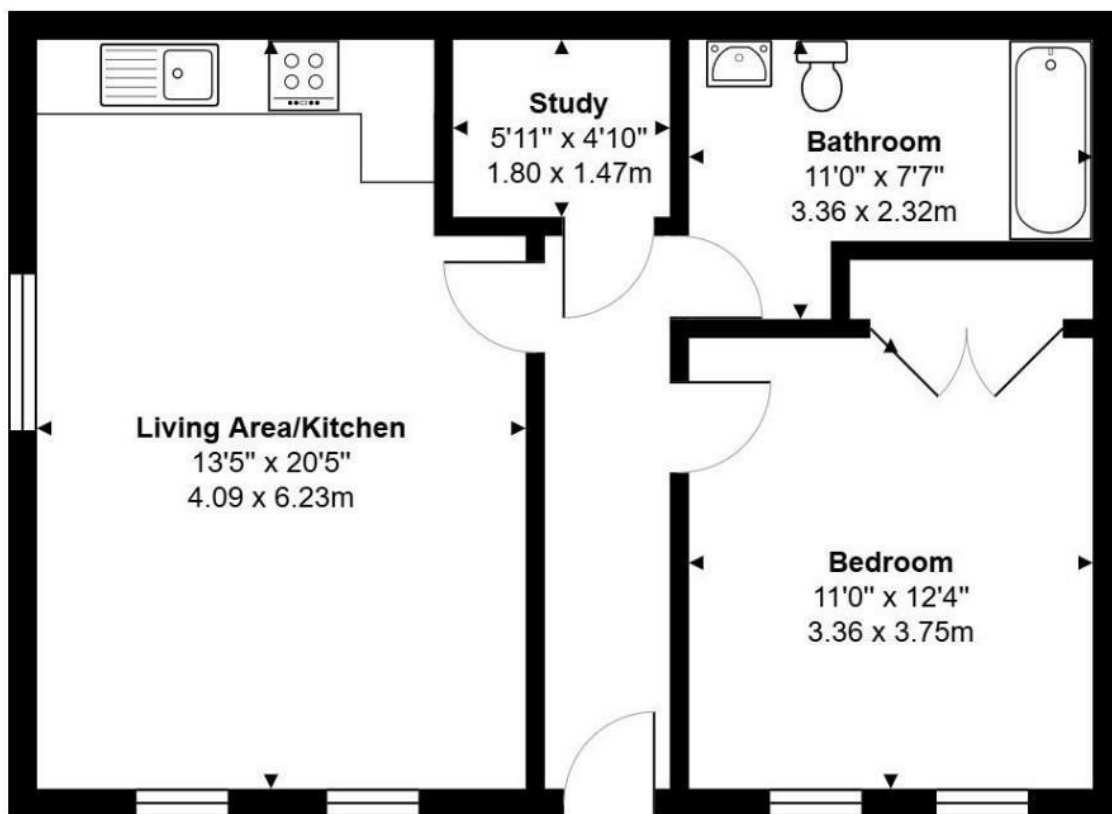

Directions

Viewings

Viewings by arrangement only. Call 0113 3224 345 to make an appointment.

Council Tax Band

EPC Rating:

Energy Efficiency Rating		
	Current	Potential
<i>Very energy efficient - lower running costs</i>		
(92 plus) A		
(81-91) B		
(69-80) C		
(55-68) D		
(39-54) E		
(21-38) F		
(1-20) G		
<i>Not energy efficient - higher running costs</i>		
England & Wales	EU Directive 2002/91/EC	