



**GINGER COW**  
ESTATE AGENTS

01234 860215

# Luton Road, Wilstead

£450,000

4 2

\*\*\*CHAIN FREE\*\*\*

Located in the ever-popular village of Wilstead, this spacious four-bedroom detached home is offered to the market with no onward chain and presents an excellent opportunity for growing families.

The property offers generous living accommodation throughout, including a comfortable lounge, a bright open-plan kitchen/dining/family space overlooking the garden, a versatile additional reception room ideal as a study or playroom, and a downstairs WC.

Upstairs features four well-proportioned bedrooms and a family bathroom with both bath and shower.

Outside, the home benefits from ample driveway parking, an attached garage, additional storage space, and a private rear



Floor Area: 1540 sq. ft.

Tenure: Not given

Service Charge: £0 per annum

Ground Rent: £0 per annum

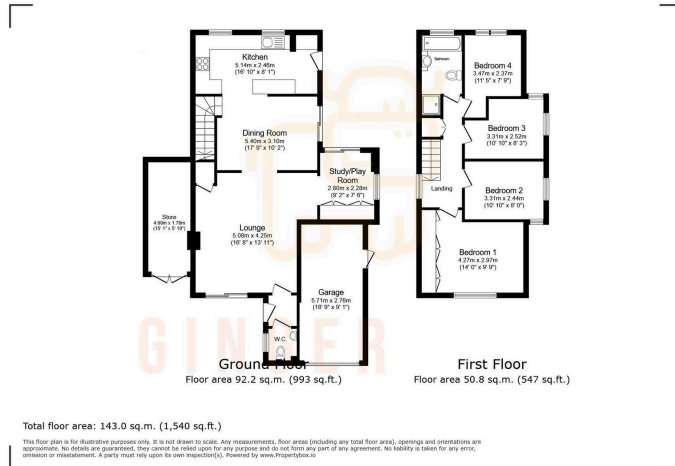

Total floor area: 143.0 sq.m. (1,540 sq.ft.)  
 This floor plan is for illustrative purposes only. It is not drawn to scale. Any measurements, floor areas (including any total floor area), openings and orientations are approximate. No details are guaranteed, they cannot be relied upon for any purpose and do not form any part of any agreement. No liability is taken for any error, omission or misstatement. A party must rely upon its own inspection(s). Powered by www.Property24.co.uk