



## Wood Common

£1,550 pcm

MAISONETTE • THREE BEDROOMS • SPACIOUS LIVING ROOM • KITCHEN/DINER • MODERN BATHROOM • SEPARATE W/C • CLOSE TO AMENITIES • UNFURNISHED • AVAILABLE AUGUST • EPC RATING - C

**KINGS**  
SALES LETTINGS MANAGEMENT

### First Floor

Approx. 41.0 sq. metres (441.6 sq. feet)

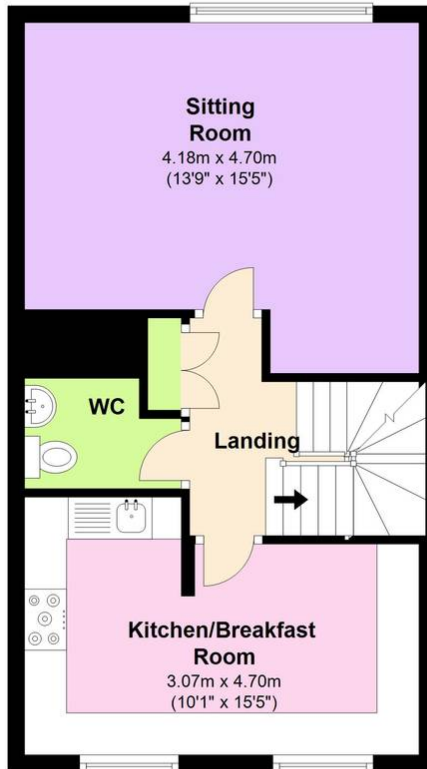

### Second Floor

Approx. 41.0 sq. metres (441.6 sq. feet)

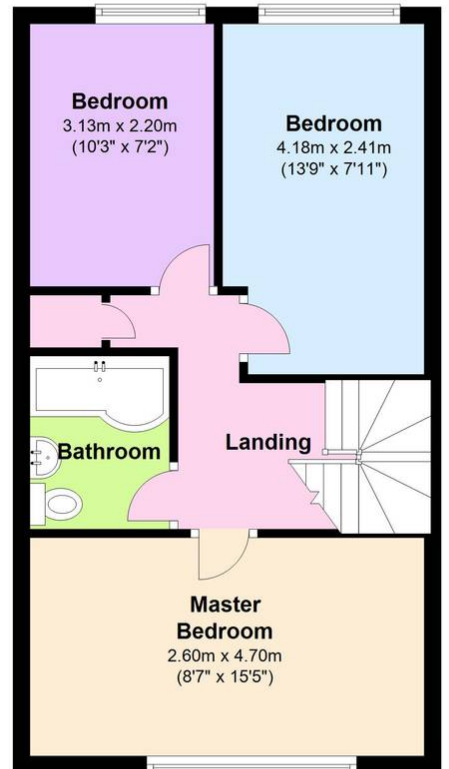

### Ground Floor

Approx. 5.6 sq. metres ( 59.8 sq. feet)

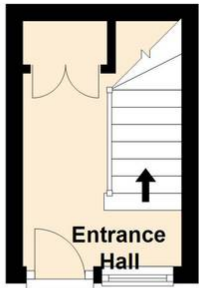

Total area: approx. 87.6 sq. metres (942.9 sq. feet)

