

**TO LET****£625 Per Calendar Month**

The Malthouse, Llansantffraid, Llansantffraid, Powys, SY22 6AR

Available from 1st August 2026

This bright and well presented two-bedroom coach house apartment enjoys a peaceful setting in the rural village of Llansantffraid while offering easy access to both Welshpool and Oswestry. The home features a spacious open-plan living area, a well-equipped modern kitchen, and two good sized bedrooms alongside a contemporary bathroom. Private parking space, plus the nearby free village car park and other local village amenities add everyday convenience.



Accommodation

The Malthouse is a beautifully presented coach-house style apartment in the heart of the thriving village of Llansantffraid. The accommodation comprises ground floor Entrance Hallway with carpeted stairs leading up to the first floor living accommodation. This opens into a bright open-plan Kitchen/Living/Dining Room with the kitchen providing for ample storage space, built-in oven and hob and space and plumbing for a dishwasher, two double Bedrooms, both with built-in storage and Bathroom with panelled bath with shower over, pedestal wash hand basin and low level WC. The property further benefits from two storage cupboards, one pantry style and the other with space and plumbing for a washing machine and condensing tumble drier. There is an allocated parking space and a small storage shed. Available now - early viewing is highly recommended.

Terms

Rent £625 per calendar month.
Deposit £720. Minimum 12 month tenancy. First months rent and deposit payable in advance.
Pets Considered.

Services

Mains water, mains electricity, mains drainage and oil-fired central heating are understood to be connected.
Council Tax Band - D - Powys County Council

Viewing

Strictly by appointment only with the letting agents Halls

Directions

Postcode for the property is SY22 6AR

What3Words Reference is pulses.elect.shopper

- Pets Considered
- Private parking space
- High Standard of Finish
- Open Plan Kitchen/Living Room
- Oil-Fired Central Heating
- First Floor Coach House Apartment

Ground Floor

1st Floor

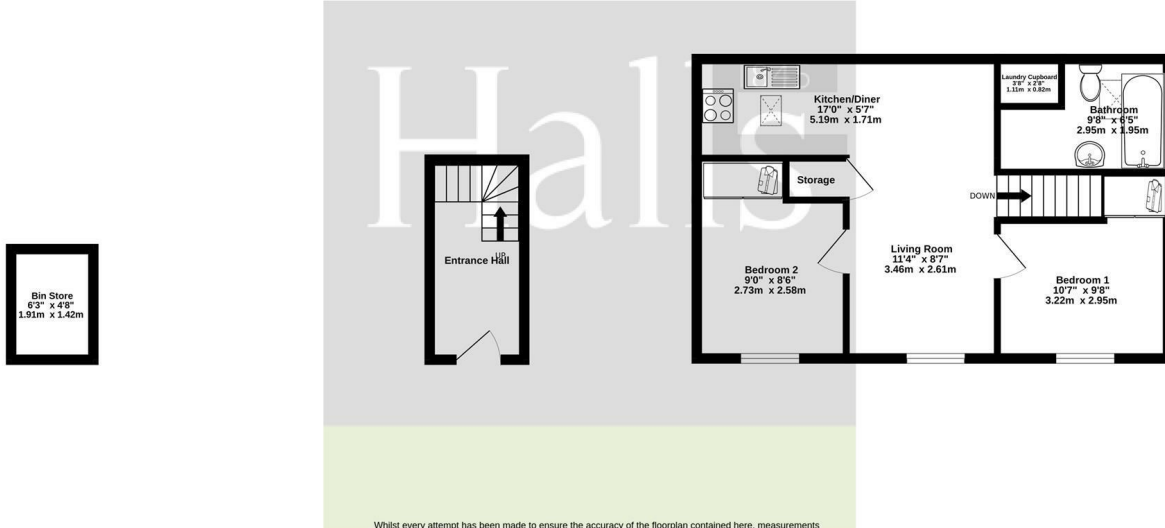

Whilst every attempt has been made to ensure the accuracy of the floorplan contained here, measurements of doors, windows, rooms and any other items are approximate and no responsibility is taken for any error, omission or mis-statement. This plan is for illustrative purposes only and should be used as such by any prospective purchaser. The services, systems and appliances shown have not been tested and no guarantee as to their operability or efficiency can be given.
Made with Metropix ©2025

Property to Let? We would be delighted to provide you with a free, no obligation, market assessment of your rental property to discuss the options available to you. We can offer **tailor made solutions** to make the letting and management of your property as easy as possible allowing for your individual circumstances and requirements.

Looking to invest? We can source ideal investment properties to provide you with the best possible return, as well as matching those properties with suitable tenants. Please contact your local Halls office for further information.

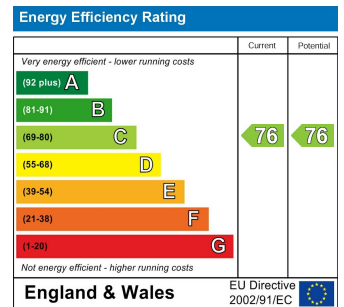

01938 555552

14 Broad Street, Welshpool, Powys, SY21 7SD
Email: welshpoollettings@hallsgb.com



IMPORTANT NOTICE. Halls Holdings Ltd and any joint agents for themselves, and for the Vendor of the property whose Agents they are, give notice that: (i) These particulars are produced in good faith, are set out as a general guide only and do not constitute any part of a contract (ii) No person in the employment of or any agent of or consultant to Halls Holdings has any authority to make or give any representation or warranty whatsoever in relation to this property (iii) Measurements, areas and distances are approximate, Floor plans and photographs are for guidance purposes only (photographs are taken with a wide angled / zoom lenses) and dimensions shapes and precise locations may differ (iv) It must not be assumed that the property has all the required planning or building regulation consents. Halls Holdings, Bowmen Way, Shrewsbury, Shropshire SY4 3DR. Registered in England 06597073.