



Redesdale Gardens, TW7

£1,750 Per calendar month

A spacious ground-floor two-bedroom maisonette with wooden flooring, fitted storage, private front garden and rear patio. Quiet cul-de-sac location in Isleworth with residents' parking, modern kitchen, tiled bathroom and bright living space.

Set on a quiet Isleworth road, moments from Syon Lane and Isleworth stations, with easy A4/M4 access. Close to shops, cafés and highly regarded schools, plus amenities in Osterley, Isleworth and Brentford town centres.

Features

- Two Double Bedrooms
- Ground Floor Maisonette
- Spacious Living Room
- Wooden Flooring Throughout
- Private Front Garden
- Easy A4 M4 Access

Redesdale Gardens, Isleworth, TW7

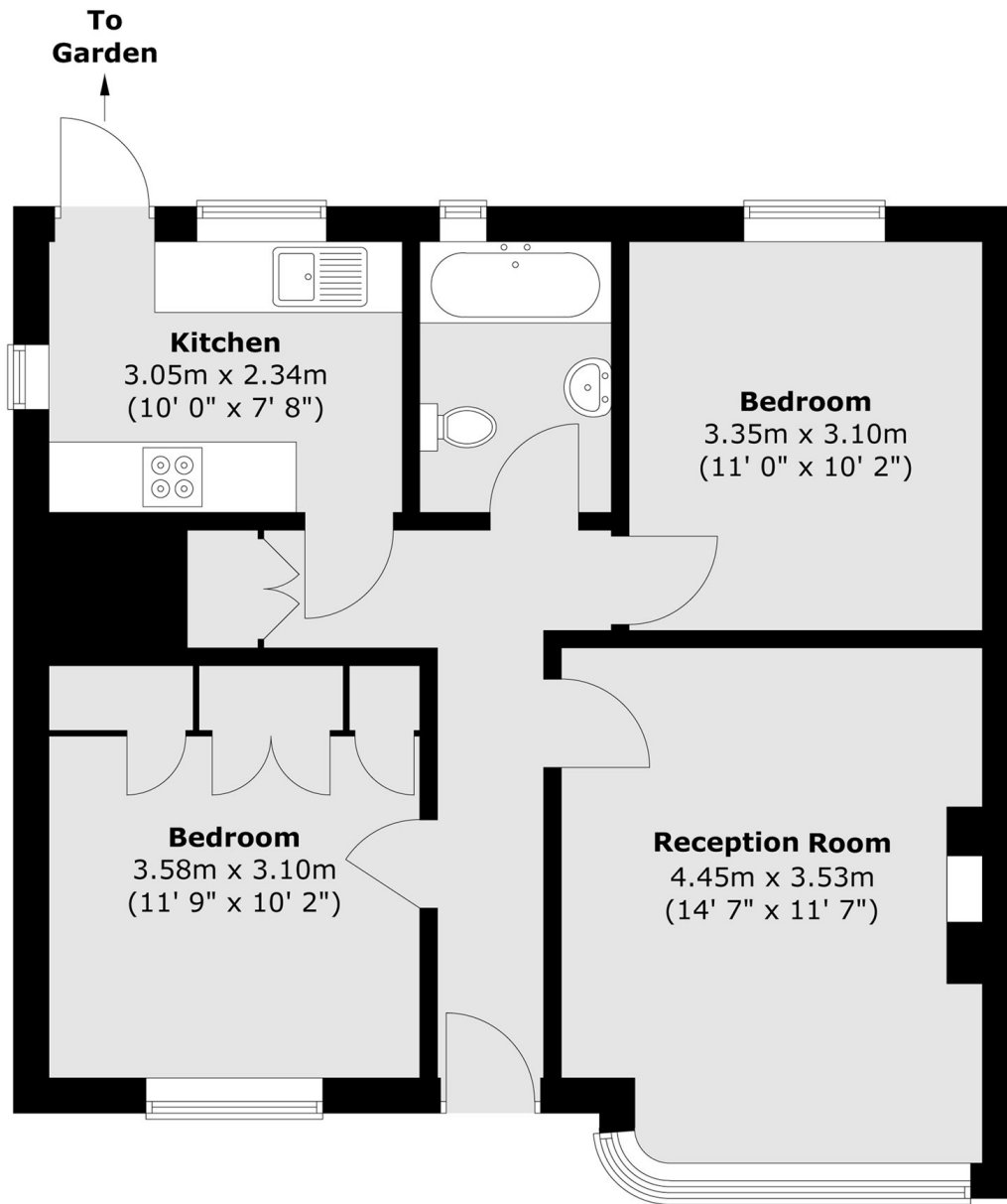

Total area (approx.) : 59 sq. m (635 sq. ft)