



THE COTTAGE

Flowton | Suffolk



Chapman Stickels

THE COTTAGE, THE GREEN, FLOWTON, SUFFOLK, IP8 4LG

Ipswich - 7 miles (London's Liverpool Street Station 70 mins)
Needham Market - 7 miles
Hadleigh - 7 miles

A FOUR-BEDROOM HOUSE OCCUPYING A QUAINR RURAL LOCATION TOGETHER WITH OFF-ROAD PARKING AND A SOUTH-FACING GARDEN OVERLOOKING FARMLAND

- Kitchen / breakfast room with utility area • Dining room / snug •
 - Double reception room • Landing •
- Three double bedrooms (with one ensuite shower room) •
 - Single bedroom • Bathroom • Off-road parking •
- South-facing garden with dining terrace • Far-reaching rural views •

The Property

Positioned opposite St Mary's church, The Cottage is a semi-detached house which likely dates from the early 1900's, with a later two-storey rear addition. Covering some 1,360 sq.ft, the accommodation is notably spacious throughout, providing a practical and pleasing layout on both floors.

The principal access is via the rear kitchen / breakfast room, which is fitted with oak worktops on three walls, numerous units and appliances including an electric range cooker. A utility area to one corner provides further storage facilities and plumbing for white goods.

The adjacent snug / family room provides a central fireplace housing a wood burner. Overlooking the principal front garden, the main reception areas span the entire width of the house, which comprises an open plan dining room and sitting room, with a central fireplace with wood burner.

Via a central landing, the first floor provides three double bedrooms and a single bedroom, where bedroom one provides a corner ensuite shower room. All remaining bedrooms are served by a family bathroom.

Outside, the property provides ample off-road parking to one side, which is accessed via a minor 'no through road'.

The main garden is chiefly to the front, which consists of an area of lawn bound by established hedges. To the eastern side is a sheltered dining terrace of brick, which returns to the kitchen side access.

Directly opposite the minor country lane, the property enjoys far-reaching rural views over open countryside.



Location

The quaint rural village of Flowton, with its picturesque church, enjoys a delightfully tucked away setting and is reached by a network of small country lanes. The neighbouring village of Somersham provides a community shop, public house and a primary school. There are also five major supermarkets within 5 miles of The Cottage.

Services

Mains water and electricity are connected. 12 Photovoltaics (PV) solar panels fitted to the main southern part of the roof. Oil-fired heating

Local Authority and Council Tax

Babergh & Mid Suffolk District Council
Band D (2026)

EPC Rating

Current D (61) Potential C (77)



The Cottage, The Green, Flowton, Suffolk, IP8 4LG

Approximate Floor Area
Main House - 1359 sq. ft / 126.28 sq. m

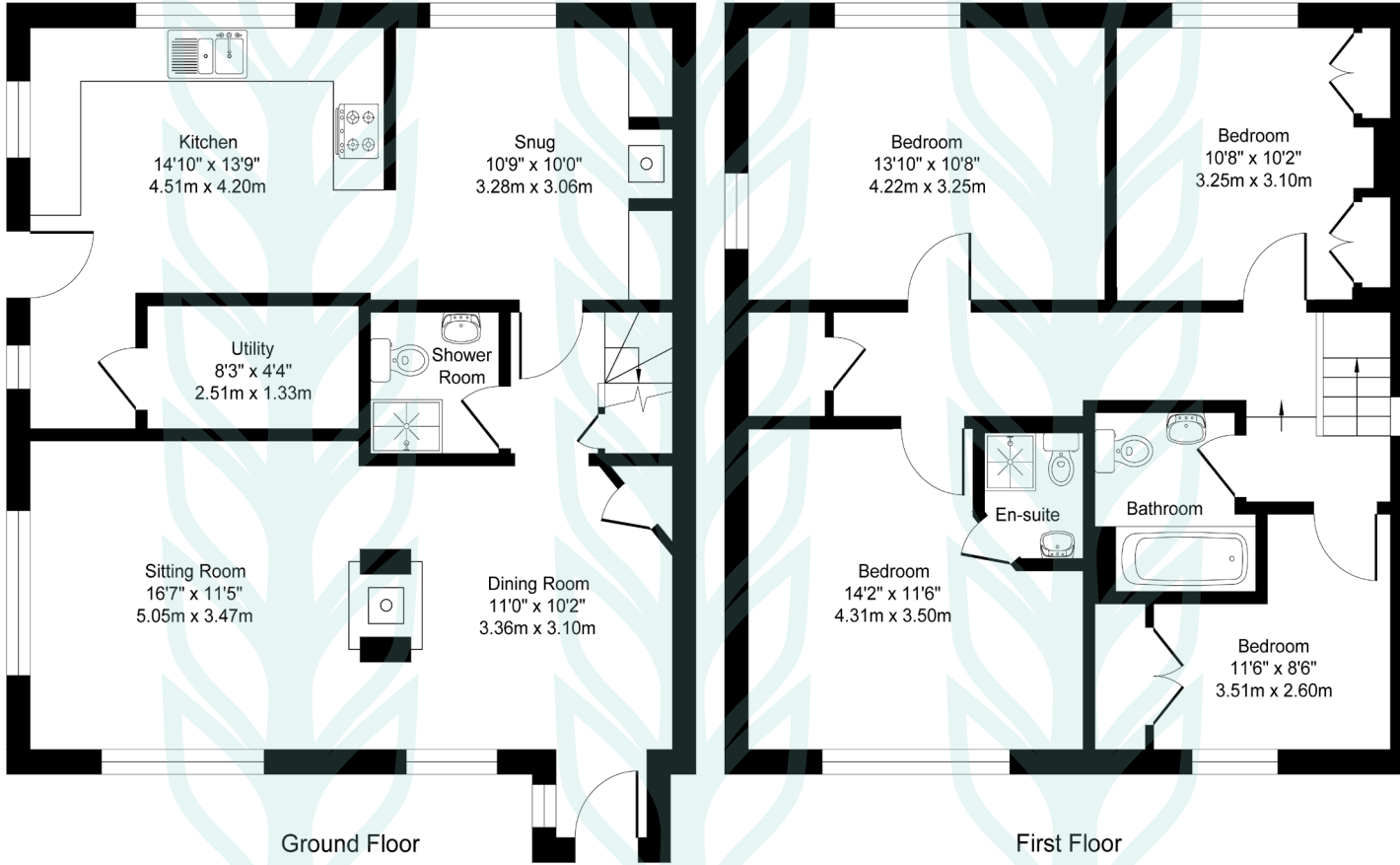

Illustration for identification purposes only, measurements approximate, not to scale. Copyright

Chapman Stickels

The Corn Exchange,
Market Place,
Hadleigh,
Suffolk,
IP7 5DN

info@chapmanstickels.co.uk
www.chapmanstickels.co.uk

01473 372 372

All enquiries:

Benedict Stickels
ben@chapmanstickels.co.uk

Cleo Shiel
cleo@chapmanstickels.co.uk

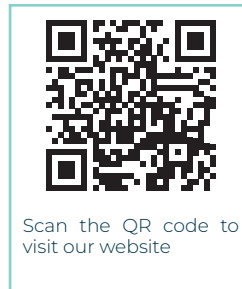

Scan the QR code to
visit our website

rightmove

OnTheMarket.com

Zoopla

PrimeLocation.com

IMPORTANT NOTICE
Chapman Stickels states these particulars are for general information only and do not constitute an offer or contract or part thereof. All descriptions, photographs and plans are for guidance only and should not be relied upon as statements or representations of fact. All measurements are approximate where stated. Any prospective purchaser must satisfy themselves of the accuracy of the information within these particulars by inspection or otherwise. Chapman Stickels does not have any authority to give any representations or warranties whatsoever in relation to this property (including but not limited to planning/building restrictions), nor can it enter into any contract on behalf of the client. We do not accept responsibility for any expenses incurred by prospective purchasers in inspecting properties which have been sold, let or withdrawn. If there is anything of particular importance to you, please contact us where we will endeavour to have any information or queries checked.