



# Sheridan Court

47 Belsize Road, NW6

£3,600 per month  
(£830.77 per week)

A 3 bedroom 1st floor apartment in this purpose built block benefiting from wood floors throughout, plenty of storage, lift, balcony and day porter. The property is situated in an excellent location, moments' away from the shops and restaurants of Fairfax Road, walking distance to Swiss Cottage (Jubilee Line) and the amenities of Finchley Road. Accommodation comprises double reception room, high spec fully fitted kitchen, master bedroom with fully fitted wardrobes and en-suite shower room, 2 further double bedrooms, family bathroom, separate utility room.

**CHESTERTONS**



# Sheridan Court

47 Belsize Road, NW6

- 1st Floor Apartment in Purpose Built Block
- 3 Bedrooms, 2 Bathroom, Reception, Kitchen
- Wood Floors, Balcony, Lift, Day Porter, Plenty of Storage
- Situated Moments' Away from Shops/Restaurants of Fairfax Road, Walking Distance to Swiss Cottage (Jubilee Line) and Amenities of Finchley Road



**Deposit Required:** £4,153.85  
**Local Authority:** London Borough Of Camden  
**Council Tax Band:** E  
**EPC Rating:** B  
**Furnished**

Energy Efficiency Rating		Current	Potential
Very energy efficient - lower running costs	A		
(91-101)	B	83	83
(81-90)	C		
(69-80)	D		
(55-68)	E		
(39-54)	F		
(21-38)	G		
Not energy efficient - higher running costs			
England, Scotland & Wales		EU Directive 2002/91/EC	

### *Chestertons Hampstead Lettings*

55-56 Hampstead High Street  
 Hampstead  
 London  
 NW3 1QH  
[hampsteadlettingsusers@chestertons.co.uk](mailto:hampsteadlettingsusers@chestertons.co.uk)  
 02077941125  
[chestertons.co.uk](http://chestertons.co.uk)

Additional tenant charges apply (fees apply to non-AST tenancies only)  
 Tenancy Agreement Fee: £300  
 References per Tenant/Guarantor: £60  
 Inventory check (approx. £100 – £250 inc. VAT)  
[chestertons.co.uk/property-to-rent/applicable-fees](http://chestertons.co.uk/property-to-rent/applicable-fees)

# Sheridan Court, Belsize Road, NW6

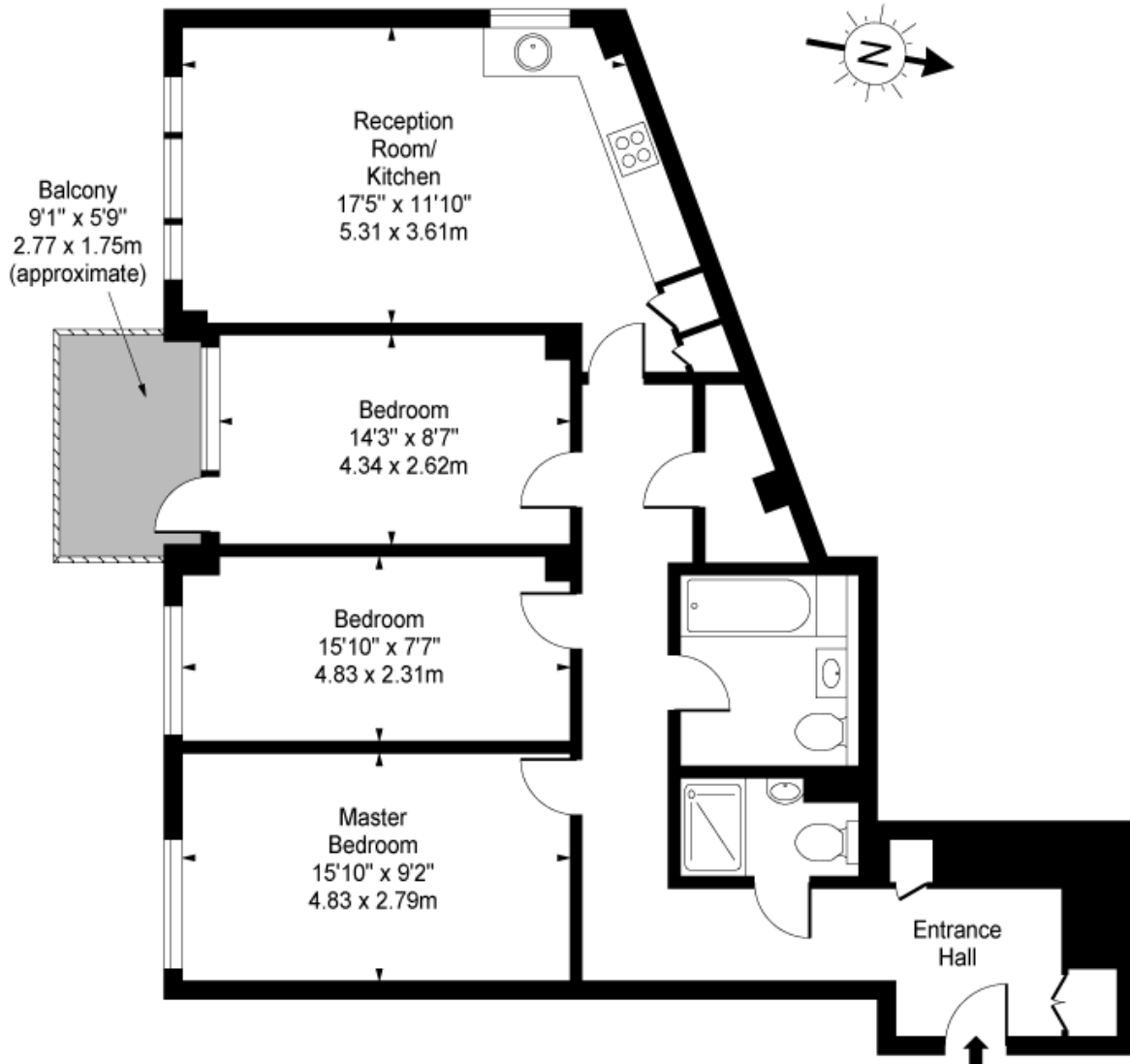

First Floor

Approx Gross Internal Area **975 Sq Ft - 90.58 Sq M**

For Illustration Purposes Only - Not To Scale

[www.goldlens.co.uk](http://www.goldlens.co.uk)

Prepared for Chestertons

Ref. No. 002222

