

# ST. CHADS AVENUE

PORTSMOUTH | HAMPSHIRE | PO2 0SB



£350,000

Freehold

- Popular Hilsea Location
- Three Double Bedrooms
- Open Plan Kitchen/Dining Area
- Utility Area With WC
- South Facing Rear Garden
- Completely Refurbished Throughout
- Deceptively Spacious
- Close To Local Amenities





## In Brief

Situated on the ever popular St Chads Avenue in Hilsea is this deceptively spacious three bedroom family home, just a short stroll from the local amenities.

The property has been lovingly refurbished by the current owners, yet retains some character features. Upon entering, you are welcomed by a spacious hallway, leading to the living room with its big bay windows and ornate ceiling rose and cornicing, adjoining is a second reception area, a versatile space for any family. The ground floor has been extended at the rear creating an open plan kitchen/dining area with patio doors opening out to the rear garden, a fabulous space for entertaining. A handy utility room and WC with access to the garden completes the downstairs accommodation. Upstairs, the property boasts three double bedrooms and a well appointed family bathroom with bath and walk-in shower.

The South facing rear garden offers a good degree of privacy with an area of artificial lawn and patio adjoining the rear of the house, ideal for the sunny Summer evenings with a handy brick built shed for all your storage needs.

This delightful home combines space, comfort and location, we recommend viewing to truly appreciate the quality of accommodation on offer.

£350,000

## KEY FACTS

Council Tax Band - C

EPC Rating - C

Approximate Internal Area = 1486 Sq Ft



# ST. CHADS AVENUE

PORTSMOUTH | HAMPSHIRE | PO2 0SB



Approximate Gross Internal Floor Area = 138.0 sq m / 1486 sq ft

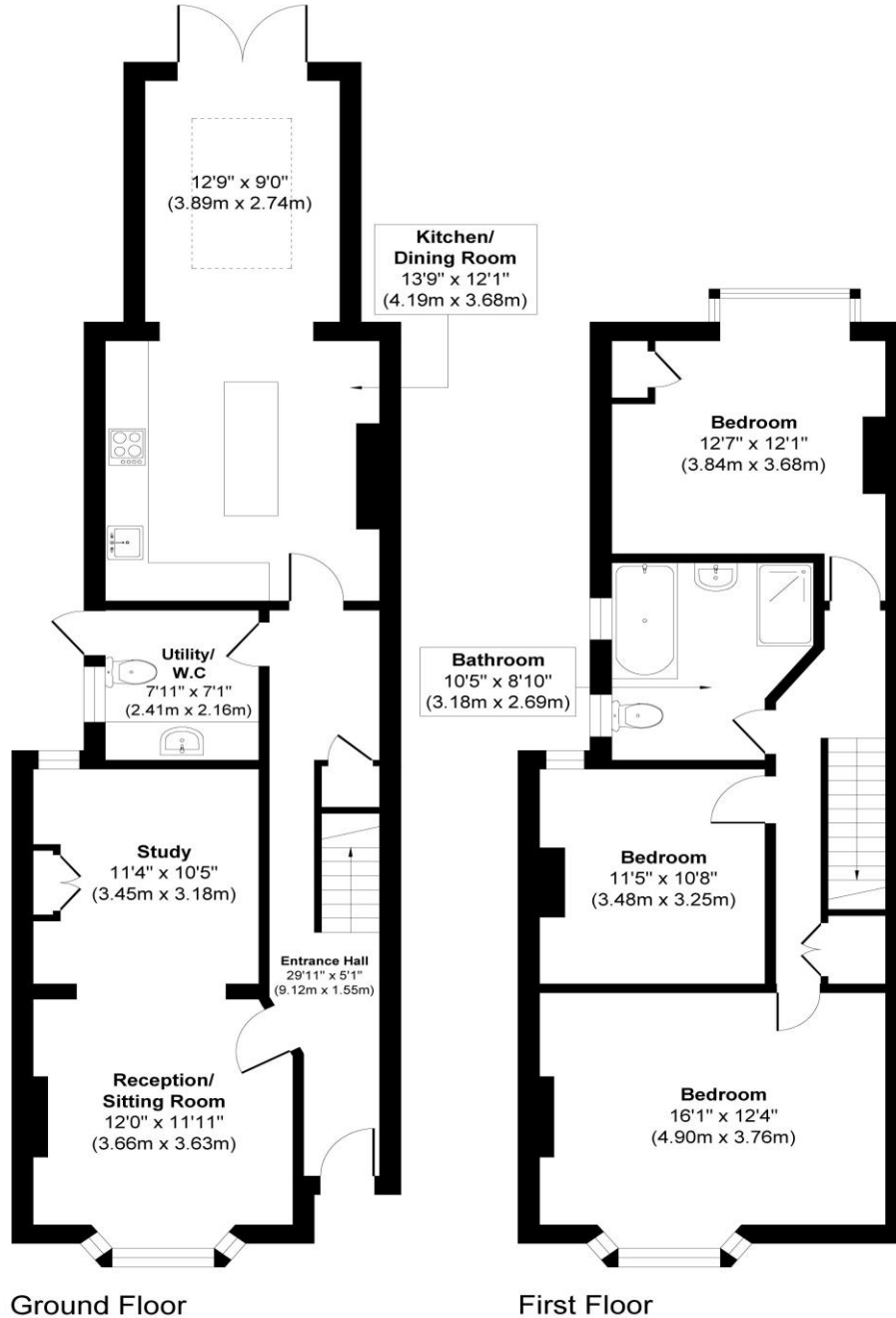

Illustration for identification purposes only, measurements are approximate, not to scale.

Southsea  
Sales & Lettings  
7/9 Stanley Street,  
Southsea, PO5 2DS  
Tel: 023 9281 5221

Old Portsmouth & Gunwharf Quays  
Sales & Lettings  
The Seagull, 13 Broad Street,  
Old Portsmouth, PO1 2JD  
Tel: 023 9281 5221

Drayton & Out of Town  
Sales & Lettings  
139 Havant Road,  
Drayton, PO6 2AA  
Tel: 023 9221 0101

London  
Sales & Lettings  
Mayfair Office, Cashel House,  
15 Thayer Street, W1U 3JT  
Tel: 0870 112 7099

Southsea  
Admin Centre  
12 Marnion Road,  
Southsea, PO5 2BA  
Tel: 023 9282 2300

[www.fryandkent.com](http://www.fryandkent.com)