



St. Johns Road, Eastleigh, SO50 4GX

welcome to

St. Johns Road, Eastleigh

This charming one-bedroom ground-floor maisonette offers a warm and inviting feel throughout.

The home features a delightful country-style kitchen with generous workspace and natural character, along with a pantry, leading through to a cosy living room centred around a striking large open fireplace—perfect for creating a homely atmosphere.

The spacious double bedroom benefits from a bay window that brings in plenty of natural light, while the well-laid-out bathroom completes the interior. Thoughtfully arranged rooms provide an easy flow and a sense of openness.

Outside, the property boasts its own private driveway with space for multiple cars, a rare advantage that adds both convenience and flexibility.

Ideal for first-time buyers, downsizers, or anyone seeking a comfortable home with character, this maisonette blends rustic charm with practical living in a well-connected location.



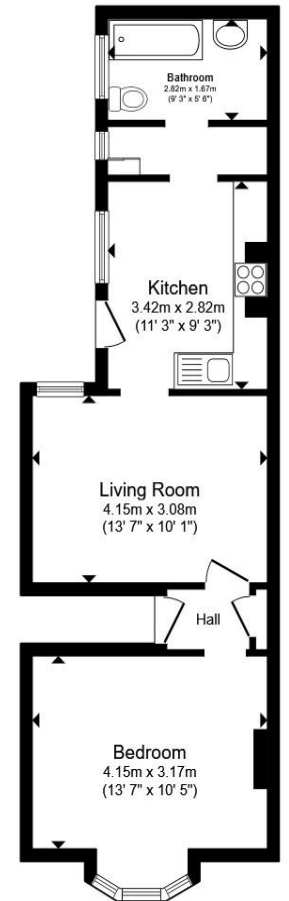

Ground Floor

Total floor area 46.5 m² (500 sq.ft.) approx

This floor plan is for illustrative purposes only. It is not drawn to scale. Any measurements, floor areas (including any total floor area), openings and orientation are approximate. No details are guaranteed, they cannot be relied upon for any purpose and they do not form part of any agreement. No liability is taken for any error, omission or misstatement. A party must rely upon its own inspection(s). Powered by www.propertybox.io



Front Garden

Bedroom One

13' 7" x 10' 5" (4.14m x 3.17m)

Kitchen

11' 3" x 9' 3" (3.43m x 2.82m)

Pantry

Bathroom

9' 3" x 5' 6" (2.82m x 1.68m)

Rear Garden

Parking

welcome to

St. Johns Road, Eastleigh

- GROUND FLOOR
- WORKING OPEN FIRE IN LOUNGE
- DRIVEWAY TO FRONT
- ENCLOSED GARDEN
- PANTRY

Tenure: Leasehold EPC Rating: D

Council Tax Band: A Service Charge: Ask Agent

Ground Rent: 5.00

This is a Leasehold property with details as follows; Term of Lease 125 years from 01 Jan 2004. Should you require further information please contact the branch. Please Note additional fees could be incurred for items such as Leasehold packs.

Directions to this property:

Fox and Sons Estate Agents Eastleigh
44 Market St, Eastleigh SO50 5RA

Head towards Regal Walk

Turn left onto Wells Pl

At the roundabout, take the 1st exit onto Southampton Rd/A335

Go through 1 roundabout

Turn left onto Shakespeare Rd

Turn right onto St John's Rd your destination will be on the right



Please note the marker reflects the postcode not the actual property

view this property online fox-and-sons.co.uk/Property/ELH107033



Property Ref:
ELH107033 - 0003

1. MONEY LAUNDERING REGULATIONS Intending purchasers will be asked to produce identification documentation at a later stage and we would ask for your co-operation in order that there is no delay in agreeing the sale. 2. These particulars do not constitute part or all of an offer or contract. 3. The measurements indicated are supplied for guidance only and as such must be considered incorrect. Potential buyers are advised to recheck measurements before committing to any expense. 4. We have not tested any apparatus, equipment, fixtures or services and it is in the buyers interest to check the working condition of any appliances. 5. Where an EPC, or a Home Report (Scotland only) is held for this property, it is available for inspection at the branch by appointment. If you require a printed version of a Home Report, you will need to pay a reasonable production charge reflecting printing and other costs. 6. We are not able to offer an opinion either written or verbal on the content of these reports and this must be obtained from your legal representative. 7. Whilst we take care in preparing these reports, a buyer should ensure that his/her legal representative confirms as soon as possible all matters relating to title including the extent and boundaries of the property and other important matters before exchange of contracts.

fox & sons



023 8061 8522



Eastleigh@fox-and-sons.co.uk



44 Market Street, EASTLEIGH, Hampshire, SO50 5RA



fox-and-sons.co.uk