



WESTWOODLEBER

**WESTWOODLEBER**  
LET US GUIDE YOU HOME

Bowsher Court, Ware, SG12 7EB  
£277,500



## Bowsher Court, Ware, SG12 7EB

Westwood Leber are delighted to present this well-presented and larger than average two-bedroom second floor apartment, ideally situated in Ware town centre, within easy walking distance of the High Street, a wide range of amenities, and the mainline station providing direct access to London Liverpool Street.

The property offers spacious and well-balanced accommodation throughout, including a generous living/dining area and a fully integrated kitchen. There are two well-proportioned bedrooms, with the principal bedroom benefitting from an en-suite shower room, in addition to a further family bathroom.

Further benefits include gas central heating, a secure entry phone system, lift access to all floors, and gated/secure allocated parking. The property also benefits from a lease in excess of 100 years.

This is a rarely available apartment and is offered CHAIN FREE. An internal viewing is highly recommended to fully appreciate the space and quality on offer.



**WESTWOODLEBER**

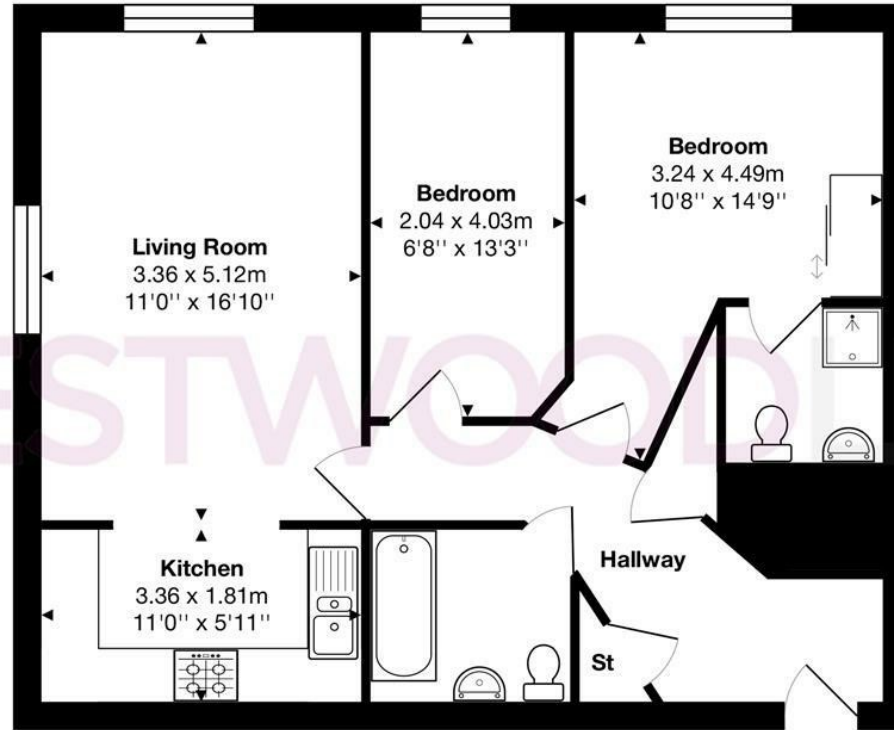

Total Area: approx. 62.2 m<sup>2</sup> ... 669 ft<sup>2</sup>

THE FLOORPLAN IS FOR ILLUSTRATIVE PURPOSES ONLY AND IS NOT TO SCALE.  
 Measurements and features are approximate and may differ from the actual property. Verify all details independently; no liability is accepted for errors or omissions.

Property marketing provided by [www.fotomarketing.co.uk](http://www.fotomarketing.co.uk)









**WLI WESTWOODLEBER**

**WLI WESTWOODLEBER**  
LET US GUIDE YOU HOME