



**POOLE
TOWNSEND**

54 Mountbarrow Road,
£299,500

3 1 2



- Wonderful link-detached home
- 2 reception rooms
- Kitchen, downstairs w.c and conservatory
- 3 bedrooms
- Attached garage and driveway
- Sought after Croftlands location
- Close to local amenities
- No upper chain
- Attractive gardens to front and rear
- Freehold and council tax band D



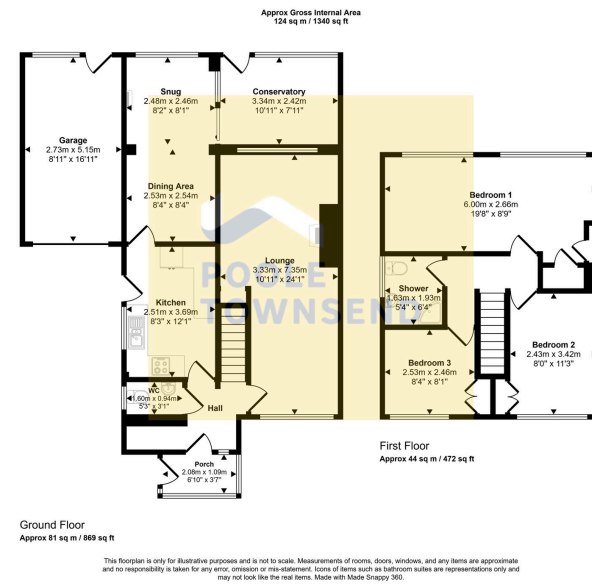

Occupying a desirable position within the popular Croftlands area of town, this well-maintained link-detached home offers convenient access to local amenities, schools and transport links. The accommodation includes a lounge with feature fireplace, a fitted kitchen with integrated appliances, a dining room opening into a snug, conservatory, and a ground-floor WC. Upstairs are three bedrooms, all with built-in storage, and a shower room. Outside, the property benefits from a colourful front garden, driveway, attached garage and an attractive rear garden with lawn, patio and established borders. Offering excellent potential for updating and personalisation, this is an ideal opportunity to create a comfortable long-term home in a sought-after residential location.

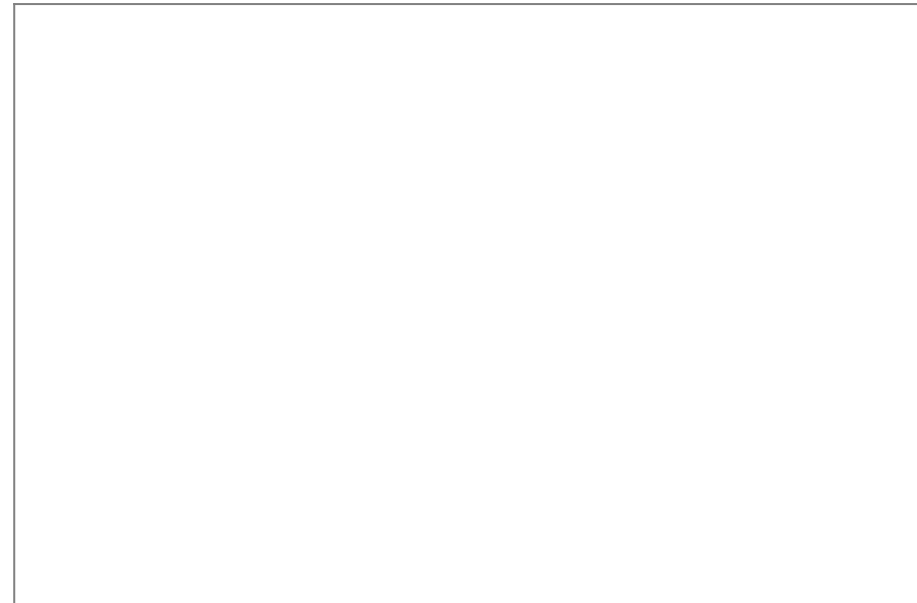

Visit us at
www.pooletownsend.co.uk
enquiries@pooletownsend.co.uk

We are open
 Monday – Friday 9.00 – 5.00
 Saturday 9.00 – 1.00

Barrow 01229 811811
 Ulverston 01229 588111
 Grange 015395 33316
 Kendal 01539 734455
 Milnthorpe 015395 62044