



Queens Court, Wormley, EN10 6JL |
£227,000 |

Queens Court, Wormley, EN10 6JL

Stunning spacious one bedroom first floor maisonette situated in a quiet development just off Wormley High Road. The current owner has fully refurbished this property to a high standard, with new kitchen, bathroom & bedroom fittings supported by new boiler, new electrics, new gas works and new plumbing for the bathroom. An allocated car space ensures stress free parking. This is a very bright and welcoming home that will suit first time buyers and investors alike. Wormley local shops, take aways, restaurants, pharmacy, country and riverside walks just a few minutes walk away. A short drive or a comfortable walk is Broxbourne train station with its rapid links to Tottenham Hale and Liverpool Street. The Cheshunt Brookfield Shopping Centre is just over a mile away.

- Stunning One Bedroom First Floor Maisonette
- Spacious and bright accommodation
- Gas central heating
- Local shops a few minutes away and Brookfield Shopping Centre 1.2m
- Fully refurbished by current owner with new kitchen, bathroom and bedroom fittings
- Allocated Parking Space

Property Information

Tenure Leasehold

Council Tax C EPC Rating C

Local Authority Broxbourne Borough Council

Lease Length 89 Years

Service Charge & Ground Rent



hoddesdon@paulwallace.co.uk

01992 466471





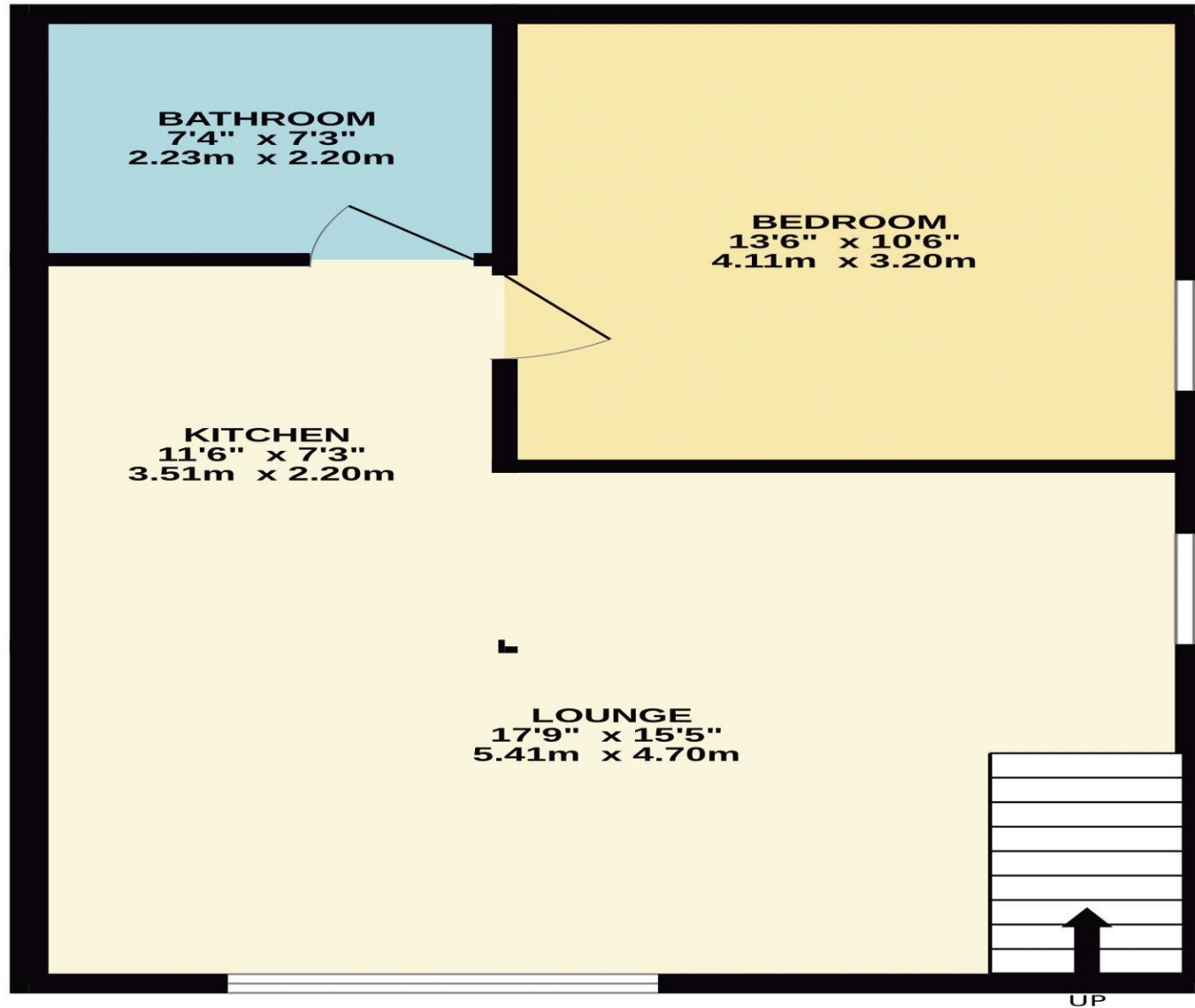

TOTAL FLOOR AREA : 513 sq.ft. (47.6 sq.m.) approx.

Whilst every attempt has been made to ensure the accuracy of the floorplan contained here, measurements of doors, windows, rooms and any other items are approximate and no responsibility is taken for any error, omission or mis-statement. This plan is for illustrative purposes only and should be used as such by any prospective purchaser. The services, systems and appliances shown have not been tested and no guarantee as to their operability or efficiency can be given.
Made with Metropix ©2025





Paul Wallace Estate Agents

70 High Street
Hoddesdon
Hertfordshire
EN11 8ET

 01992 466471

 hoddesdon@paulwallace.co.uk

 www.paulwallace.co.uk



Opening Times

Mon	9am to 6.30pm
Tues	9am to 6.30pm
Wed	9am to 6.30pm
Thurs	9am to 6.30pm
Fri	9am to 6.30pm
Sat	9am to 5.00pm
Sun	Closed



Agents Note: Whilst every care has been taken to prepare these sales particulars, they are for guidance purposes only. All measurements are approximate and are for general guidance purposes only and whilst every care has been taken to ensure their accuracy, they should not be relied upon. Potential buyers are advised to recheck the measurements.