



**Wentworth Drive, Ipswich, IP8 3RX**

**welcome to**

## **Wentworth Drive, Ipswich**

Situated in the ever-popular Pinewood area of Ipswich, this well-presented two-bedroom mid-terraced home on Wentworth Drive offers comfortable, practical living ideal for First Time buyers, investors or those looking to downsize.

### **Agents Note:**

\*Section 21- this vendor is a connected person to William H brown Estate Agents.

### **Entrance Hallway**

A welcoming entrance hallway providing space for coats and footwear along with access to the main living accommodation.

### **Living Room**

Positioned at the front of the property, the living room is bright and welcoming, with a large window allowing plenty of natural light. The space is well-proportioned and easily accommodates both lounge and entertaining furniture, creating a comfortable setting for everyday living.

### **Kitchen**

Located to the rear of the property, the fitted kitchen offers a range of eye and base units with complementary work surfaces, an inset sink and drainer and a washing machine (to remain). The layout provides excellent workspace and storage, with space for a dining table. French doors open directly onto the rear garden, allowing plenty of natural light to flow into the room and creating a seamless connection between indoor and outdoor living-ideal for entertaining and warmer months.

### **Main Bedroom**

A generously sized principal bedroom with ample space for a king size bed and additional bedroom furniture. The room benefits from good natural light and offers a comfortable retreat with built in wardrobe space and double-glazed window to the front.

### **Bedroom Two**

A well-proportioned second bedroom ideal for use as a guest room, child's bedroom, nursery or home office. The room offers flexibility to suit a variety of lifestyle needs with a double-glazed window to the rear.

### **Family Bathroom**

The bathroom is fitted with a three-piece suite comprising a panelled bath with shower attachment, low level WC and wash hand basin. Finished in neutral tones, the space is both functional and easy to maintain, with a double-glazed window to the rear and hanging towel radiator.

### **Outside:**

#### **Front Exterior**

To the front, the property enjoys an attractive residential setting with pathway access, a shingled front garden and off-street parking. The location is quiet and family-friendly, while remaining conveniently close to local amenities and transport links.

#### **Rear Garden**

Accessed via French doors from the kitchen, the private rear garden offers an excellent outdoor space for relaxing, entertaining, or family use. Predominantly laid to lawn with a patio seating area ideal for outdoor dining, the garden is designed for low maintenance while still offering plenty of scope for personalisation or further landscaping. A shed is included and will remain with the property, providing useful additional storage. The enclosed setting offers a good degree of privacy, making it an enjoyable space throughout the warmer months.

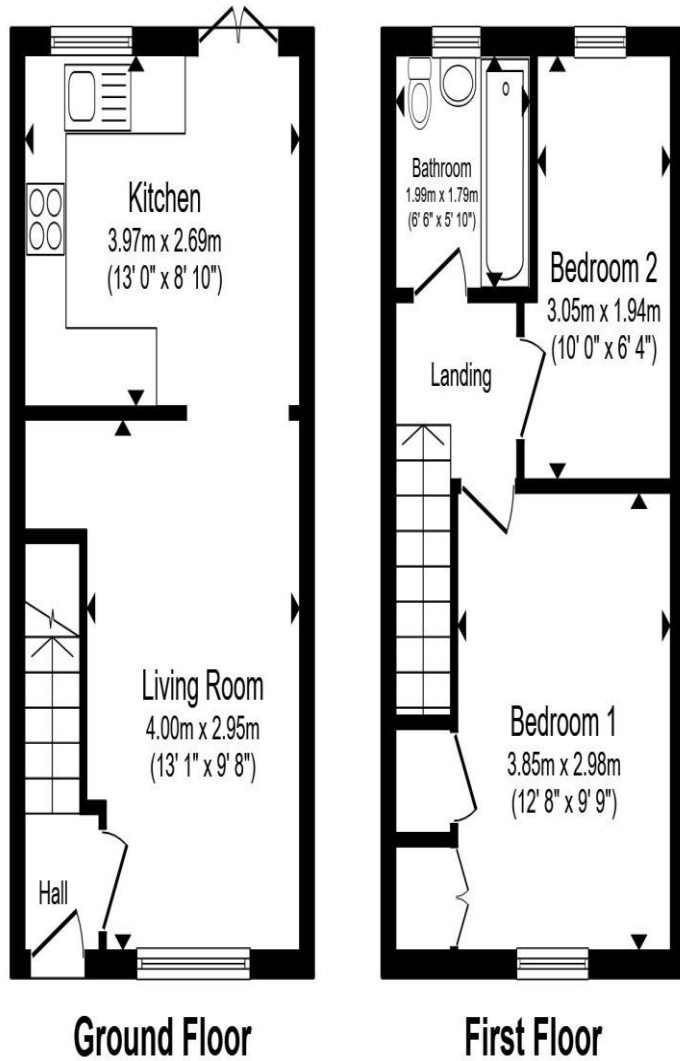

Total floor area 54.9 m<sup>2</sup> (591 sq.ft.) approx

This floor plan is for illustrative purposes only. It is not drawn to scale. Any measurements, floor areas (including any total floor area), openings and orientation are approximate. No details are guaranteed, they cannot be relied upon for any purpose and they do not form part of any agreement. No liability is taken for any error, omission or misstatement. A party must rely upon its own inspection(s). Powered by [www.propertybox.io](http://www.propertybox.io)



**welcome to**  
**Wentworth Drive,**  
**Ipswich**

- Two-bedroom mid-terrace home
- Private rear garden
- Off road parking for 2 vehicles
- Ideal First Time buy or investment
- Popular Pinewood location

Tenure: Freehold EPC Rating: Awaited  
Council Tax Band: B

**£210,000**



**view this property online** [williamhbrown.co.uk/Property/IPS121547](http://williamhbrown.co.uk/Property/IPS121547)



Property Ref:  
IPS121547 - 0002

1. MONEY LAUNDERING REGULATIONS Intending purchasers will be asked to produce identification documentation at a later stage and we would ask for your co-operation in order that there is no delay in agreeing the sale. 2. These particulars do not constitute part or all of an offer or contract. 3. The measurements indicated are supplied for guidance only and as such must be considered incorrect. Potential buyers are advised to recheck measurements before committing to any expense. 4. We have not tested any apparatus, equipment, fixtures or services and it is in the buyers interest to check the working condition of any appliances. 5. Where an EPC, or a Home Report (Scotland only) is held for this property, it is available for inspection at the branch by appointment. If you require a printed version of a Home Report, you will need to pay a reasonable production charge reflecting printing and other costs. 6. We are not able to offer an opinion either written or verbal on the content of these reports and this must be obtained from your legal representative. 7. Whilst we take care in preparing these reports, a buyer should ensure that his/her legal representative confirms as soon as possible all matters relating to title including the extent and boundaries of the property and other important matters before exchange of contracts.

William H Brown is a trading name of Sequence (UK) Limited which is registered in England and Wales under company number 4268443, Registered Office is Cumbria House, 16-20 Hockliffe Street, Leighton Buzzard, Bedfordshire, LU7 1GN. VAT Registration Number is 500 2481 05.



**william h brown**



**01473 226101**



[ipswich@williamhbrown.co.uk](mailto:ipswich@williamhbrown.co.uk)



16-18 Wolsey House, Princes Street, IPSWICH,  
Suffolk, IP1 1QT



**[williamhbrown.co.uk](http://williamhbrown.co.uk)**