



Leeds Road | Allerton Bywater | WF10 2DY

£185,000

Three Bedroom Mid Town House | Council Tax Band A | EPC Rating C

Emsleys | estate agents

*** THREE BEDROOM MID TOWN HOUSE * NO CHAIN! * DINING KITCHEN * SINGLE GARAGE & GARDENS ***

Located on Leeds Road in the charming village of Allerton Bywater, this excellent sized three-bedroom mid-terrace house presents an excellent opportunity for both first-time buyers and families seeking a comfortable home. The property offers a fantastic opportunity to mould the accommodation to your own style and decoration. Additionally, offered with NO CHAIN! means a smoother transition for prospective buyers, hopefully allowing for a quicker move-in date.

The property boasts a spacious lounge, perfect for relaxing and a well-appointed dining kitchen that invites family meals and gatherings. The three bedrooms offer ample space for rest and relaxation, making it an ideal setting for a growing family or those in need of a home office. The bathroom offers extra convenience, with an electric shower over the bath.

One of the standout features of this property is the single garage, providing valuable storage space or the potential for off-road parking. With the added benefit of double-glazing and gas central heating throughout, the home is not only energy-efficient but also provides a peaceful retreat from the hustle and bustle of daily life.

Situated in a friendly community, this home is well-connected to local amenities and transport links, making it a practical choice for those commuting to nearby towns or cities. This property is a wonderful blend of comfort, convenience, and potential, making it a must-see for anyone looking to settle in the Allerton Bywater area.





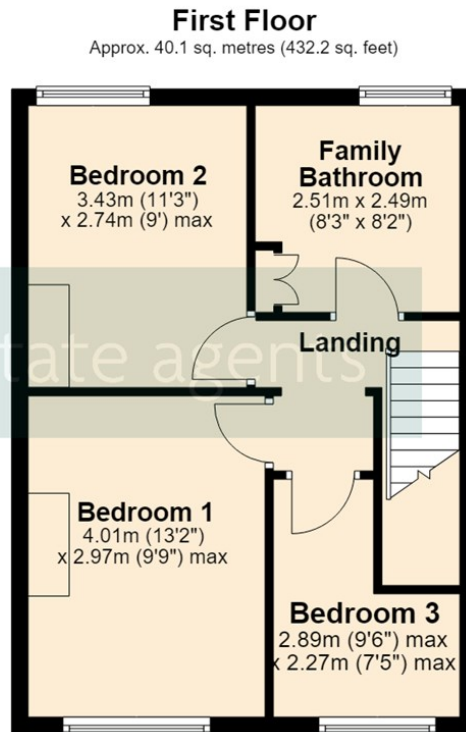
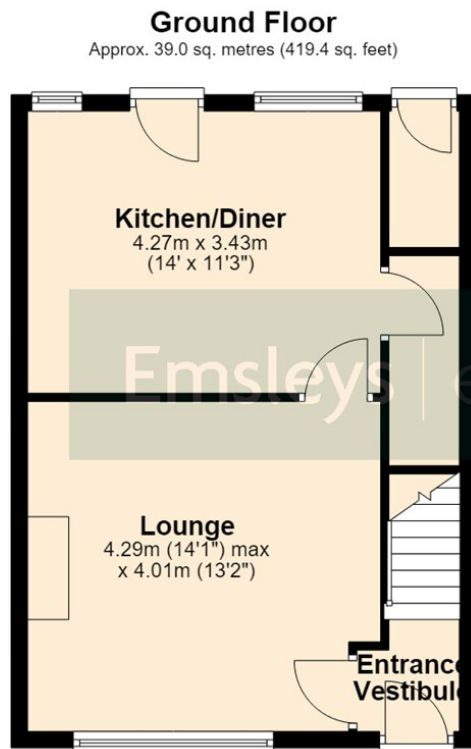

Total area: approx. 79.1 sq. metres (851.5 sq. feet)

These details are for guidance only and complete accuracy cannot be guaranteed. If there is any point, which is of particular importance, verification should be obtained. They do not constitute a contract or part of a contract. All measurements are approximate. No guarantee can be given with regard to planning permissions or fitness for purpose. No apparatus, equipment, fixture or fitting has been tested. Items shown in photographs are NOT necessarily included. Interested Parties are advised to check availability and make an appointment to view before travelling to see a property.



6 Main Street | Garforth | Leeds | LS25 1EZ

t: 0113 286 4000 www.emsleysestateagents.co.uk

Emsleys | estate agents