



Whitestone Way | | Croydon | CR0 4WL

£1,450 Per Calendar Month

BOND & SHERWILL
EST. 1908

Whitestone Way |
Croydon | CR0 4WL
£1,450 Per Calendar Month

Perfect for commuters this modern sixth-floor, one-bedroom apartment is ideally situated close to both Wandle Park & Wandle Park Tram Stop.

The interior benefits from a good-size bedroom, a bathroom and an open-plan lounge/kitchen. One particular highlight of this property is the balcony, which allows you to look out over the communal courtyard that makes Peebles Court such a favoured place to live.

Additional features this property benefits from include allocated parking, lift access and a concierge.

Wandle Park Tram Stop offers transport to a variety of destinations including Wimbledon, West Croydon & East Croydon, while buses are also available locally. Shopping facilities include Sainsbury's and Ikea while Central Croydon offers a wide-range of bars and restaurants.



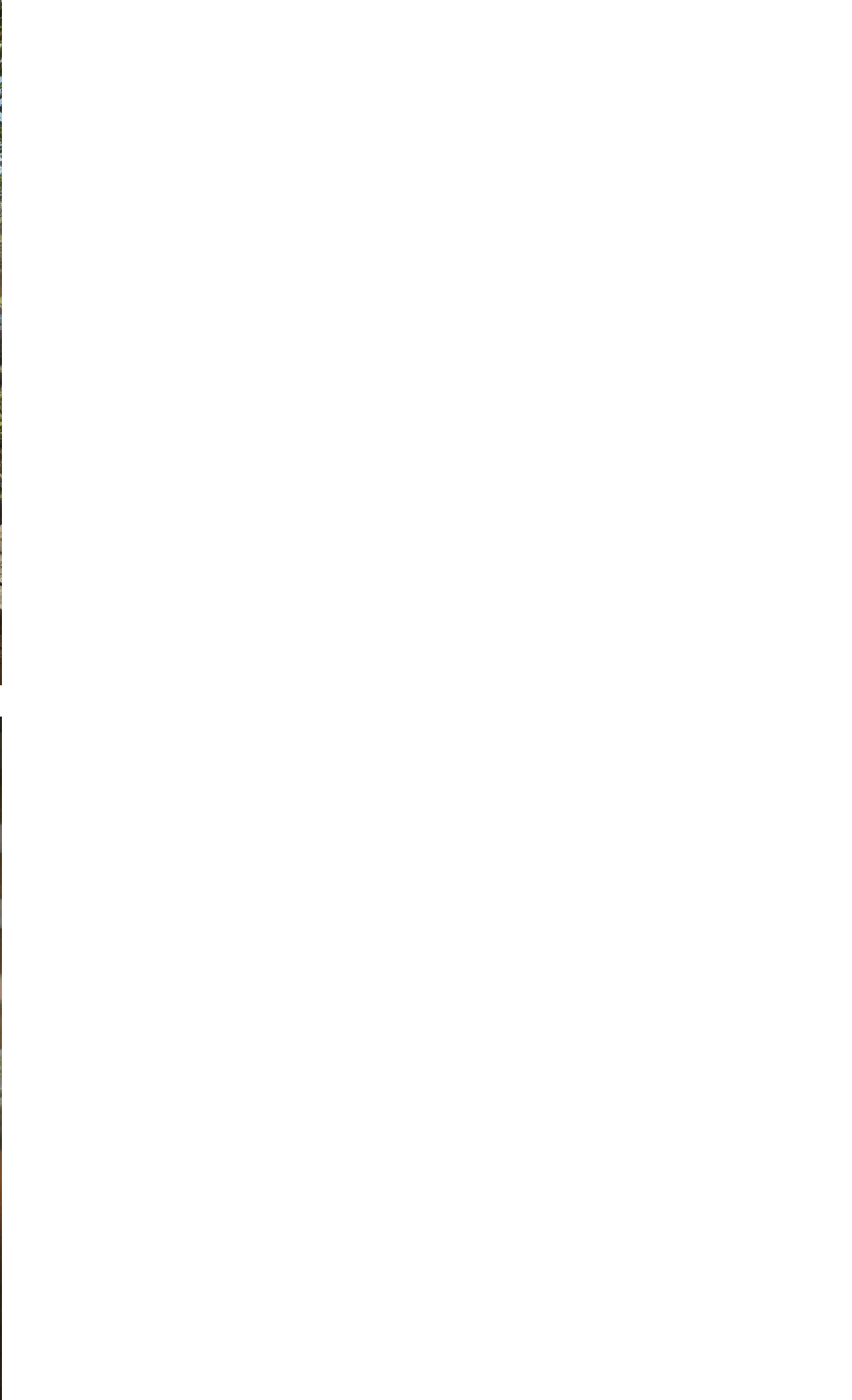



GROUND FLOOR
459 sq.ft. (42.7 sq.m.) approx.

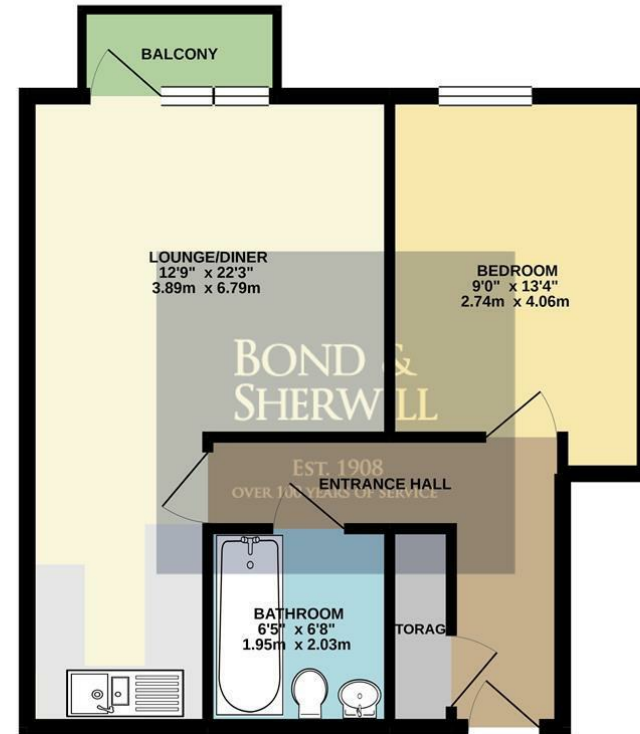

TOTAL FLOOR AREA : 459 sq.ft. (42.7 sq.m.) approx.
Whilst every attempt has been made to ensure the accuracy of the floorplan contained here, measurements of doors, windows, rooms and any other items are approximate and no responsibility is taken for any error, omission or mis-statement. This plan is for illustrative purposes only and should be used as such by any prospective purchaser. The services, systems and appliances shown have not been tested and no guarantee as to their operability or efficiency can be given.
Made with Metropix ©2020

Energy Efficiency Rating		Current	Potential
Very energy efficient - lower running costs			
(12 plus) A			
(11-11) B			
(10-10) C		76	77
(9-9) D			
(8-8) E			
(7-7) F			
(1-1) G			
Not energy efficient - higher running costs			
England & Wales		EU Directive 2002/91/EC	

Bond & Sherwill
134 Brighton Road
Coulston
Surrey
CR5 2ND
020 8660 0189

lettings@bondandsherwill.co.uk