

HJC

HIGHER VALUES



Williams Grove

Surbiton, KT6 5RP

Guide Price

£1,155,000

A truly spectacular extended end of terrace town house within the prestigious St James Development. This wonderful family home offers a spacious open plan kitchen / family room with bi-fold doors opening on to the pretty landscaped garden. There is also a handy utility room and downstairs W/C. Upstairs onto the 1st floor there is sizeable reception room with Juliette balcony and wood flooring along with guest double bedroom and shower room. The second floor houses the primary bedroom complete with en-suite shower, a further two bedrooms and family bathroom. Further benefits include underfloor heating in the kitchen, off street parking and close proximity to Surbiton town centre, mainline train station and the River Thames.

Material Info: Water / Electricity / Sewerage: Mains. Heating: Gas Mains. Broadband: Fibre (FTTC)

- Extended End of Terrace Town House
- Beautifully Presented
- Primary Bedroom with En-suite
- Stunning Kitchen / Family Room with Bi-Fold Doors
- Off Street Parking
- St James Development
- Four Bedrooms
- Shower Room and Family Bathroom
- Utility Room and Downstairs WC
- Close to Surbiton Town Centre, Mainline Station and the River Thames

Floor Plan



WILLIAMS GROVE, LONG DITTON
INTERNAL FLOOR AREA (APPROX.)
1590 sq ft/ 147.72sq m

Whilst every attempt has been made to ensure the accuracy of this floor plan, measurement of doors, windows, rooms and any other items are approximate and no responsibility is taken for any error, omission or mis-statement.
Made with Metropix © 2026.

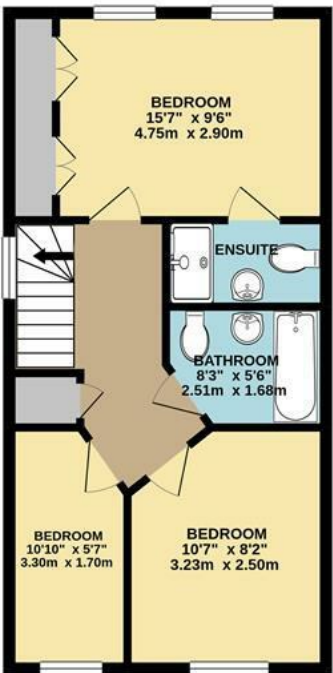
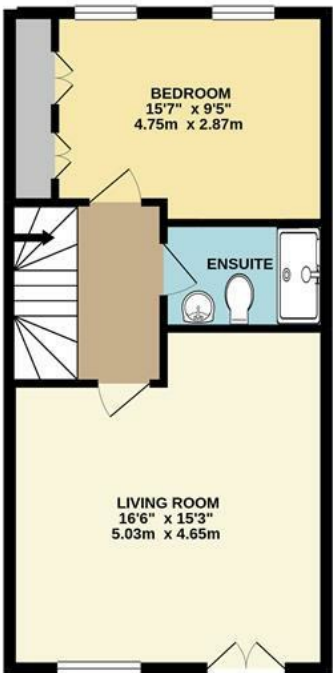

Energy Efficiency Graph

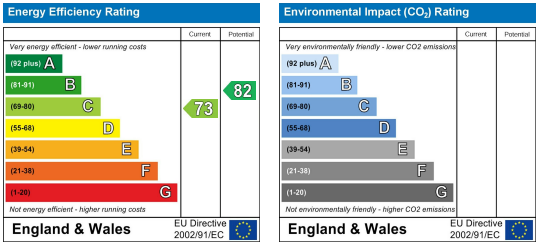

These particulars, whilst believed to be accurate are set out as a general outline only for guidance and do not constitute any part of an offer or contract. Intending purchasers should not rely on them as statements of representation of fact, but must satisfy themselves by inspection or otherwise as to their accuracy. No person in this firms employment has the authority to make or give any representation or warranty in respect of the property.