



All Souls Avenue, NW10

£2,600 Per calendar month

A modern and spacious two bedroom, two bathroom apartment with a private garden set on ground floor of a period conversion. The property benefits from a separate kitchen with wooden flooring throughout.

All Souls Avenue is located near to the shops, cafes and amenities of Chamberlayne Road and College Road and Queens Park is nearby. The closest station is Kensal Rise.

Features

- Two Double Bedrooms
- Two Bathrooms
- Private Garden
- Modern
- Separate Kitchen
- Wooden Flooring

All Souls Avenue, London, NW10

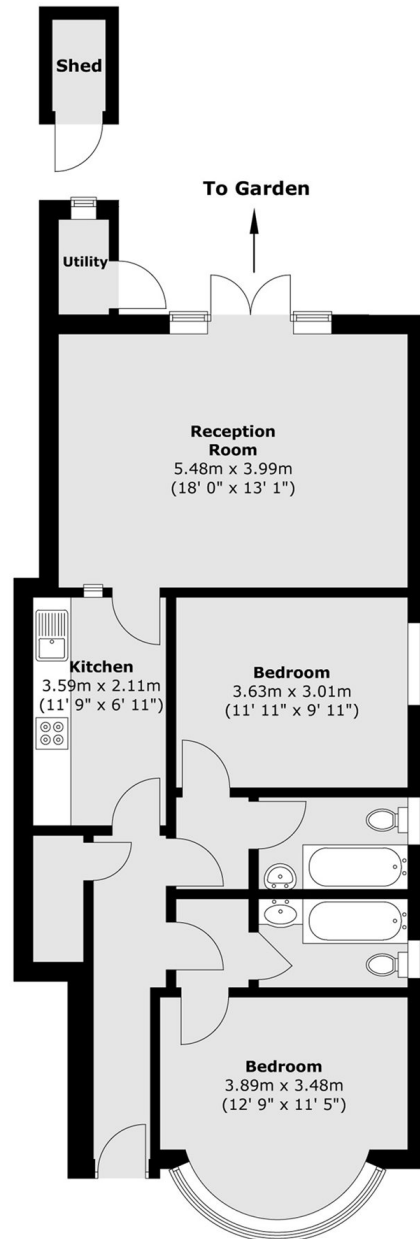

Total area (approx.) : 74.3 sq. m (800 sq. ft)
Total shed area (approx.) : 1.2 sq. m (13 sq. ft)
Total utility area (approx.) : 1.2 sq. m (13 sq. ft)