



Apartment

# APT 11, DORCHESTER APARTMENTS 2 LEE STREET, STOCKPOT, SK1 2EX7

Per Calendar Month

## £995 Per

FEATURES



## Wainwright and Edwards

Estate Agents - Letting Agents - Property Management

# 2 Bedroom Apartment located in Stockpot

An excellent opportunity to purchase this spacious and well presented ground floor apartment centrally located and convenient for rail links to Manchester city centre. The accommodation briefly comprises entrance hall, large open plan lounge and dining kitchen with integrated appliances and dual aspect windows. Two double bedrooms and shower room with modern white suite. Early viewing advised to appreciate the extent and quality of this property.

Call us on  
**01772-814863**

[lettings@wainwrightandedwards.co.uk](mailto:lettings@wainwrightandedwards.co.uk)  
<http://www.we-estateagents.com/>

Council Tax Band  
**D**

GROUND FLOOR  
733 sq.ft. (68.1 sq.m.) approx.

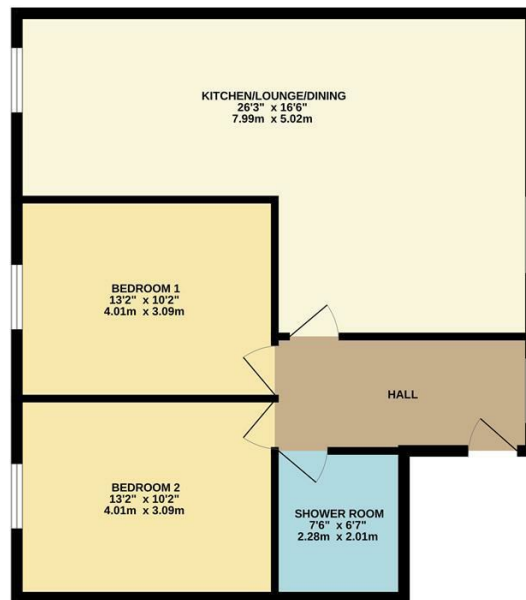

GROUND FLOOR TWO BED APARTMENT

TOTAL FLOOR AREA: 733 sq.ft. (68.1 sq.m.) approx.

Whilst every attempt has been made to ensure the accuracy of the floorplan contained here, measurements of doors, windows, rooms and any other items are approximate and its responsibility to take for any error, omission or mis-statement. This plan is for illustrative purposes only and should be used as such by any prospective purchaser. The services, systems and appliances shown have not been tested and the guarantee as to their operability or efficiency can be given. Made with Metropix 02025

Energy Efficiency Rating		Current	Potential
<i>Very energy efficient - lower running costs</i>			
(92 plus) <b>A</b>			
(81-91) <b>B</b>			
(69-80) <b>C</b>			
(55-68) <b>D</b>		55	55
(39-54) <b>E</b>			
(21-38) <b>F</b>			
(1-20) <b>G</b>			
<i>Not energy efficient - higher running costs</i>			
<b>England &amp; Wales</b>		EU Directive	
		2002/91/EC	

Agents Note: Whilst every care has been taken to prepare these particulars, they are for guidance purposes only. All measurements are approximate and are for general guidance purposes only and whilst every care has been taken to ensure their accuracy, they should not be relied upon and potential buyers are advised to recheck the measurements.

**Wainwright and Edwards**  
Estate Agents - Letting Agents - Property Management