



6 Lovejoy Lane, Windsor, Berkshire, SL4 4ND
Offers in excess of £250,000

 **HORLER**

6 Lovejoy Lane, Windsor, Berkshire, SL4 4ND

A well presented two bedroom first floor apartment that has recently been refurbished. The property comprises of a lounge, kitchen, two good size bedrooms, family bathroom, a separate WC and a good size entrance hallway with ample storage space. Well maintained communal ground and off road parking. Viewings are highly recommended! NO ONWARD CHAIN



Entrance

A good size entrance hall, a very large storage cupboard with power points and lighting, a radiator and doors into all rooms.

Lounge

With radiator, ample power points and a double glazed window.

Kitchen

A fully fitted kitchen with a double glazed window, a range of eye and base level white gloss units, stainless steel sink and drainer, complimentary wooden worktops, tiled splashback, integrated oven and four ring induction hob, extractor fan, wood effect laminate flooring and appliance space for a washing machine and fridge freezer.

Master bedroom

A double bedroom with a radiator, power points and a double glazed window.

Bedroom two

A double bedroom with a radiator, power points and a double glazed window.

Bathroom

A new bathroom suite comprising of a panel enclosed bath, pedestal wash hand basin, tiled walls and a double glazed frosted window.

WC

With a frosted window and a low level WC.

Lease info:

Lease: 88 years remaining approx

Service charge: £957.00 pa (with effect from 01Apr 2026)

Ground rent: £10 approx

PLEASE NOTE, PHOTOS HAVE BEEN TAKING PRIOR TENANCY STARTING

Legal note

Although these particulars are thought to be materially correct, their accuracy cannot be guaranteed and they do not form part of any contract.



Approximate Gross Internal Area
75.4 sq m / 812 sq ft

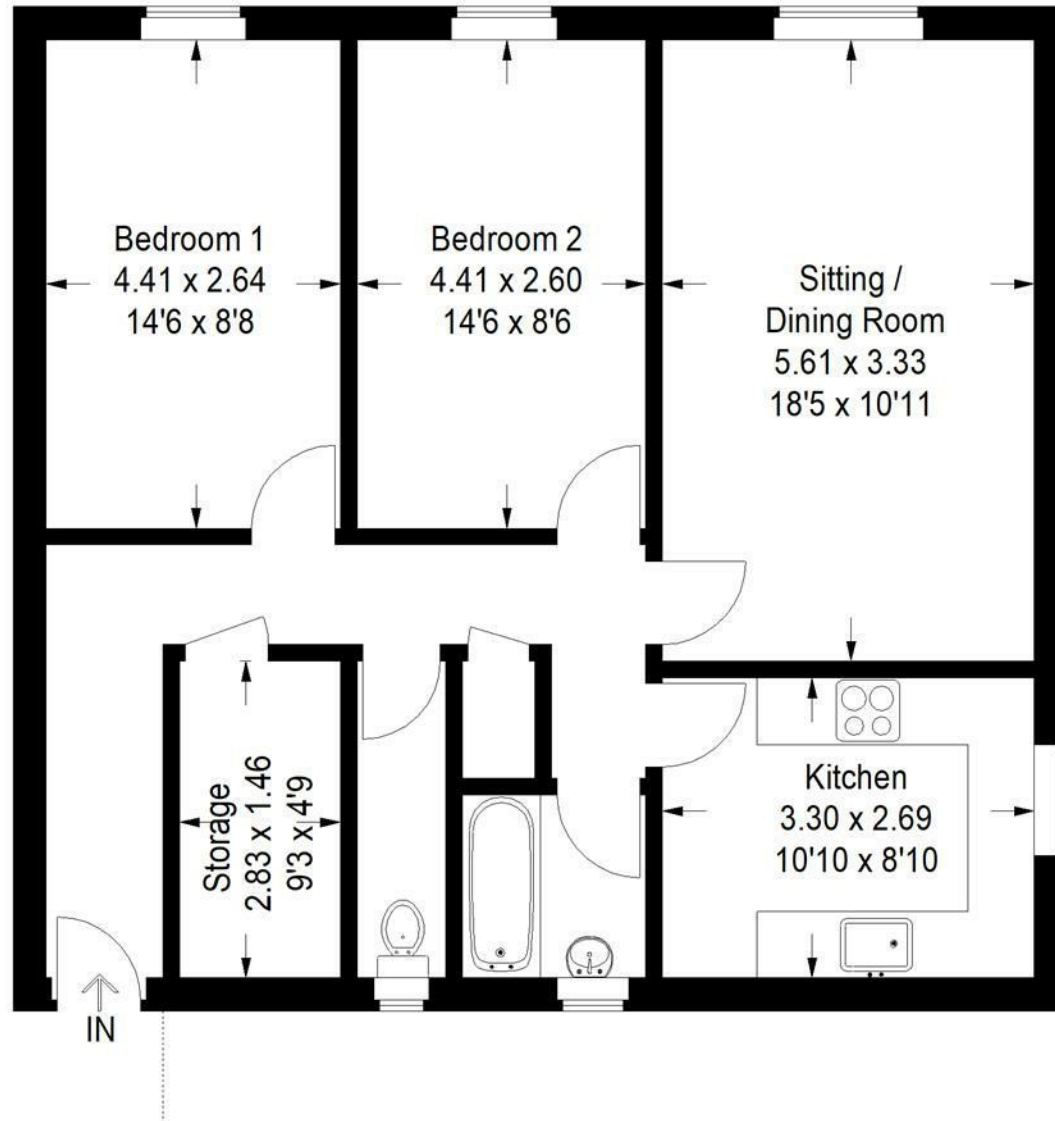

Illustration for identification purposes only, measurements are approximate, not to scale.