



Chelsea Cloisters, SW3

£1,600 Per week

A first floor studio apartment in a red brick mansion building located between Fulham Road and Kings Road with on site porter, perfect for single professionals and students.

Sloane Avenue is situated in the heart of Chelsea and moments from the King's Road and the Fulham Road making it ideally position for the many local amenities.

Features

- Studio Apartment
- Wood Flooring
- Separate Kitchen
- Sofa Bed
- Fitted Storage
- Modern Bathroom

Chelsea Cloisters, London, SW3

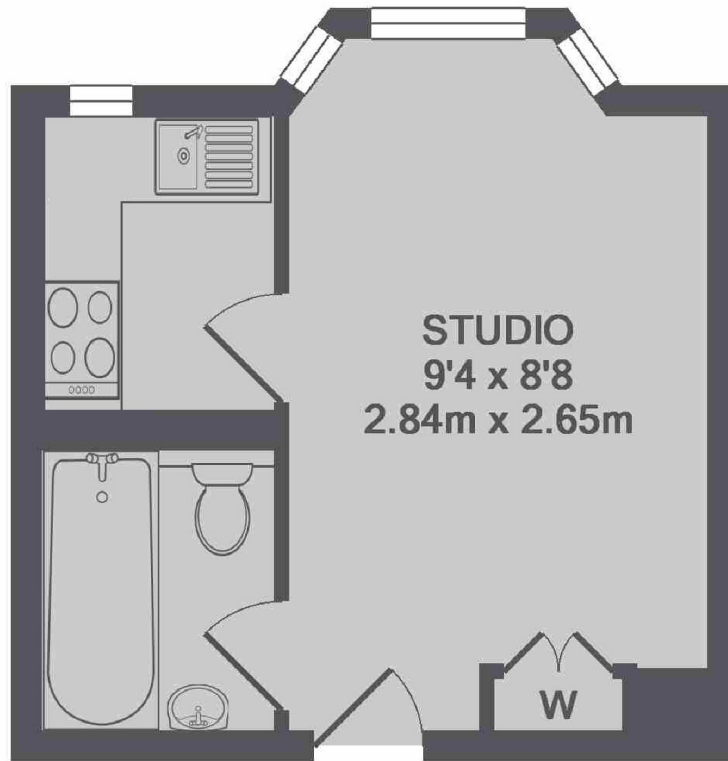

TOTAL APPROX. FLOOR AREA 210 SQ.FT. (19.5 SQ.M.)