



Kempton Park Road, Birmingham

burchell
edwards



Property Description

Burchell Edwards are delighted to present this spacious town house, located in the hodge hill area of Birmingham (B36). This well presented home boasts accommodation across three floors, perfect for a growing family,

To the ground floor the property in brief comprises an entrance porch, hallway and a garage, through the rest of the accommodation you get a lounge/ reception room with access to the garden, a large kitchen a W.C, three well-appointed bedrooms, a family bathroom and access to the loft space.

Outside, you will find a private rear garden with rear access. In addition, you will also discover off-road parking by-way-of a driveway.

Superbly located in close proximity to nearby schools, local shops and amenities. With the additional benefit of double glazing throughout, we would recommend an early viewing to be essential in order to appreciate the space and accommodation available.

Entrance Hallway

Door to front elevation, carpet and stairs to first floor accommodation.

Lounge

Double glazed window and door to rear elevation, central heating radiator and laminate flooring.

Kitchen

Double glazed window to front elevation, a range of wall and base units with work surface over incorporating a sink with drainer unit, gas hob, electric oven, extractor, tiling to splash prone areas, space and plumbing for washing machine, laminate flooring and central heating radiator.

Bedroom One

Double glazed window to rear elevation, central heating radiator and carpet.

Bedroom Two

Double glazed window to front elevation, central heating radiator and laminate flooring.

Bedroom Three

Double glazed rear elevation, central heating radiator and carpet.

Bathroom

Bath with shower over, wash hand basin, tiling to splash prone areas, central heating radiator.

W.C

W.C and tiled flooring.

Front Garden

Block paved driveway providing off road parking.

Rear Garden

Laid to lawn, paved patio area, shrubs and plants, rear access and brick built storage.







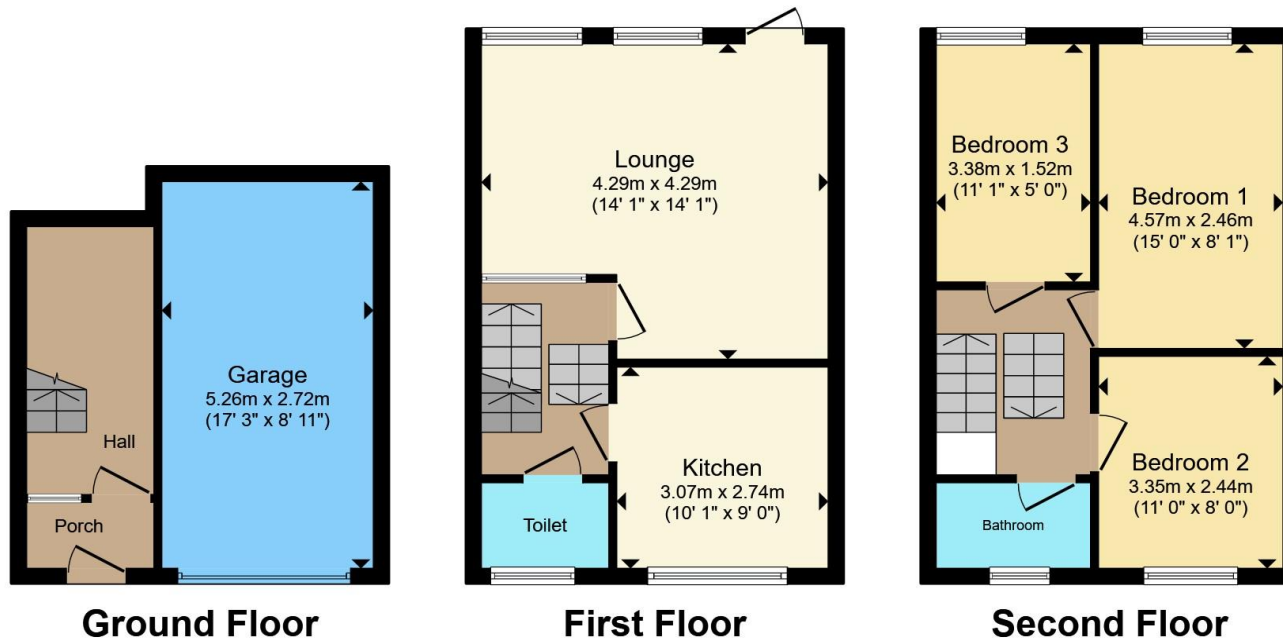

Total floor area 89.1 m² (959 sq.ft.) approx

This floor plan is for illustrative purposes only. It is not drawn to scale. Any measurements, floor areas (including any total floor area), openings and orientation are approximate. No details are guaranteed, they cannot be relied upon for any purpose and they do not form part of any agreement. No liability is taken for any error, omission or misstatement. A party must rely upon its own inspection(s). Powered by www.propertybox.io



To view this property please contact Burchell Edwards on

T 0121 749 7888
E castlebromwich@burchelledwards.co.uk

2-4 Hurst Lane
 BIRMINGHAM B34 7HR

EPC Rating: C Council Tax
 Band: B

Tenure: Freehold

view this property online burchelledwards.co.uk/Property/CBW210151



1. MONEY LAUNDERING REGULATIONS Intending purchasers will be asked to produce identification documentation at a later stage and we would ask for your co-operation in order that there will be no delay in agreeing the sale. 2. These particulars do not constitute part or all of an offer or contract. 3. The measurements indicated are supplied for guidance only and as such must be considered incorrect. Potential buyers are advised to recheck measurements before committing to any expense. 4. We have not tested any apparatus, equipment, fixtures, fittings or services and it is in the buyers interest to check the working condition of any appliances.

Burchell Edwards is a trading name of Connells Residential which is registered in England and Wales under company number 1489613, Registered Office is Cumbria House, 16-20 Hockliffe Street, Leighton Buzzard, Bedfordshire, LU7 1GN. VAT Registration Number is 500 2481 05.

See all our properties at www.burchelledwards.co.uk | www.rightmove.co.uk | www.zoopla.co.uk

Property Ref: CBW210151 - 0002