

# Osborne Road

CLIFTON

APPROXIMATE FLOOR AREA  
87.4 SQM / 940 SQFT



GROUND FLOOR  
940 sq.ft. (87.4 sq.m.) approx.

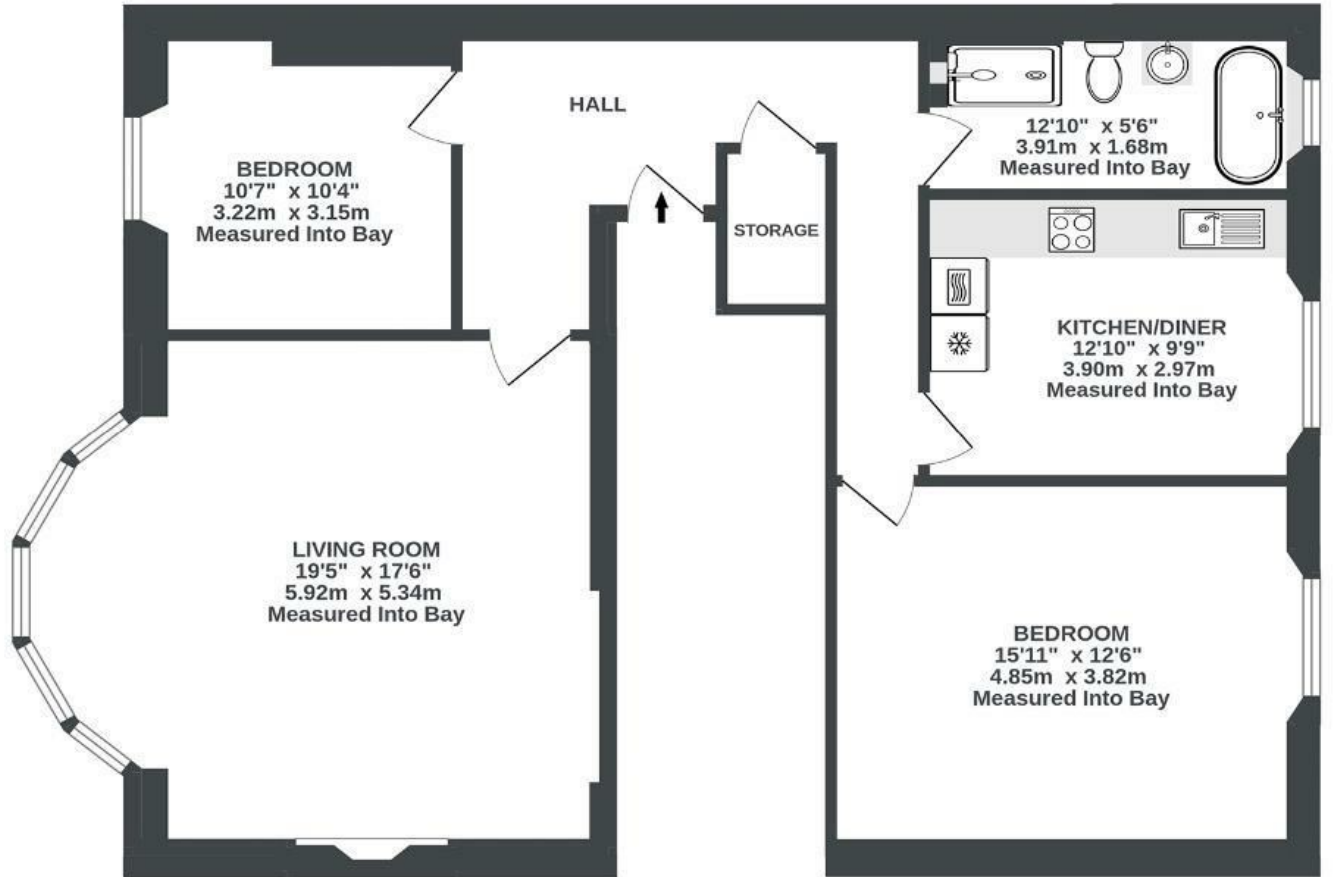

Illustrations are for reference purposes only, measurements are approximate, not to scale.

Boardwalk

# Osborne Road

CLIFTON, BRISTOL

£

£600,000

ZZZ

2 Bedrooms



BS8 2HA



1 Bathrooms

*"With sunlight pouring into the kitchen, a bright bay windowed living room and a peaceful garden oasis, this home feels a world away from the heart of Clifton."*

