



1a Tower Drive, Lincoln, LN2 5QD

Asking Price £185,000

- Secluded Detached Two Bedroom Bungalow
- Fully Fitted Kitchen
- Shower Room
- Council Tax Band A
- Newly Converted and Renovated Throughout
- Off Street Parking for a number of vehicles
- No Onward Chain
- Open Plan Living
- Electric Central Heating and Hot Water
- EPC Rating D

Ground Floor

Approx. 41.6 sq. metres (447.4 sq. feet)

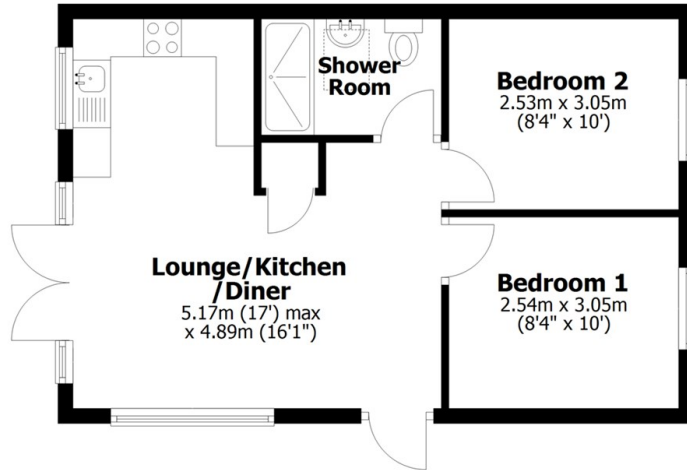

Total area: approx. 41.6 sq. metres (447.4 sq. feet)

This plan is for layout guidance only. Not drawn to scale unless stated. Windows and door openings are approximate. Whilst every care is taken in the preparation of this plan, please check all dimensions, shapes and any compass bearings before making any decisions reliant upon them. All interested parties must verify their accuracy independently.

Drewery Jones Independent Estate Agents
Plan produced using PlanUp.

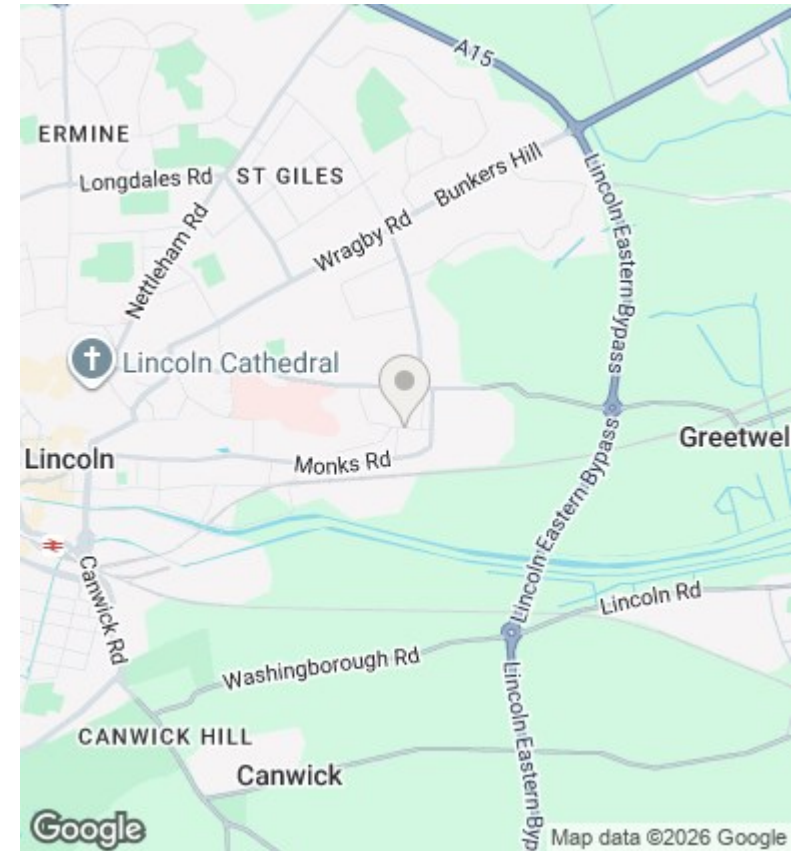

Directions

Viewings

Viewings by arrangement only. Call 01522 396059 to make an appointment.

Council Tax Band

C

EPC Rating:

D

Energy Efficiency Rating		Current	Potential
Very energy efficient - lower running costs			
(92 plus) A			
(81-91) B			
(69-80) C			73
(55-68) D		64	
(39-54) E			
(21-38) F			
(1-20) G			
Not energy efficient - higher running costs			
England & Wales		EU Directive 2002/91/EC	