



**Mottram Road
Stalybridge, SK15 2RT
Price £699,999**

OPEN DAY SATURDAY 28TH FEB 10:30 - 12:30

A rare opportunity awaits with the launch of an exclusive gated development comprising just seven high-specification new homes on the highly desirable Mottram Road in Stalybridge. Perfectly blending style, space, and luxury, this prestigious collection promises exceptional living in a sought-after setting.

The Bower is a beautifully designed four-bedroom detached family home offering generous and versatile accommodation spread across three impressive floors. Designed with modern lifestyles in mind, it combines thoughtful layout with premium finishes throughout. The property will feature a contemporary high-spec kitchen complete with sleek quartz worktops and top-of-the-range NEFF and AEG integrated appliances, ideal for both everyday living and entertaining. Bathrooms will be fitted with premium sanitaryware and finished with elegant Italian tiles for a touch of timeless sophistication.

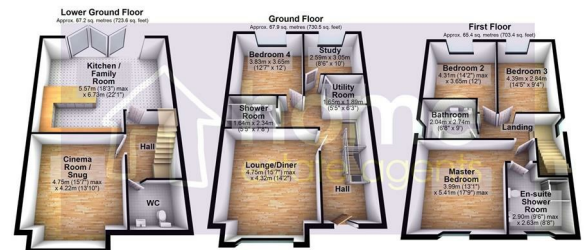

Total area: approx. 200.4 sq. metres (2157.5 sq. feet)