



Oriel Drive

Barnes, SW13

£3,800 per month
(£876.92 per week)

A stylish apartment, offered furnished, set on the first floor of a modern building in gated Harrods Village. The estate boasts allocated parking, lift access, a residents' gym and swimming pool, manicured communal gardens and 24-hour concierge.

Off the entrance hall, with ample storage and wood flooring, is a light and generous reception room with space for dining. There are double doors through to the kitchen, which is modern with integrated appliances. The principal bedroom is complete with fitted wardrobes and an en-suite bathroom with a freestanding bathtub and a walk-in shower. There is a second well-proportioned double bedroom and an additional shower room.

This property is conveniently located for pedestrian and cycle access across Hammersmith Bridge for commuting and for the delights of the Thames towpath. Local amenities are available on nearby Castelnau, along with several independent eateries and stores.

CHESTERTONS



Oriel Drive

Barnes, SW13

- Very Well-Presented First Floor Apartment
- Two Double Bedrooms & Two Bathrooms
- Allocated Parking
- Harrods Village Location
- Residents' Gym & Swimming Pool



Minimum Term: 12 months
Deposit Required: five weeks (£4,384.62)
Local Authority: London Borough of Richmond upon Thames
Council Tax Band: E
EPC Rating: B
Furnished

Energy Efficiency Rating		
	Current	Potential
Very energy efficient - lower running costs		
(92+) A		
(81-91) B	81	81
(69-80) C		
(55-68) D		
(39-54) E		
(21-38) F		
(1-20) G		
Not energy efficient - higher running costs		
England, Scotland & Wales EU Directive 2002/91/EC		

Chestertons Barnes Lettings

68-69 Barnes High Street
 Barnes
 London
 SW13 9LD
 lettings.barnes@chestertons.co.uk
 020 8748 7733
chestertons.co.uk

Additional tenant charges apply (fees apply to non-AST tenancies only)

Tenancy Agreement Fee: £300
 References per Tenant/Guarantor: £60
 Inventory Check: Approx. £100-£250 (inc. VAT)
chestertons.co.uk/property-to-rent/applicable-fees

Oriel Drive, Harrods Village, SW13

Approximate gross internal area
85 sq m / 915 sq ft

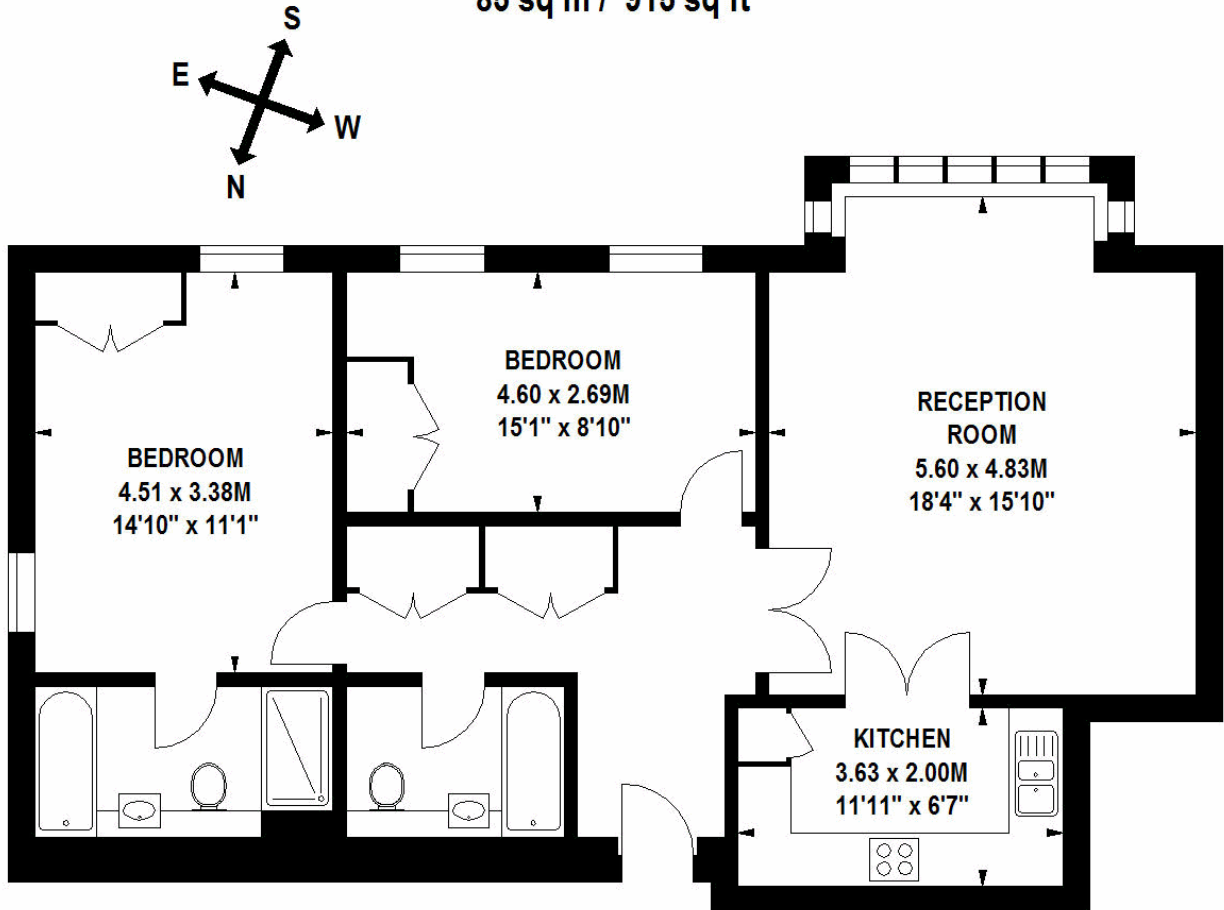

First Floor

Floorplan produced for Chesterton Humberts by Mays Floorplans © . Tel 020 3397 4594
Illustration for identification purposes only, not to scale
All measurements are maximum, and includes wardrobes and window bays where applicable