

Aldreds
Estate Agents



4 Broadwater Way, Horning, Norwich, NR12 8PD

£300,000





£300,000

4 Broadwater Way

Horning, Norwich, NR12 8PD

- Spacious Bungalow
- Refurbishment & Modernisation Required
- Gas Fired Central Heating
- Garage and Driveway Parking
- Offered with No Onward Chain
- Three bedrooms
- Sought after Broadland Location
- Garden Facing Living Area
- Pleasant Enclosed Garden
- Early Viewing Highly Recommended

Aldreds are delighted to offer this well positioned three bedroom, detached bungalow situated in the much sought after Broadland village of Horning. Now requiring refurbishment and modernisation throughout to realise it's full potential. This spacious home offers an excellent opportunity within this much favoured Broadland location.

The property offers gas fired central heating, uPVC sealed unit double glazed windows, driveway parking, garage and a nicely enclosed rear garden with South, South Westerley aspect. Located just a short walk away from the River Bure in the centre of the village, early internal viewing is highly recommended to appreciate this spacious bungalow which is offered with no onward chain.



Entrance Hall

Part glazed uPVC entrance door with glazed side panel, built-in cupboard housing electric meters, two radiators, two steps leading to a raised level serving the bedrooms and bathroom, thermostat, airing cupboard housing hot water cylinder with immersion heater, doors leading off.

'L' shape Lounge/Diner

Lounge Area 17'9" x 12'1" at max (5.43m x 3.7m at max)

Glazed sliding doors to rear garden, Parquet flooring, radiator, exposed brick chimney breast and wall to side with fitted shelving and tiled hearth with a gas fire (unknown working order), open plan access to dining area.

Dining Area 9'2" x 9'0" (2.81m x 2.76m)

Windows to side and rear, radiator, Parquet flooring, service hatch, glazing and fitted cupboards from kitchen, power points, door giving access to;





Kitchen/Breakfast Room 11'11" x 9'0" (3.64m x 2.76m)

Window to side aspect, part glazed door to side, a range of fitted kitchen units with rolled edge work surface and tiled splashbacks, stainless steel sink drainer with mixer tap, power points, electric cooker point, two cupboards, one housing a gas fired boiler for hot water and central heating, doorway from hallway,

Bedroom 1 12'1" x 10'5" (3.69m x 3.18m)

Window to side aspect, radiator, power points, built-in wardrobe

Bedroom 2 13'4" x 9'1" (4.08m x 2.79m)

Windows to front and side aspects, radiator, built-in wardrobes, power point.

Bedroom 3 9'11" x 8'10" (3.04m x 2.7m)

Window to side aspect, radiator, power point, built-in wardrobe and built-in cupboard.

Directions

From our Broadland office in Stalham proceed on the main road towards Wroxham/Hoveton, on reaching the mini roundabouts, take the sign posted first left hand turn and proceed towards the village of Horning on the Horning Road. On arriving in the village, turn right into Lower Street then first left into Broadwater Way, where the property can be found a short way along on the right hand side, located by our 'For Sale' board.



Bathroom

Side facing obscure glaze window, panel bath with tiled surround, electric shower over, pedestal hand wash basin, radiator, wall mounted electric heater, shavers point, towel rail.

WC

Side facing obscure glaze window, low level WC.

Outside

The property occupies a pleasant position within the village with vehicular access via driveway extending to the side of the property and leading on to garage.

Garage 17'7" x 9'1" (5.36m x 2.77m)

Front facing up and over door, side service door.

Garden

The property offers lawned gardens to front and rear. The rear garden is of generous proportion with a South, South Westerley aspect and enclosed with close board panelled fencing to boundaries with a variety of mature shrubbery and planting to borders. To the far side of the property are two useful brick built stores.

Tenure

Freehold

Services

Mains water, electric, drainage and gas

Council Tax

North Norfolk District Council - Band 'D'

Location

Horning is a picturesque Broadland village on the banks of The River Bure with its own facilities which include a variety of shops, Restaurants/Public Houses, Post Office, First School, and Sailing Club. An ideal location for the fishing or boating enthusiast. The village lies approximately 3 miles from Wroxham, the capital of the Broads and 12 miles from the Fine City of Norwich

Reference

PJL/S10016



Floor Plans

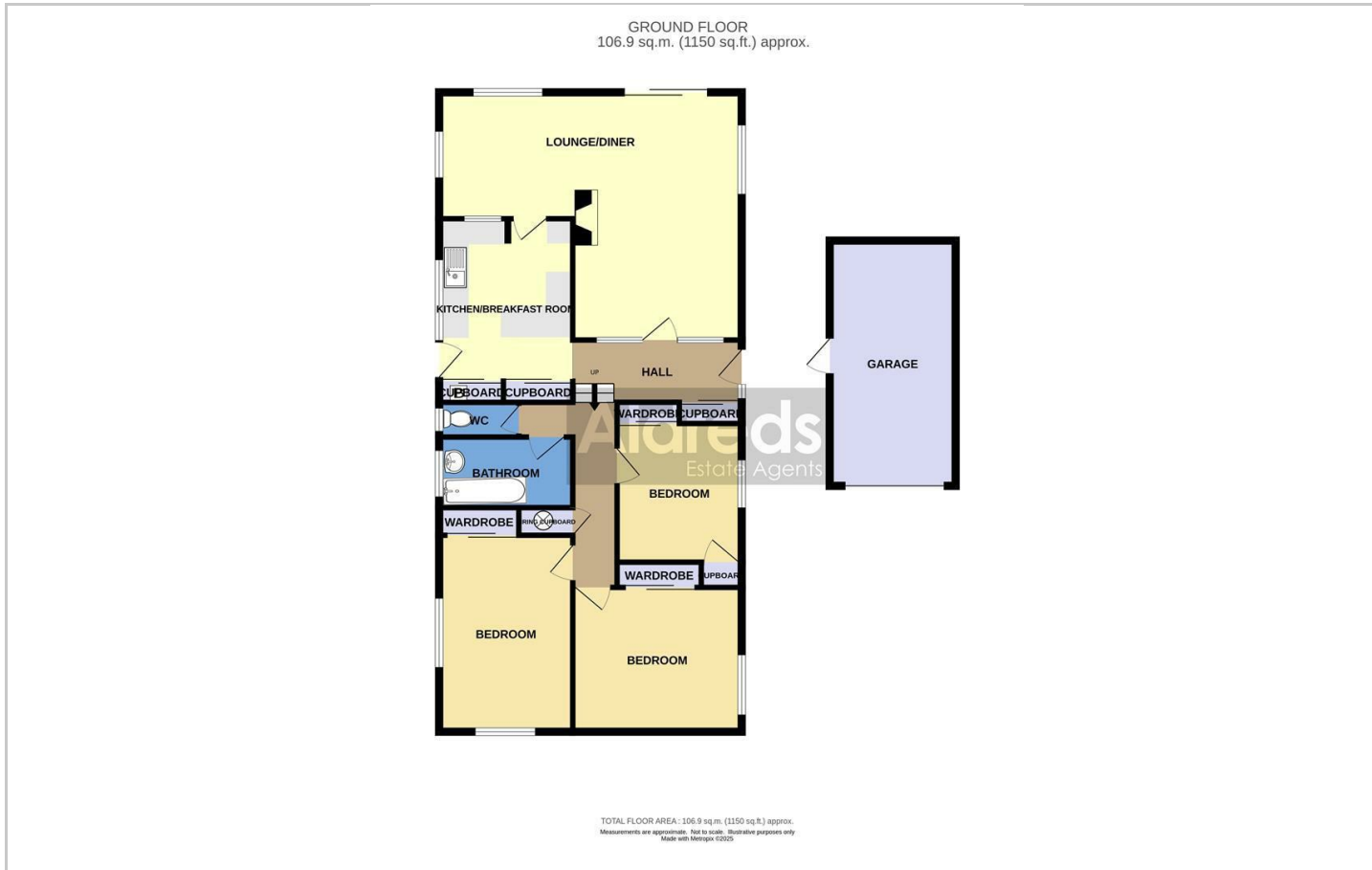

Location Map

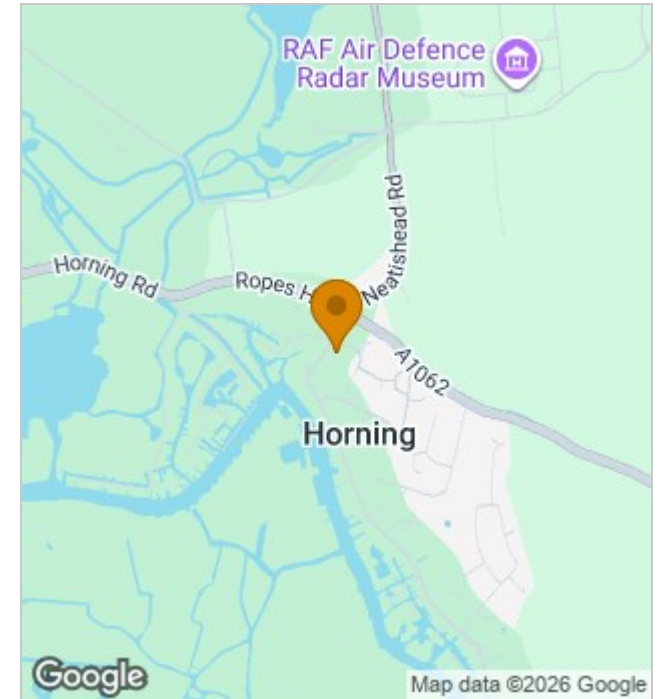

Energy Performance Graph

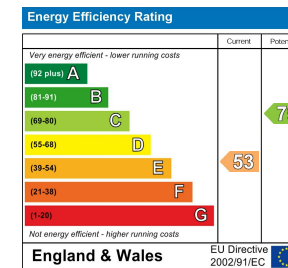

Viewing

Please contact our Aldreds Stalham Office on 01692 581089 if you wish to arrange a viewing appointment for this property or require further information.

Disclaimer

These particulars are issued on an understanding that all negotiations shall be conducted through Messrs. Aldreds. Please note: Messrs. Aldreds for themselves and for the vendors or lessors of this property whose agents they are given notice that: 1. Particulars are set out as a general outline only for guidance of intending purchasers or lessees, and do not constitute nor constitute part of, an offer or contract. 2. All descriptions, dimensions, references to condition and necessary permissions for use and occupation, and other details are given without responsibility and any intending purchasers or tenants should not rely on them as statements or representations of fact but must satisfy themselves by inspection or otherwise as to the correctness of each of them. 3. No person in the employment of Messrs. Aldreds has any authority to make or give any representation or warranty whatever in relation to this property. 4. If you are proposing to visit the property and are travelling some distance please check with Aldreds on the issue of availability prior to travelling. 5. Aldreds Property Consultants and associated services may offer additional services to the prospective purchaser for which they will be entitled to receive a commission. Aldreds are pleased to be working with Mortgage Advice Bureau. They're an award-winning mortgage broker with over 1,400 advisers across the UK, and have access to over 12,000 mortgage products from over 90 lenders. Aldreds Estate Agents Ltd receive a commission of £200 on each completed case. Your home may be repossessed if you do not keep up repayments on your mortgage. There may be a fee for mortgage advice. The actual amount you pay will depend upon your circumstances. The fee is up to 1%, but a typical fee is 0.3% of the amount borrowed. Mortgage Advice Bureau is a trading name of Mortgage Seeker Limited which is an appointed representative of Mortgage Advice Bureau Limited and Mortgage Advice Bureau (Derby) Limited which are authorised and regulated by the Financial Conduct Authority. Mortgage Seeker Limited Registered Office: Lovewell Blake, Sixty Six North Quay, Great Yarmouth, Norfolk, NR30 1HE. Registered in England Number: 03721415. 6. Potential purchasers should check with their providers that the broadband and mobile phone coverage they would require is available.

55 High Street, Stalham, Norfolk, NR12 9AH
Tel: 01692 581089 Email: stalham@aldreds.co.uk <https://www.aldreds.co.uk/>

Registered in England Reg. No. 08945751 Registered Office: 17 Hall Quay, Great Yarmouth, Norfolk NR30 1HJ Directors: Mark Duffield B.S.c. FRICS. Dan Crawley MNAEA Paul Lambert MNAEA