



Flat 12 Arabella Court, 176 London Road, Portsmouth, PO2 9DP

£1,015 Per Calendar Month Council Tax Band B Deposit £1,172



1



1



C

Tully's

Floor Plan

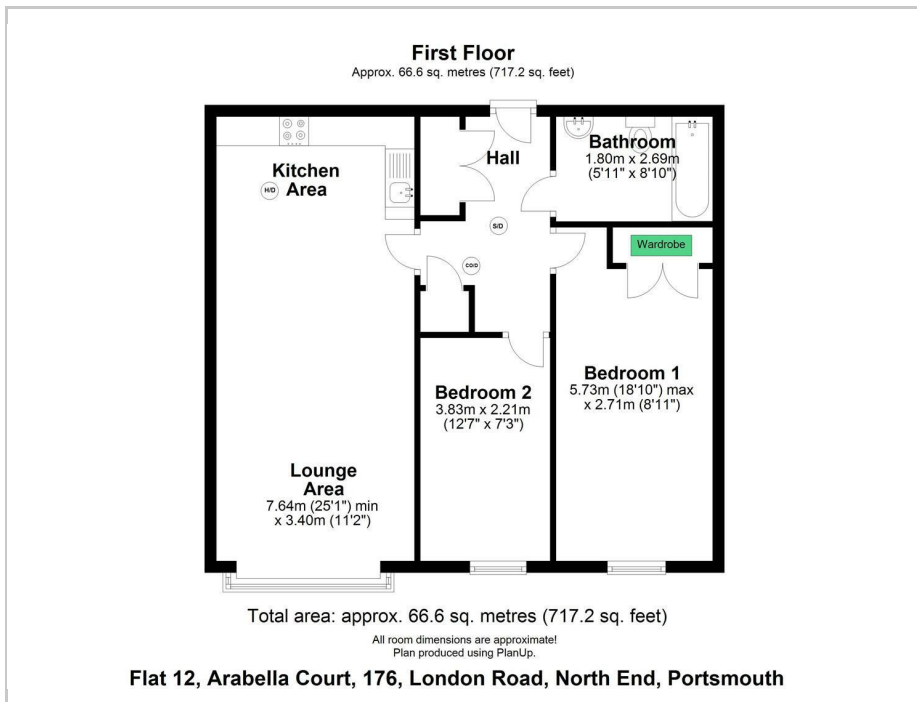

Area Map



Accommodation

- HOLDING DEPOSIT - £234.00
- DEPOSIT - £1171.00
- ALLOCATED PARKING SPACE
- 2 BEDROOMS
- BUILT IN DISHWASHER, FRIDGE, FREEZER, OVEN AND HOB
- MODERN BLOCK
- LIFT IN BLOCK
- GREAT TRANSPORTLINKS
- AVAILABLE 29/07/2026

Viewing

Please contact our Southsea Office on 023 9273 2241 if you wish to arrange a viewing appointment for this property or require further information.

Energy Efficiency Graph

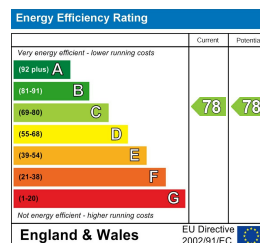

157-159 Albert Road, Southsea, Portsmouth, Hampshire, PO4 0JW
023 9273 2241 Email: tully@tullyand.co lettings@tullyand.co

Tully's