

# *Callaghans*

Independent Estate Agents, Surveyors, Valuers and Mortgage Brokers

**59 Foxland Road,**  
**Gatley, SK8 4QB**



**£335,000**

**Gatley Semi-Detached**  
**Three Bedrooms**  
**Spacious Dining Kitchen**  
**Bathroom and Separate Toilet**  
**Front and rear Gardens**  
**Off Road Parking**

Callaghans Estate Agents  
46 Church Road, Gatley, SK8 4NQ  
Telephone: 0161 491 4000, Fax: 0161 491 55 44  
Website: [www.callaghansltd.com](http://www.callaghansltd.com) Email: [admin@callaghansltd.com](mailto:admin@callaghansltd.com)

Callaghans are delighted to offer for sale this well-proportioned three-bedroom semi-detached home in the highly sought-after area of Gatley. Offered with no onward chain, this property is ready for you to move straight in and make it your own.

The welcoming central hallway provides access to all ground floor rooms. To the right, the bright and airy lounge benefits from dual aspect windows, allowing natural light to flood the space, and features a charming fireplace. To the left, the spacious dining kitchen is fitted with stylish dark grey units and offers ample room for appliances, creating a practical and sociable area for everyday living.

Upstairs, the property offers three well-proportioned bedrooms, ideal for families or those needing extra space for a home office. The tiled family bathroom includes an over-bath shower, while a separate toilet adds extra convenience.

Externally, the property boasts gardens to both the front and rear, along with off-road parking. Ideally located close to Scholes Park and within easy reach of Gatley village, residents can enjoy a range of schools, local shops and good transport links.

Early viewing is highly recommended—contact Callaghans today to arrange yours.

**Lounge** 10' 2" x 17' 11" (3.11m x 5.45m)

**Kitchen/Diner** 17' 11" x 13' 5" (5.45m x 4.1m)

**Bathroom** 5' 6" x 4' 10" (1.68m x 1.48m)

**Toilet** 2' 9" x 4' 11" (0.85m x 1.49m)

**Bedroom One** 10' 7" x 12' 0" (3.22m x 3.65m)

**Bedroom Two** 10' 3" x 9' 5" (3.12m x 2.88m)

**Bedroom Three** 7' 11" x 7' 4" (2.41m x 2.24m)

Callaghans Estate Agents  
46 Church Road, Gatley, SK8 4NQ  
Telephone: 0161 491 4000, Fax: 0161 491 55 44  
Website: [www.callaghansltd.com](http://www.callaghansltd.com) Email: [admin@callaghansltd.com](mailto:admin@callaghansltd.com)

GROUND FLOOR  
424 sq.ft. (39.4 sq.m.) approx.

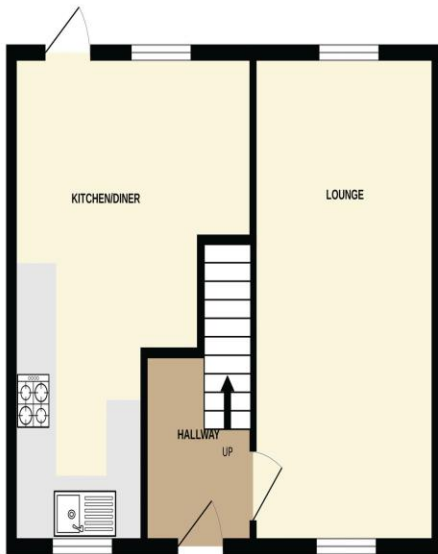

1ST FLOOR  
424 sq.ft. (39.4 sq.m.) approx.

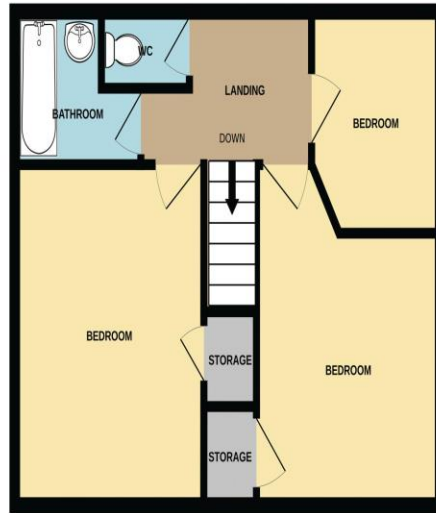

TOTAL FLOOR AREA: 847 sq.ft. (78.7 sq.m.) approx.

Whilst every attempt has been made to ensure the accuracy of the floorplan contained here, measurements of doors, windows, rooms and any other items are approximate and no responsibility is taken for any error, omission or mis-statement. This plan is for illustrative purposes only and should be used as such by any prospective purchaser. The services, systems and appliances shown have not been tested and no guarantee as to their operability or efficiency can be given.  
Made with Metropix ©2026

**Disclaimer:**

These particulars, whilst believed to be accurate are set out as a general guideline only or guidance and do not constitute any part of an offer or contract. Intending purchasers should not rely on them as statements of representation or fact, but must satisfy themselves by inspection or otherwise as to their accuracy. Please note that we have not tested any apparatus, equipment, fixtures, fittings or services, including gas central heating and so cannot verify they are in working order or fit for their purpose. Further more solicitors should confirm movable items described in the sales particulars are, in fact included in the sale since circumstances do change during marketing or negotiations. Although we try to ensure accuracy, measurements used in this brochure may be approximate. Therefore if intending purchasers need accurate measurements to order carpeting or to ensure existing furniture will fit, they should take such measurements themselves. **YOUR HOME IS AT RISK IF YOU DO NOT KEEP UP REPAYMENTS ON A MORTGAGE OR OTHER LOAN SECURED ON IT**