

The Estate Agents People Recommend



Flat 5, Lawrence Court The Grove, Twyford, RG10 9JQ

Price guide £250,000

Nestled in the charming village of Twyford, this delightful one-bedroom first-floor apartment offers a perfect blend of modern living and convenience. Situated in the heart of the village, residents will enjoy easy access to a variety of local shops, cafes, and amenities, making daily errands a breeze.

The apartment boasts a well-designed layout that maximises space and light, creating a warm and inviting atmosphere. The bedroom is generously sized, providing a comfortable retreat, while the living area is ideal for relaxation or entertaining guests.

One of the standout features of this property is the gated parking, ensuring both security and peace of mind for residents. Additionally, the apartment is within walking distance to the railway station, making it an excellent choice for commuters seeking a quick and easy journey into Reading or London Paddington with the additional benefit of the Elizabeth Line.

This property presents a wonderful opportunity for first-time buyers or those looking to downsize, offering a low-maintenance lifestyle in a vibrant community. With its prime location and desirable features, this apartment is not to be missed.

EPC rating B
Council tax band C
Leasehold - With 85 years remaining



t: 0118 934 0027
e: twyford@wentworthea.com
w: wentworthea.com



[wentworth_ea](https://twitter.com/wentworth_ea)



[wentworthea](https://www.facebook.com/wentworthea)

GROUND FLOOR
431 sq.ft. (40.1 sq.m.) approx.

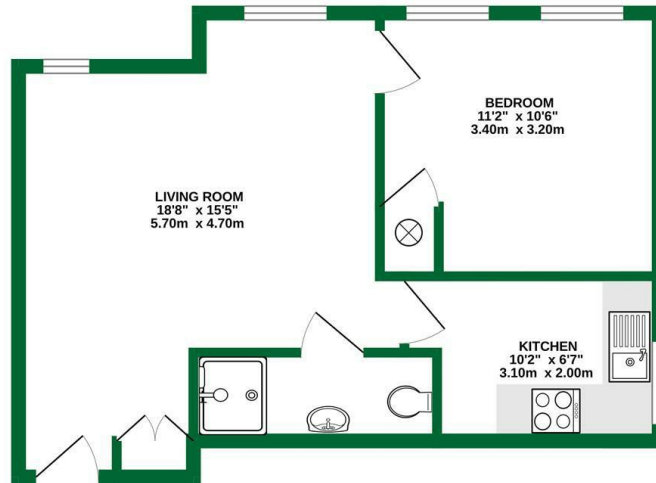

TOTAL FLOOR AREA: 431 sq.ft. (40.1 sq.m.) approx.
While every attempt has been made to ensure the accuracy of the floorplan contained herein, measurements of doors, windows, rooms and any other items are approximate and no responsibility is taken for any error, omission or mis-statement. This plan is for illustrative purposes only and should be used as such for any prospective purchaser. The services, systems and appliances shown have not been tested and no guarantee as to their operation or efficiency can be given.
Made with SketchUp 12.0.25



Important Notice 1. Particulars: These particulars are not an offer or contract, nor part of one. You should not rely on statements by Wentworth Estate Agents in the particulars or by word of mouth or in writing ("information") as being factually accurate about the property, its condition or its value. Neither Wentworth Estate Agents nor any joint agent has any authority to make any representations about the property, and accordingly any information given is entirely without responsibility on the part of the agents, seller(s) or lessor(s). 2. Photos etc: The photographs show only certain parts of the property as they appeared at the time they were taken. Areas, measurements and distances given are approximate only. 3.Regulations etc: Any reference to alterations to, or use of, any part of the property does not mean that any necessary planning, building regulations or other consent has been obtained. A buyer or lessee must find out by inspection or in other ways that these matters have been properly dealt with and that all information is correct.

