

34 Marston Close,

Guide Price £285,000

🛏 2 🚗 1 🚗 1

PHOTOS



COMING SOON



PROPERTY REF:JV0032

A very well positioned and high quality two bedrooms modern home, with accommodation over two floors, an enclosed garden, with parking for two vehicles, within this smart development of Cherryfield's

Key Features

- Ideal first-time purchase
- Spacious lounge/diner
- Off-street parking for two ehicle
- Short walk to a local primary school
- Property Ref JV0032
- Two double bedrooms
- Contemporary kitchen with integrated appliances
- Larger than average rear garden
- Council Tax Band Band C £2190

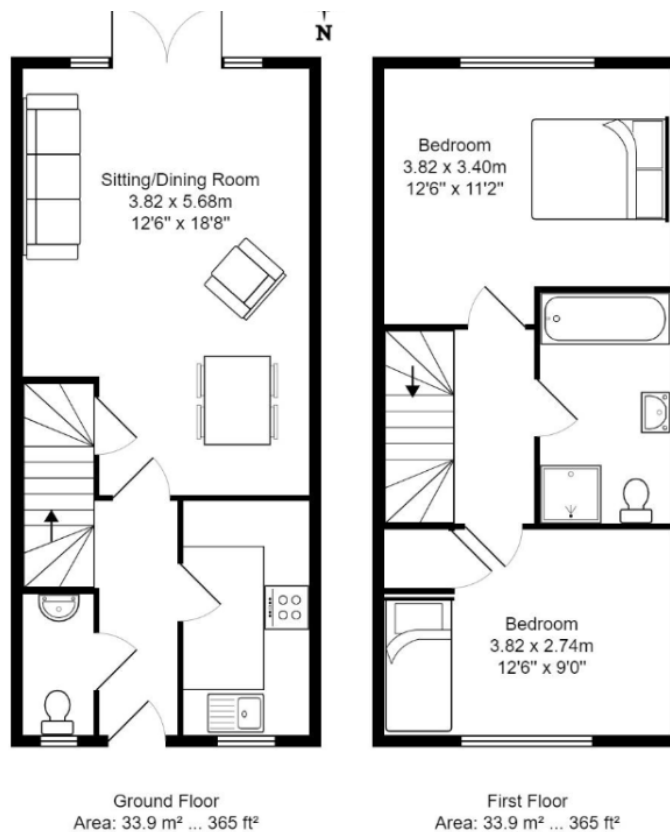

Total Area: 67.8 m² ... 730 ft²

All measurements are approximate and for display purposes only.