



**GASCOIGNE
HALMAN**

MULBERRY CLOSE, ELTON, CHESTER

THE AREAS LEADING ESTATE AGENT



MULBERRY CLOSE, ELTON, CHESTER

Offers Over £155,000

Does the perfect starter home exist? If it does, this lovely mid terraced house must be a contender for such an accolade. It is presented in lovely condition throughout and ready for new owners to enjoy from day one.

The bright and freshly decorated interior includes a welcoming hallway with wall panels and tiled floor.

The smart modern kitchen has fitted cabinets and oak work tops plus built in oven, hob and extractor. There is a spacious living room and access via patio doors to a conservatory that is currently used as a dining room.





DESCRIPTION

On the first floor are two bedrooms with the larger bedroom having fitted wardrobes. The bathroom has been re-fitted in recent years with a modern suite. Gas fired central heating is installed and the windows are double glazed.

The rear garden enjoys a south facing aspect and features a patio, lawn and a new garden shed. There are two allocated car parking spaces to the side and spaces for visitors.

LOCATION

The house occupies a great position, set in a residential cul-de-sac on the edge of this popular development known as Greenacres. There are a mixture of detached, semi-detached and terraced homes and the area remains popular with couples and families alike. The village of Elton has a good selection of local shops, primary school and two pubs whilst Helsby and Cheshire Oaks are within a few minutes drive with a very wide range of shops and services. The road and motorway networks allow good access to many parts of the North West.

TENURE

Freehold.

COUNCIL TAX

Band A. Cheshire West & Chester.

EPC RATING

Awaited.

Ground Floor
Approx. 33.0 sq. metres (355.4 sq. feet)

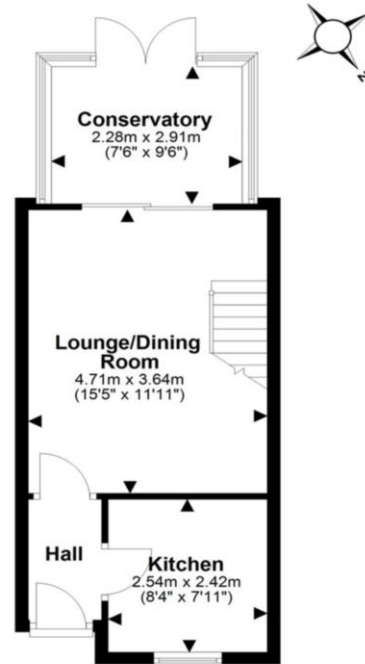

First Floor
Approx. 26.8 sq. metres (288.8 sq. feet)

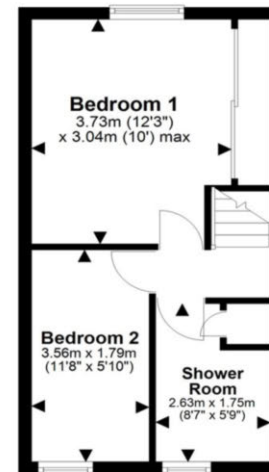

Total area: approx. 59.8 sq. metres (644.2 sq. feet)

NOTICE Gascoigne Halman for themselves and for the vendors or lessors of this property whose agents they are give notice that: (i) the particulars are set out as a general outline only for the guidance of intending purchasers or lessees, and do not constitute, nor constitute part of, an offer or contract; (ii) all descriptions, dimensions, references to condition and necessary permissions for use and occupation, and other details are given in good faith and are believed to be correct but any intending purchasers or tenants should not rely on them as statements or representations of fact but must satisfy themselves by inspection or otherwise as to the correctness of each of them; (iii) no person in the employment of Gascoigne Halman has any authority to make or give any representation or warranty whatever in relation to this property.

FRODSHAM OFFICE

01928 739777

frodsham@gascoignehalman.co.uk

Pollard Buildings, Church Street, Frodsham, WA6 7DW

**GASCOIGNE
HALMAN**