



3 Bedrooms | 1 Bathroom | 1 Reception Room

Foxley Gardens | Purley | CR8 2DQ

£480,000

LOFT

Foxley Gardens |
Purley | CR8 2DQ
£480,000

- Sophisticated Victorian mid-terraced home
- Contemporary design throughout with high quality hard flooring and fittings
- Through lounge-diner with bi-fold doors, allowing the light to pour through
- Larger-than-average kitchen with plenty of space for all the appliances
- Modern landscaped rear garden with slick patio and artificial grass
- Three good size bedrooms and fully tiled bathroom to the first floor
- Plenty of character remains throughout with bay windows and high ceilings
- Ideally situated for great schools and within walking distance of Purley train station and town centre
- Perfect for families with parks and green spaces all close-by

Ground Floor

Hallway

Reception Room

15'5" x 10'9" (4.70m x 3.28m)

Dining Room

14'1" x 9'8" (4.29m x 2.95m)

Kitchen

21'6" x 6'6" (6.55m x 1.98m)

First Floor

Landing

Bedroom

15'3" x 10'9" (4.65m x 3.28m)

Bedroom

13'3" x 10'8" (4.04m x 3.25m)

Bedroom

10'3" x 5'8" (3.12m x 1.73m)

Bathroom

Outside

Rear Garden



Foxley Gardens, CR8

Approximate Gross Internal Area
95.8 sq m / 1031 sq ft

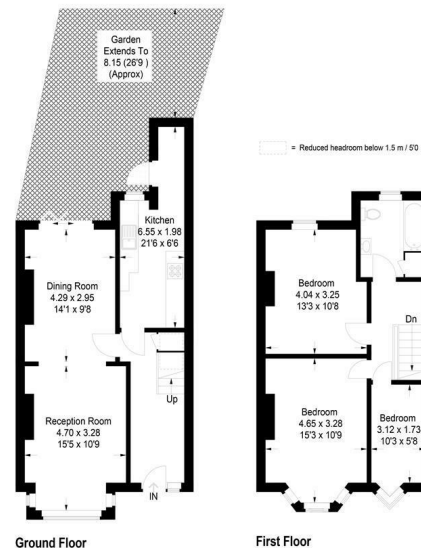

This plan is for layout guidance only. Not drawn to scale unless stated. Windows and door openings are approximate. Whilst every care is taken in the preparation of this plan, please check all dimensions, shapes and compass bearings before making any decisions reliant upon them. (ID1312606)

EPC Rating: C

23a High Street
Purley
Surrey
CR8 2AF
0208 660 8070
hello@loft-estates.co.uk

