



Ludwick Way, Welwyn Garden City AL7 3PL

welcome to

Ludwick Way, Welwyn Garden City

OFFERED TO THE MARKET VIA THE MODERN METHOD OF AUCTION, this well-presented, chain-free two-bedroom mid-terraced home occupies a highly convenient position close to a wide range of local amenities, including shops, schools, and regular bus routes. The vibrant town centre and mainline train station - providing direct services into London - are both within easy walking distance. The accommodation opens with a welcoming entrance hall leading through to a spacious lounge/dining room, featuring French doors that open directly onto the rear garden, creating a bright and inviting living space ideal for entertaining. The fully fitted kitchen offers ample storage and generous space for appliances. To the first floor are two generously sized bedrooms, both well-proportioned, along with a family bathroom. Externally, the property benefits from front and rear gardens, as well as a garage en bloc, providing valuable additional storage or parking. Excellent road links via the A414, A1(M), and M25 ensure strong commuter connectivity, making this an ideal purchase for professionals, first-time buyers, and small families alike.



Auctioneer's Comments

This property is offered through Modern Method of Auction. Should you view, offer or bid your data will be shared with the Auctioneer, iamsold Limited. This method requires both parties to complete the transaction within 56 days, allowing buyers to proceed with mortgage finance (subject to lending criteria, affordability and survey). The buyer is required to sign a reservation agreement and make payment of a non-refundable Reservation Fee of 4.5% of the purchase price including VAT, subject to a minimum of £6600.00 including VAT. This fee is paid in addition to purchase price and will be considered as part of the chargeable consideration for the property in the calculation for stamp duty liability. Buyers will be required to complete an identification process with iamsold and provide proof of how the purchase would be funded. The property has a Buyer Information Pack containing documents about the property. The documents may not tell you everything you need to know, so you must complete your own due diligence before bidding. A sample of the Reservation Agreement and terms and conditions are contained within this pack. The buyer will also make payment of no more than £349 inc. VAT towards the preparation cost of the pack. Please confirm exact costs with the auctioneer. The estate agent and auctioneer may recommend the services of other providers to you, in which they will be paid for the referral. These services are optional, and you will be advised of any payment, in writing before any services are accepted. Listing is subject to a start price and undisclosed reserve price that can change.

Entrance Hall

Carpet, radiator.

Lounge/Dining Room

Sliding door to garden, carpet, radiator, storage cupboard.

Kitchen

Double glazed window, laminate wood flooring, sink/drain, wall and base units, space for appliances.

Bedroom One

Double glazed window to rear, carpet, radiator, built in wardrobe.

Bedroom Two

Double glazed window to front, carpet, radiator, built in wardrobe, storage cupboard.

Bathroom

carpet, wash hand basin, W/C, bath, radiator.

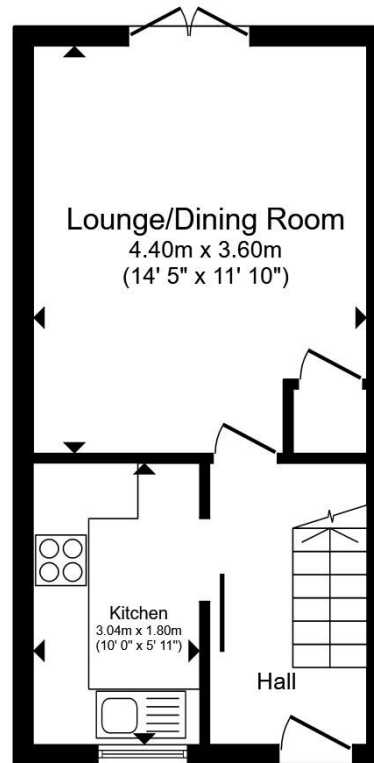

Ground Floor

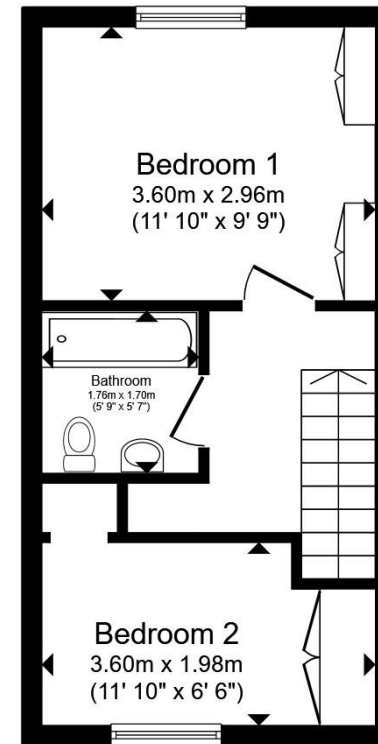

First Floor

Total floor area 54.3 m² (584 sq.ft.) approx

This floor plan is for illustrative purposes only. It is not drawn to scale. Any measurements, floor areas (including any total floor area), openings and orientation are approximate. No details are guaranteed, they cannot be relied upon for any purpose and they do not form part of any agreement. No liability is taken for any error, omission or misstatement. A party must rely upon its own inspection(s). Powered by www.propertybox.io



welcome to

Ludwick Way, Welwyn Garden City

- Sale by Modern Auction (T&Cs apply)
- Subject to an undisclosed Reserve Price
- Buyers fees apply
- CHAIN FREE
- Two Bedroom House

Tenure: Freehold EPC Rating: C
Council Tax Band: C



guide price

£250,000



check out more properties at williamhbrown.co.uk

Please note the marker reflects the
postcode not the actual property



Property Ref:
WGN109614 - 0004

1. MONEY LAUNDERING REGULATIONS Intending purchasers will be asked to produce identification documentation at a later stage and we would ask for your co-operation in order that there is no delay in agreeing the sale. 2. These particulars do not constitute part or all of an offer or contract. 3. The measurements indicated are supplied for guidance only and as such must be considered incorrect. Potential buyers are advised to recheck measurements before committing to any expense. 4. We have not tested any apparatus, equipment, fixtures or services and it is in the buyers interest to check the working condition of any appliances. 5. Where an EPC, or a Home Report (Scotland only) is held for this property, it is available for inspection at the branch by appointment. If you require a printed version of a Home Report, you will need to pay a reasonable production charge reflecting printing and other costs. 6. We are not able to offer an opinion either written or verbal on the content of these reports and this must be obtained from your legal representative. 7. Whilst we take care in preparing these reports, a buyer should ensure that his/her legal representative confirms as soon as possible all matters relating to title including the extent and boundaries of the property and other important matters before exchange of contracts.

William H Brown is a trading name of Sequence (UK) Limited which is registered in England and Wales under company number 4268443, Registered Office is Cumbria House, 16-20 Hockliffe Street, Leighton Buzzard, Bedfordshire, LU7 1GN. VAT Registration Number is 500 2481 05.

william h brown



01707 324361



WelwynGardenCity@williamhbrown.co.uk



53 Wigmores North, WELWYN GARDEN CITY,
Hertfordshire, AL8 6PG



williamhbrown.co.uk