



23 Greenfields Gardens, Greenfields, Shrewsbury, SY1 2RN

2 bedroom apartment — £160,000 Leasehold

23 Greenfields Gardens, Greenfields, Shrewsbury, SY1 2RN

Coopergreenpooks.co.uk

£160,000 Leasehold — 2 bedroom apartment

sales@cgpooks.co.uk

Situated within a popular residential area, a short walk from the train station and town centre, this neatly presented ground floor apartment offers well-designed accommodation throughout, while benefitting from private allocated parking.

KEY FEATURES

- Good sized entrance hall with useful storage
- Open plan living/dining room with window to front
- Separate fitted kitchen with a range of units, space for appliances and breakfast table
- Two generous bedrooms, a well-appointed family bathroom with shower, and ensuite to bedroom one
- uPVC double glazed windows and electric heating
- Private allocated parking, conveniently located to the front of the building
- A great location, just a short walk from the train station, River Severn, and town centre
- Sold vacant with no upward chain

Cooper Green Pooks
3 Barker Street
Shrewsbury
SY1 1QF

www.cgpooks.co.uk
sales@cgpooks.co.uk
01743 276666



Ground Floor

Approx. 59.5 sq. metres (640.0 sq. feet)

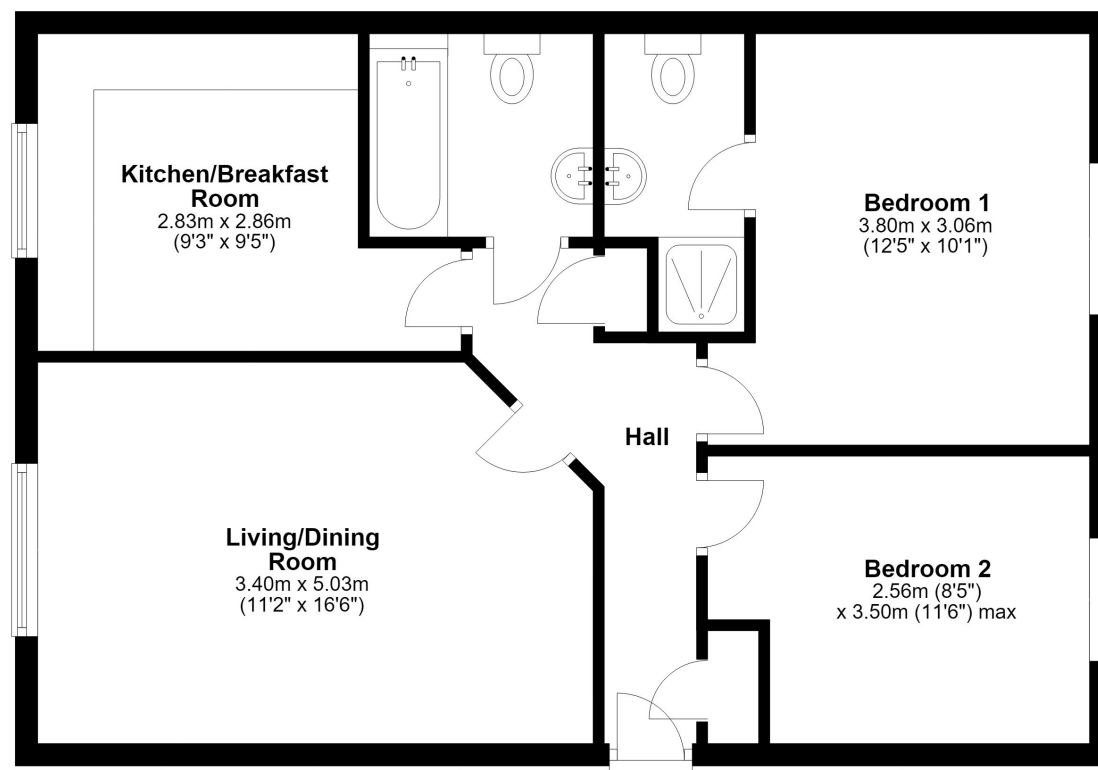

Total area: approx. 59.5 sq. metres (640.0 sq. feet)





23 Greenfields Gardens, Greenfields, Shrewsbury, SY1 2RN

£160,000 Leasehold — 2 bedroom apartment

sales@cgpooks.co.uk

rightmove

onTheMarket.com

RICS
Regulated by RICS

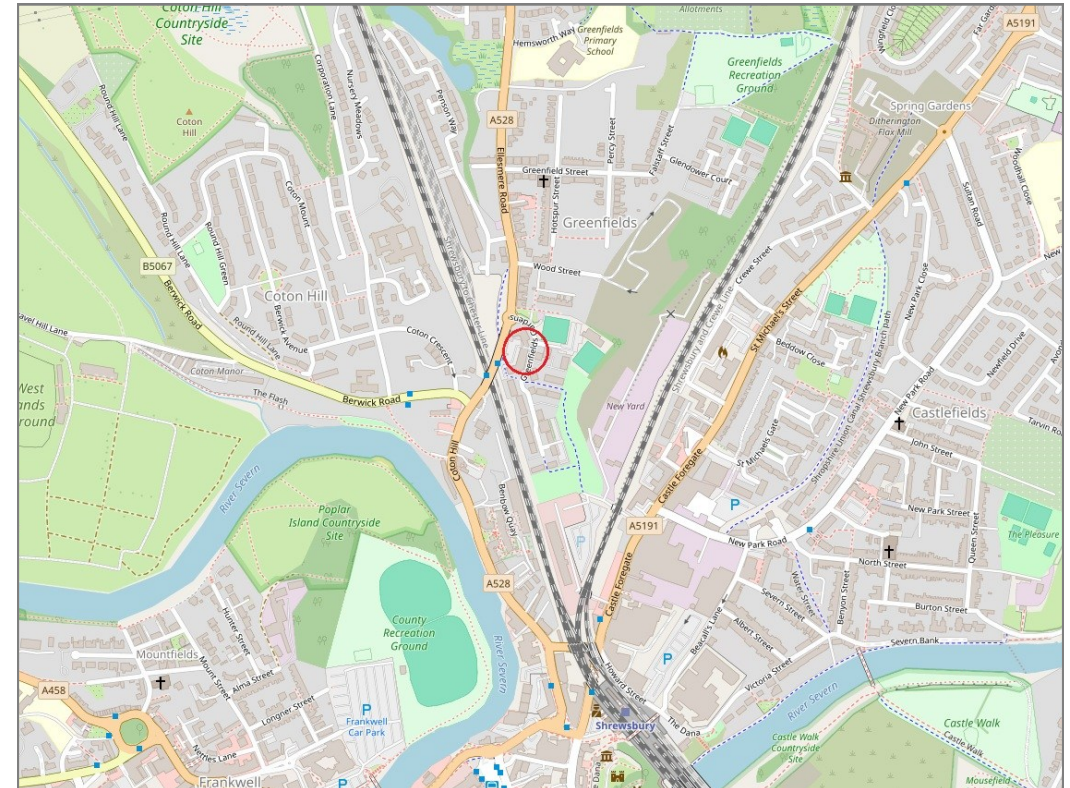
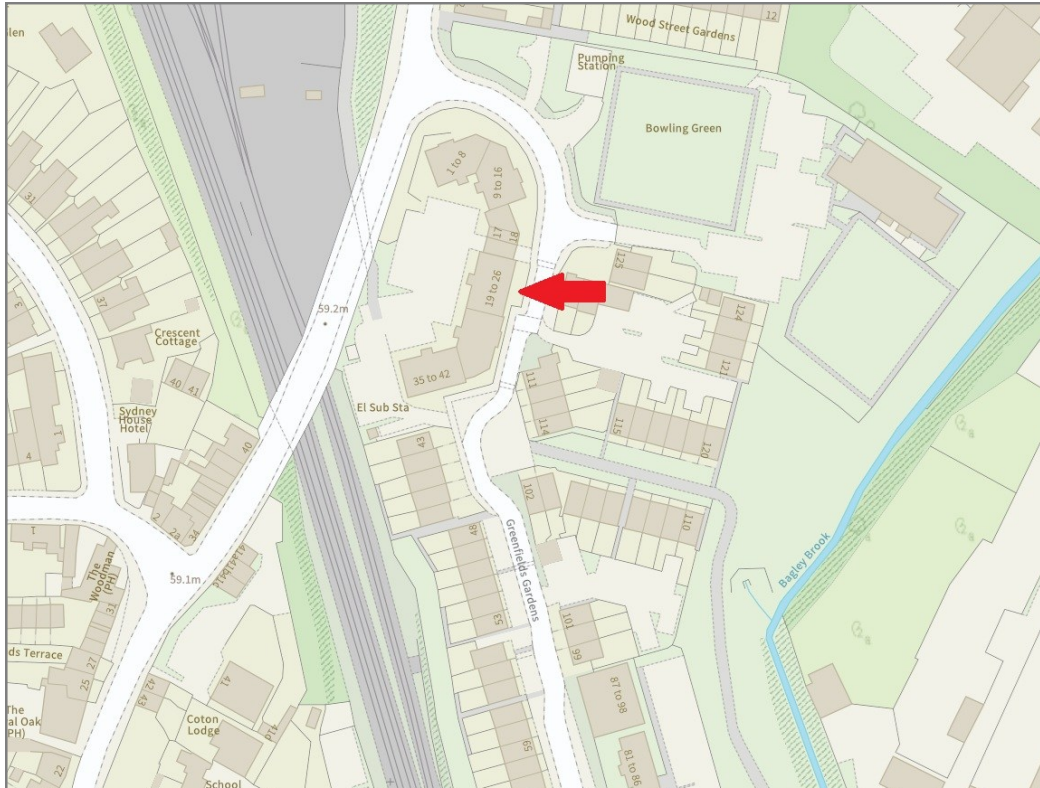

BOUNDARIES NOT CONFIRMED

| | |
|-----------------|---|
| Local Authority | Shropshire Council |
| Council Tax | Band B |
| EPC Band | Band C |
| Services | Mains water, electricity and drainage are connected. Electric heating. |

| | |
|----------------|----------------------------|
| Tenure | Leasehold |
| Lease Length | 136 years remaining |
| Service Charge | £1,435 per annum |
| Ground Rent | £269 per annum |

23 Greenfields Gardens, Greenfields, Shrewsbury, SY1 2RN

Coopergreenpooks.co.uk

£160,000 Leasehold — 2 bedroom apartment

sales@cgpooks.co.uk

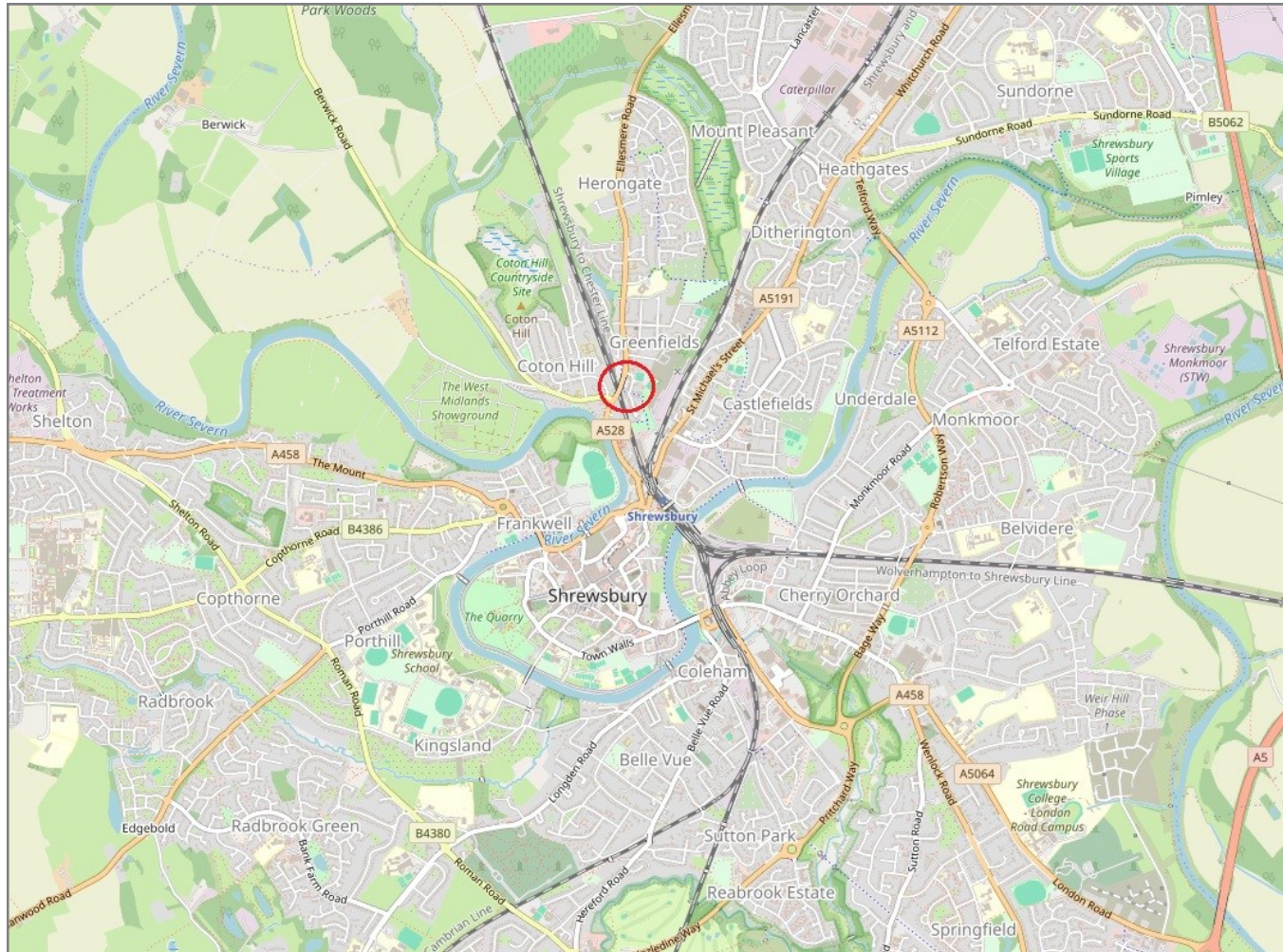

IMPORTANT NOTICE: Cooper Green Pooks for themselves and for the lessors or vendors of this property whose agents they are give notice that: 1 No appliances, services or service installations have been tested and no warranty as to suitability or serviceability is implied. Any prospective purchaser or lessee is advised to obtain verification from their surveyor or solicitor. 2. The particulars are set out as a general outline only for the guidance of the intended purchasers or lessees and do not constitute, nor constitute part of, an offer or contract. 3. All descriptions, reference to condition and necessary permissions for use and occupation and other details are given in good faith and are believed to be correct but any intending purchasers or lessees should not rely on them as statements or representation of fact but satisfy themselves by inspection or otherwise as to the correctness of each of them. 4. No person in the employment of Cooper Green Pooks has any authority to make or give any representation or warranty whatsoever in relation to this property. 5. All rentals and prices are quoted exclusive of Stamp Duty, legal and surveyors fees and any other associated purchasers or lessees costs. 6. Floor plans are indicative only and should not be relied on. 7. The plan showing the boundary of the property is indicative only and has not been checked against the legal title so should not be relied on. 8. All dimensions, floor areas and site areas are only approximate and should not be relied on. Dimensions are generally maximum room dimension.