



## Dawes Road, SW6

### £375,000

A beautifully designed apartment which has an open plan kitchen/ living area boasting plenty of natural light and a stylish kitchen with integrated appliances, a large double bedroom with fitted wardrobes and a luxurious bathroom.

Within this well kept development which is conveniently located on the corner of Dawes Road and North End Road, close to all local amenities and transport links of Fulham Broadway, West Brompton and Parsons Green.

### Features

- One Double Bedroom
- Open Plan Kitchen Living
- Wooden Flooring
- Central Location
- Fulham Broadway
- Bright And Spacious

**Dawes Road,  
London, SW6**

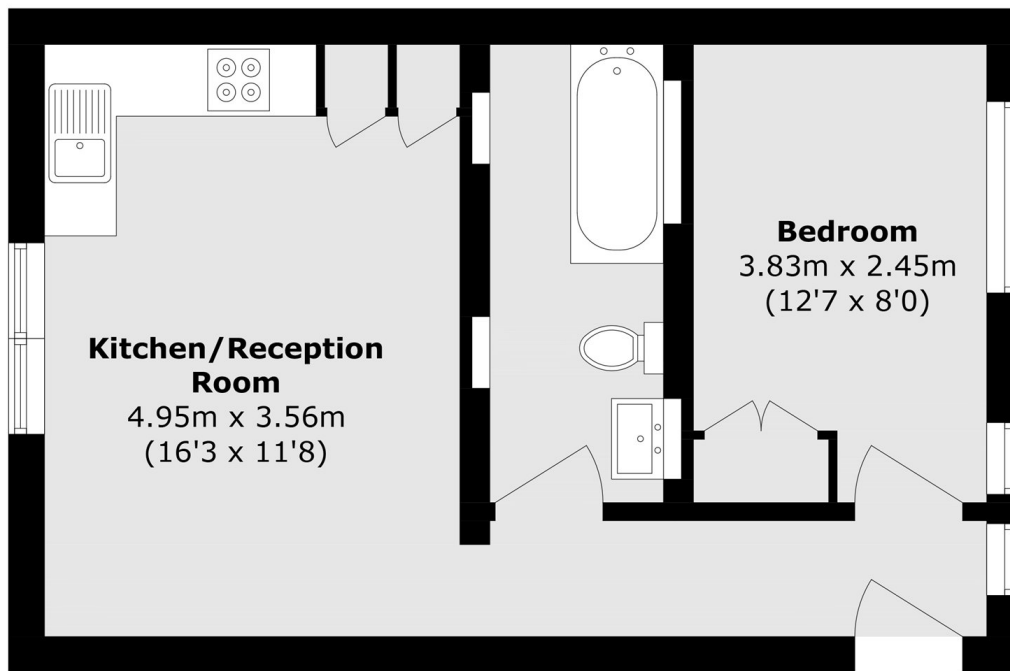

## **Second Floor**

Total area (approx.): 38.9 sq. m (418.7 sq. ft)